

LASER PEGS®

The Ultimate Construction Toy For Kids®

CI400

MINI
BULLDOZER

Ages 5+

30 IN I

Requires 3 AAA Batteries

Batteries NOT
Included



EN71, RoHS COMPLIANT

This product complies to
all safety requirements
of ASTM F 963

MODEL INSTRUCTIONS

All additional model instructions can
be downloaded at www.LaserPegs.com

Please read this manual before you begin!
Failure to follow this manual's instructions may
result in damage to the Power Base and/or
Laser Pegs®. Not adhering to these instructions
will void the manufacturer's warranty. The
packaging must be kept because it contains
important information.

WARNING:
CHOKING HAZARD-Small parts.
Not for children under 3 yrs.
Do not submerge in water.

DO NOT SUBMERGE IN WATER



Each Laser Peg® is color coded on the circuit board inside
each shape.

www.LaserPegs.com

This manual is copyright and cannot be reproduced or used online without Laser
Pegs® Ventures LLC permission. Copyright 2015 © All Rights Reserved US Patent
#8,864,546 Additional Global & Multiple Patents Pending. Laser Pegs® Ventures
LLC. 8304 Consumer Ct., Sarasota FL 34240. Contact: Support@LaserPegs.com

Connecting Pegs

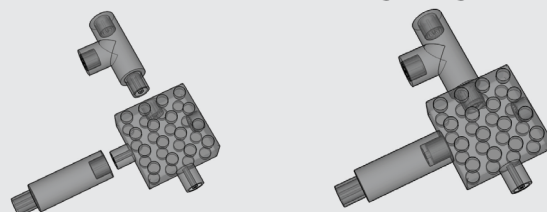

To construct with Laser Pegs®, slide two pieces together to form
a connection. Slide each piece on and off smoothly.

POWER BLOCK

The Power Block is a Power Base that allows you to build with Laser Pegs®
and construction parts to build models that light up. It is battery operated.
(BATTERIES NOT INCLUDED.)

Laser Pegs® Connections

Allows you to construct
with Laser Pegs®.

Construction Part Connections

Allows you to connect to other
construction kits.

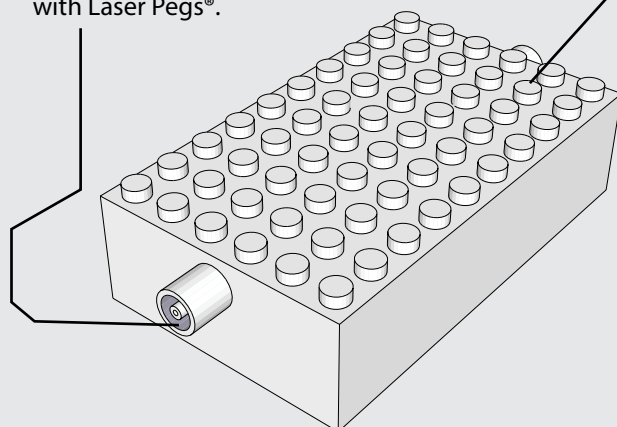

Power Switch

Move the Power Switch to
cycle through the Power
Block light settings.
OFF/ON/FLASH

Battery Compartment

Requires 3-AAA Batteries
(Batteries Not Included)

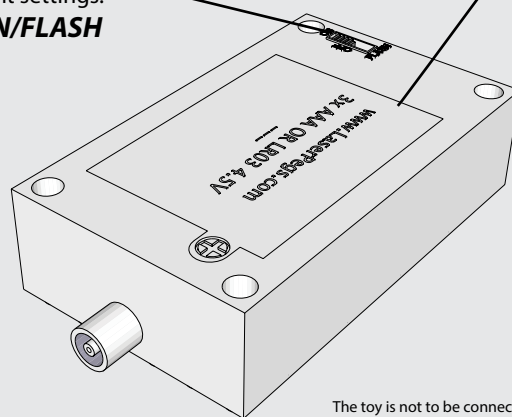

The toy is not to be connected to more than
the recommended number of power supplies

LIGHT SETTINGS

OFF - Turns lights OFF
ON - Turns lights ON
FLASH - Makes lights FLASH

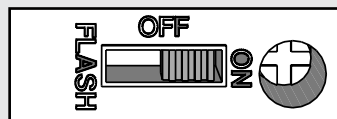

**WARNING: STROBE LIGHTS
MAY CAUSE SEIZURES**

WARNING! Each Laser Peg® draws current from the batteries. Therefore, the more
pegs you use, the quicker you will deplete your battery power! As the power
weakens, the current will slowly fail and some Laser Pegs® will illuminate (typically
the reds and yellows) and some won't. When the Laser Pegs® dim, the Laser Pegs®
are not broken, they just need stronger batteries.
You have 2 simple options...
1. Change the batteries.
2. Use high quality batteries. They will last a little longer, but they will still deplete
rapidly the more Laser Pegs® you connect!

Replacing Batteries

1. Remove Screw.
2. Lift off Battery Compartment Cover.
3. Place three (3) AAA batteries in the correct
position - as displayed inside of the
Power Block.
4. Replace Battery Compartment Cover and
Screw.
5. Slide Power Switch setting to
OFF/ON/FLASH.
6. Do not mix old and new batteries.
7. Do not mix alkaline, standard (carbon-
zinc), or rechargeable (nickel-cadmium,
NiMH) batteries!
8. Exhausted batteries are to be removed
from the power base.
9. Never connect more than 30 Laser Pegs® at
one time!
10. Non-rechargeable batteries are not to be
recharged.
11. Rechargeable batteries are only to be
recharged under adult supervision.
12. Rechargeable batteries are to be removed
from the toy before being recharged.
13. Batteries are to be inserted with the
correct polarity.
14. The supply terminals are not to be short-
circuited.
15. DO NOT THROW BATTERIES INTO FIRE!

Remove the Phillips head screw
with a 4mm screw driver.

Requires 3-AAA Batteries
Batteries NOT
Included

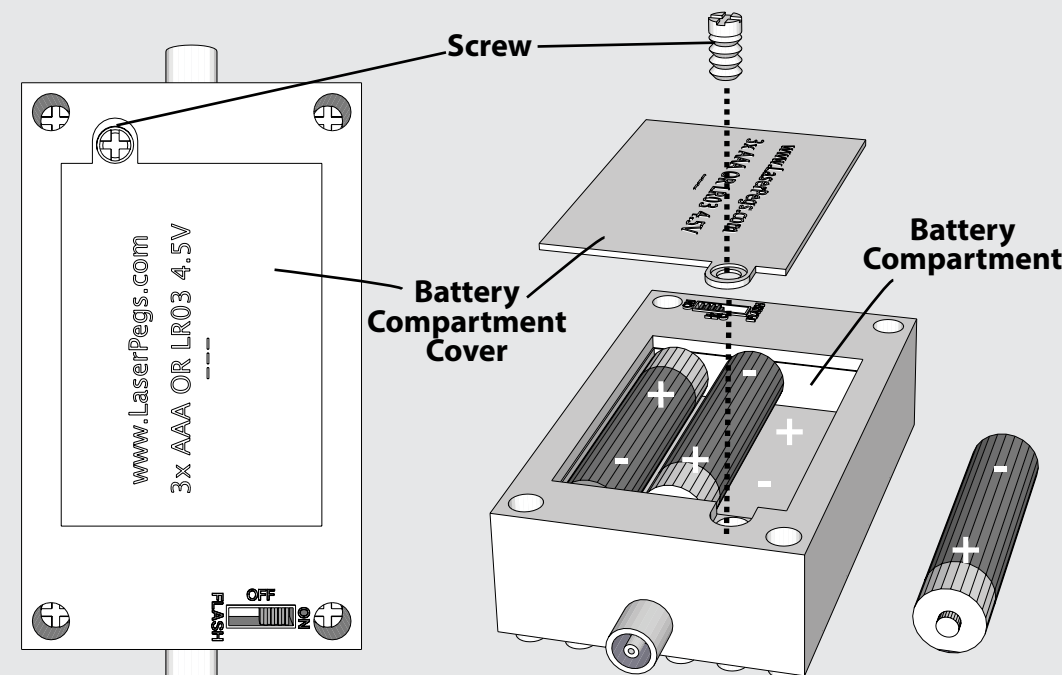

Requires 3-AAA Batteries

Connecting the Laser Pegs® Tire to the Axle Peg

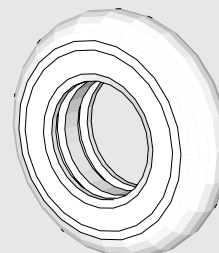

Tire

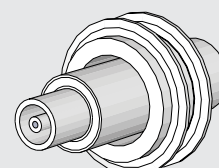

Axle Peg

Place Axle Peg
through the Tire

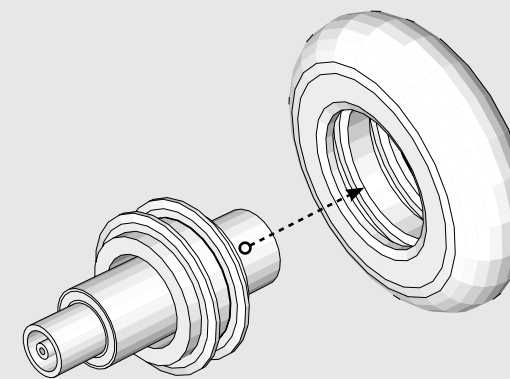

Tire Peg

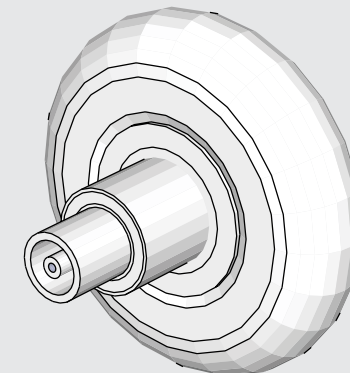

POWER BLOCK™

Use the Laser Pegs® Square M-M Peg to attach
the Tire Pegs to the Power Block™.

Laser Pegs® Square M-M Peg

Tire Peg

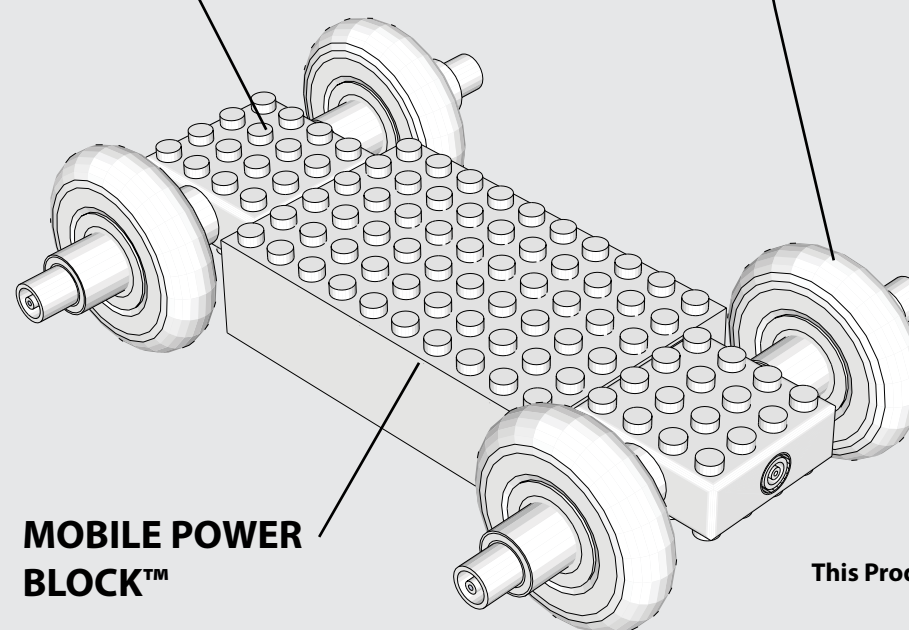

MOBILE POWER BLOCK™

AVOID DAMAGE TO PEG HOLES

*To avoid short-circuits, keep metal objects and
other unauthorized materials from obstructing
the peg holes.

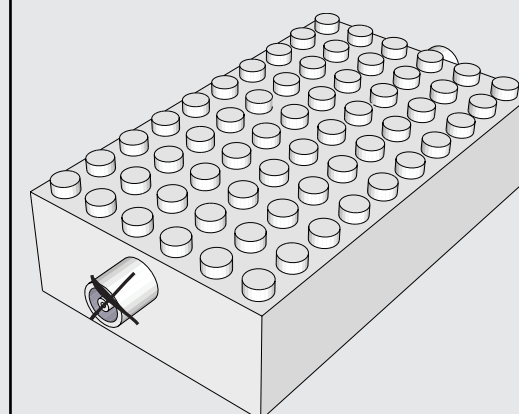

Never connect more than 30 Laser Pegs®
to the Power Block at one time.

**This Product contains a button battery. If swallowed, it could
cause severe injury or death in just 2 hours.
Seek medical attention immediately.**



MINI BULLDOZER

Model
Difficulty
Level

4

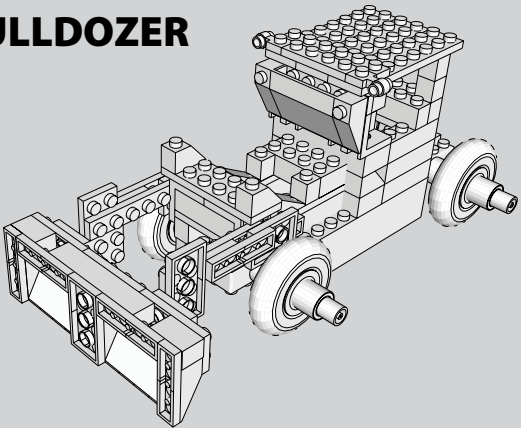

The TRY-ME mechanism is for display purposes ONLY and should be discarded as per state and local regulations. It is NOT intended to be used for the building of this model.

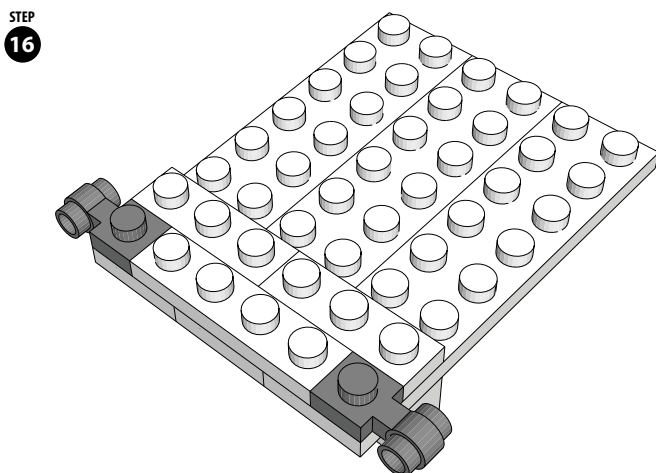
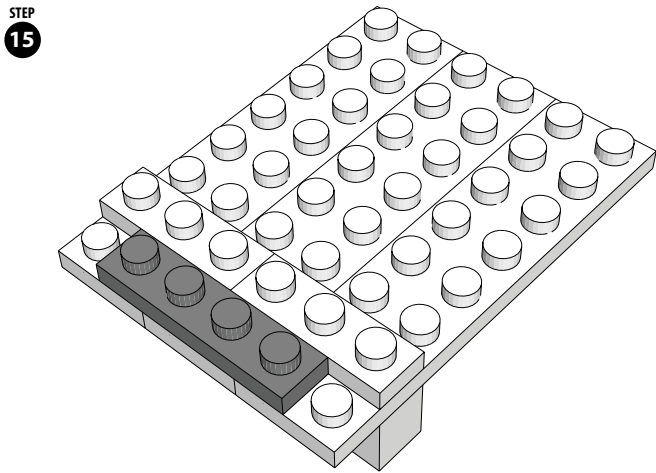
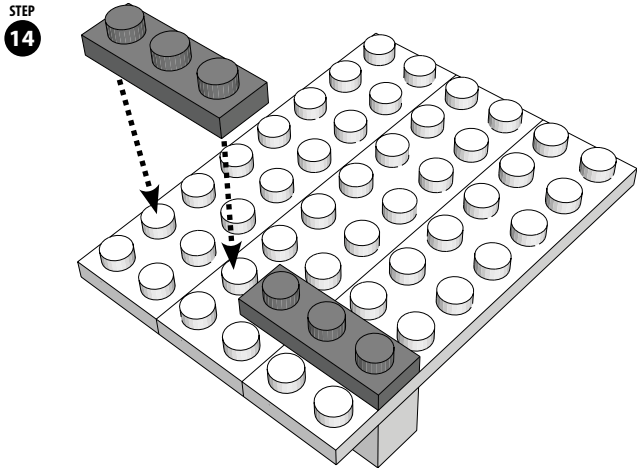
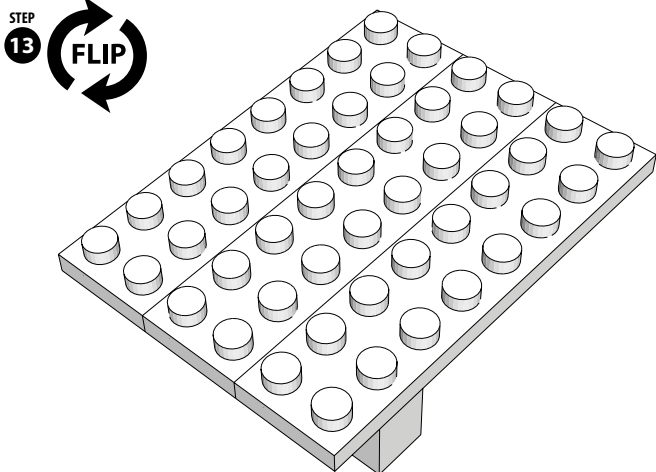
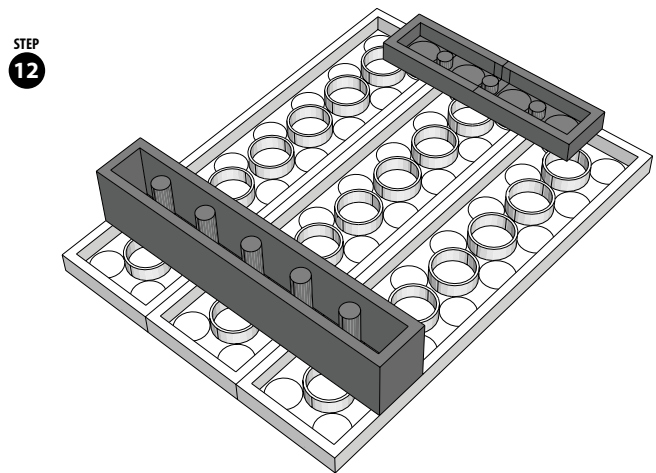
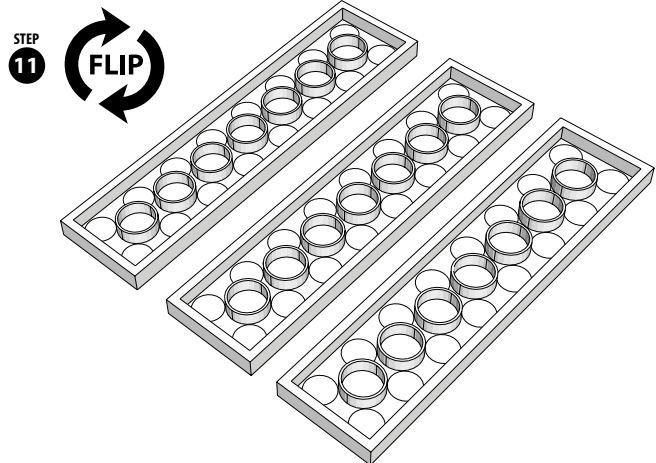
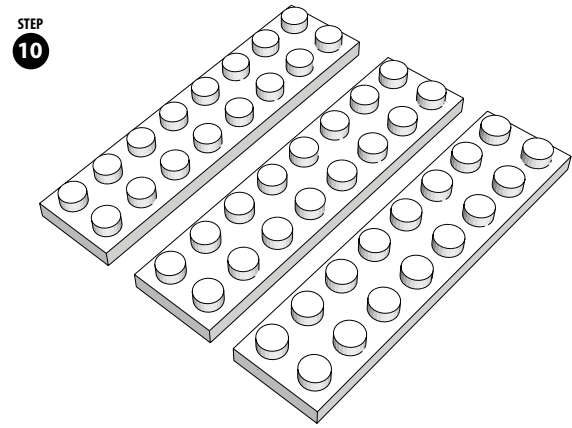
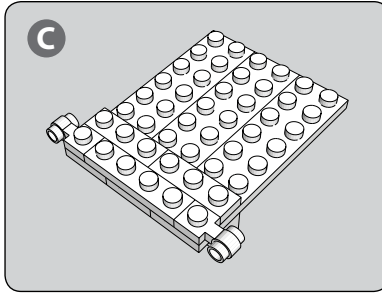
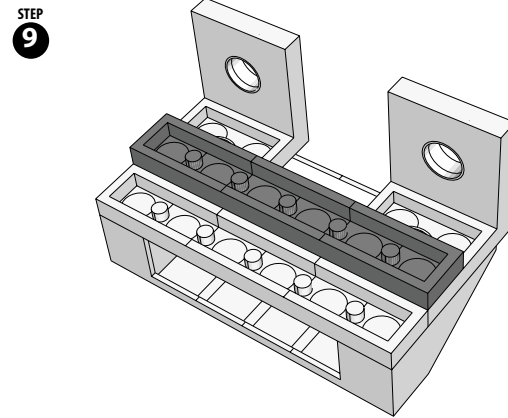
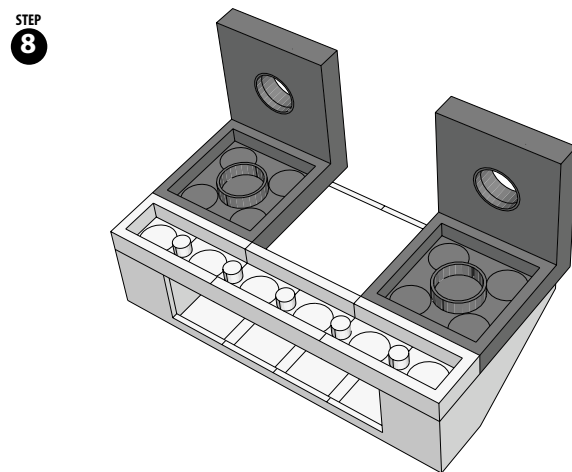
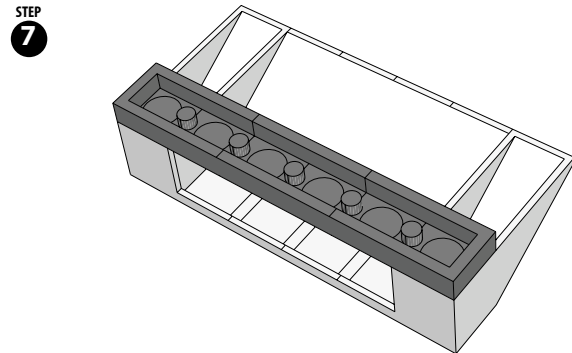
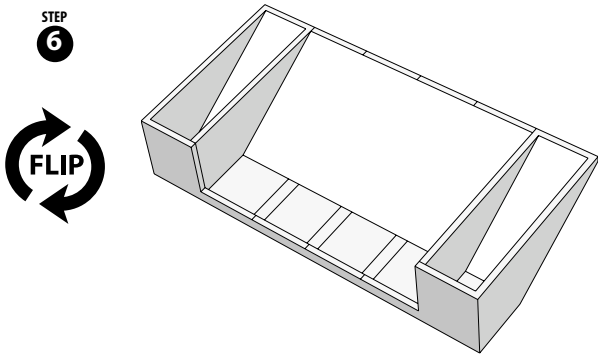
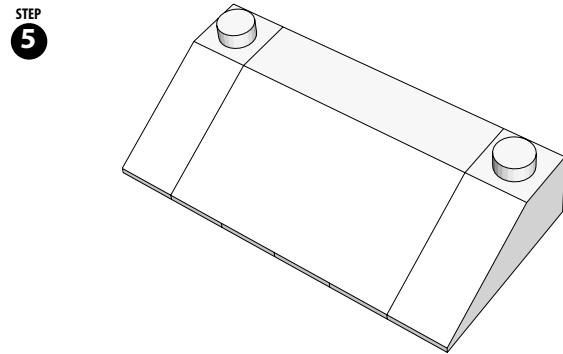
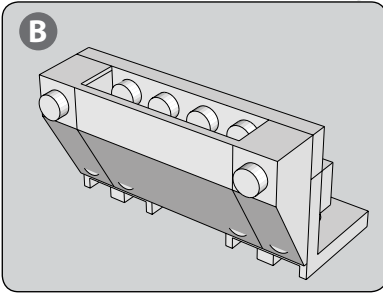
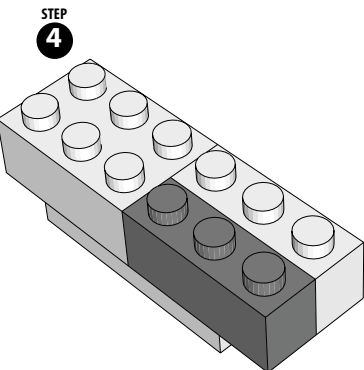
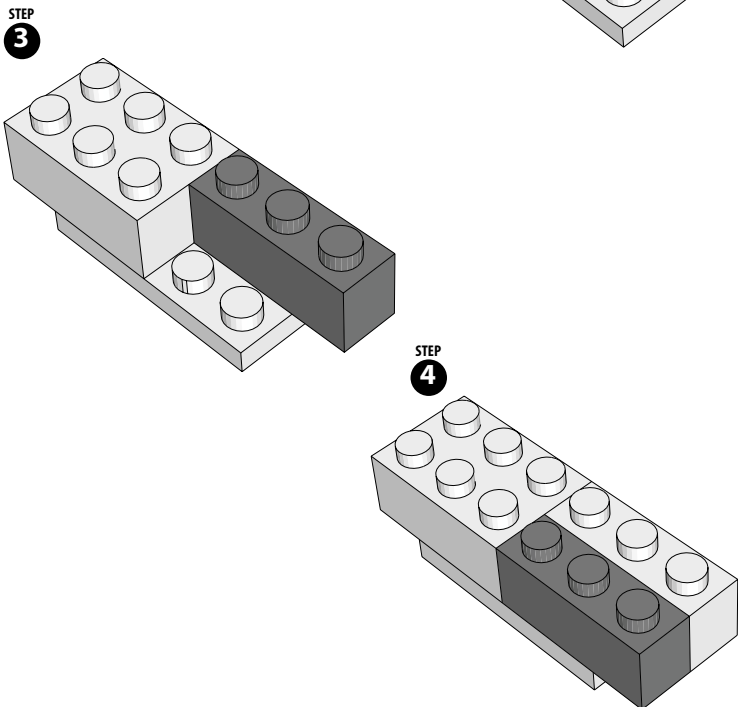
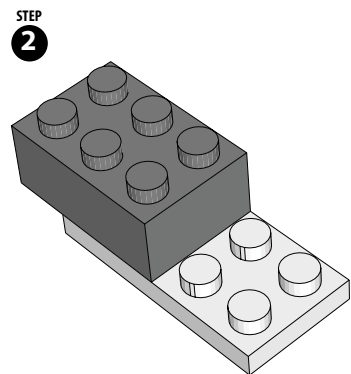
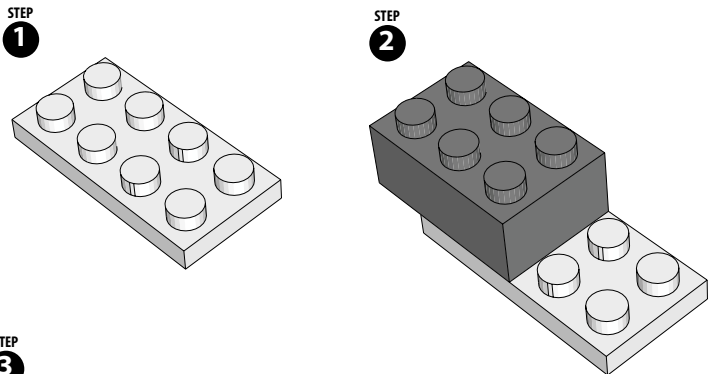
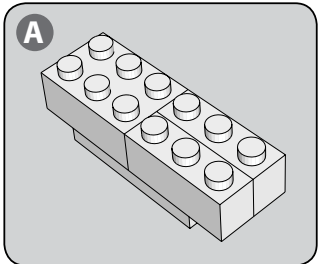

Environmental Phenomena

* The unit may malfunction if subjected to radio-frequency interference. It SHOULD revert to normal operation when the interference stops. If not, it may become necessary to turn the power off and back on, or remove and reinstall the batteries. * In the unlikely event of an electrostatic discharge, the unit may malfunction and lose memory, requiring the user to reset the devise by removing and reinstalling the batteries.

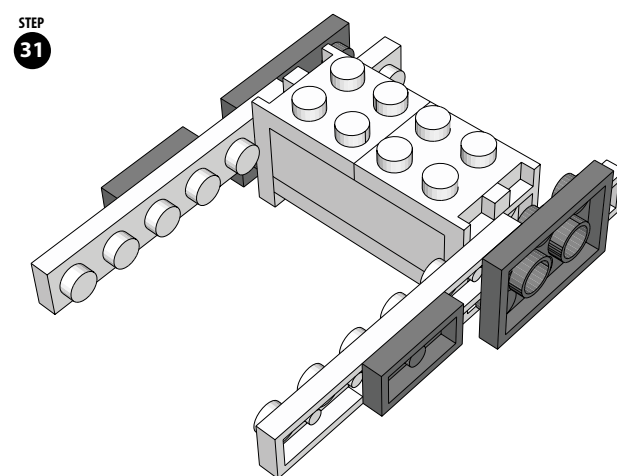
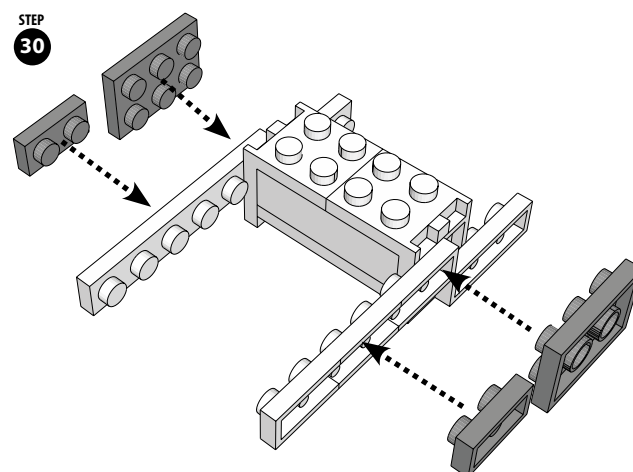
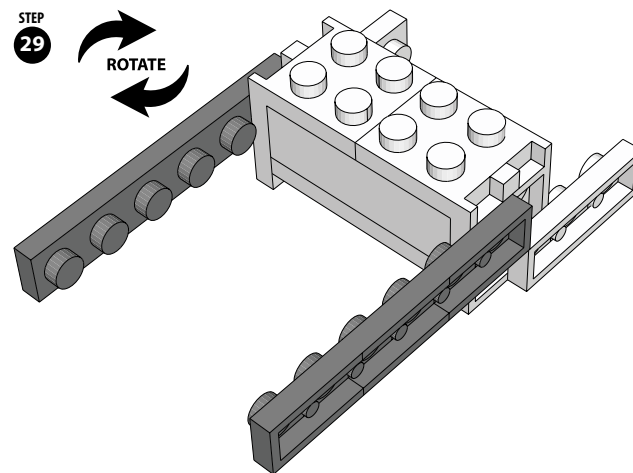
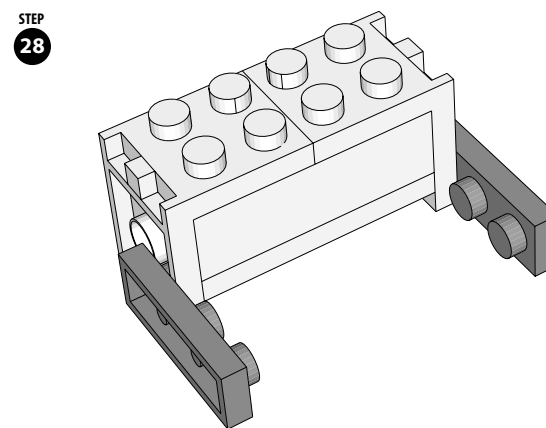
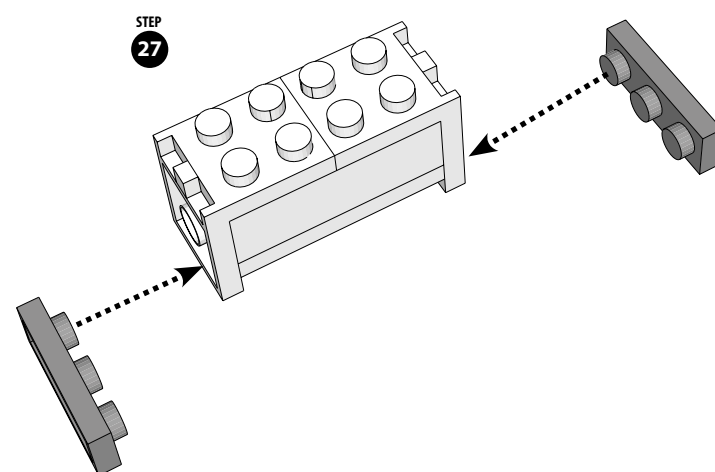
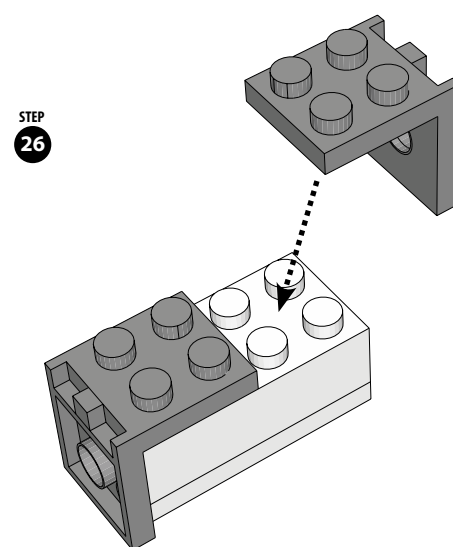
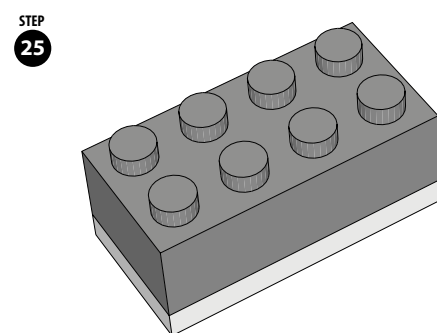
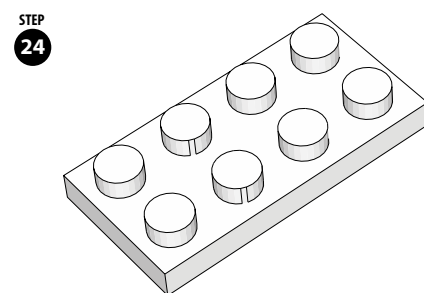
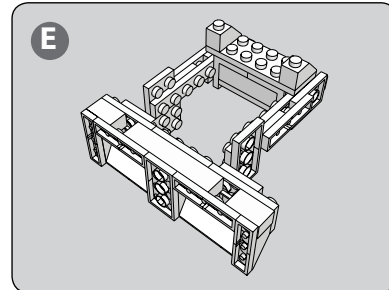
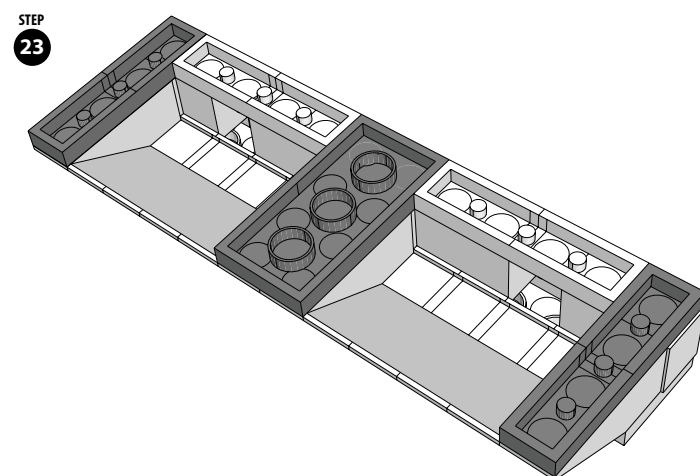
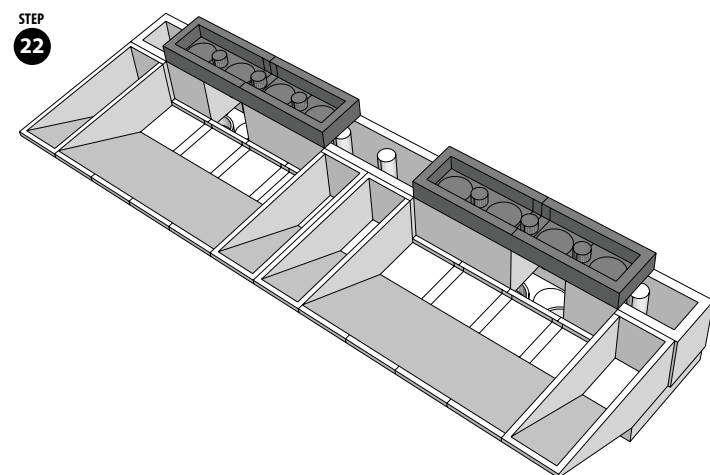
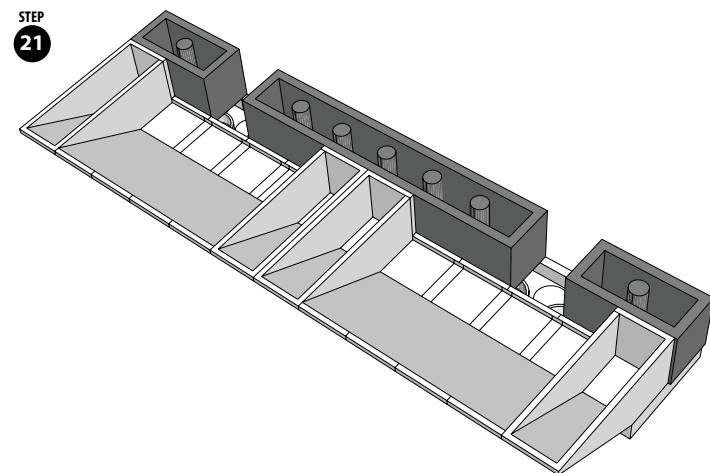
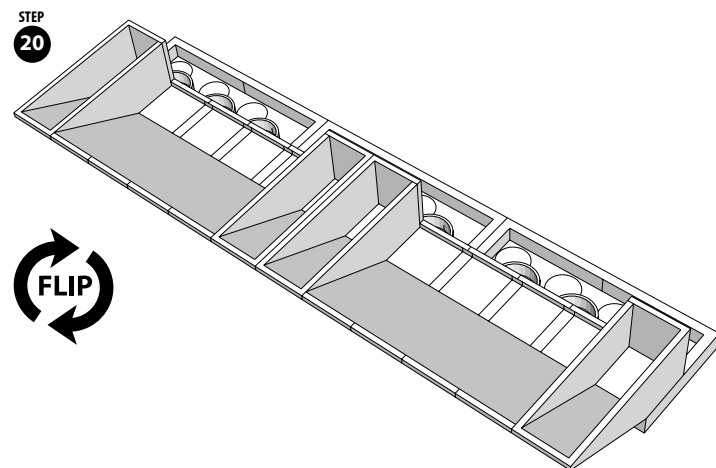
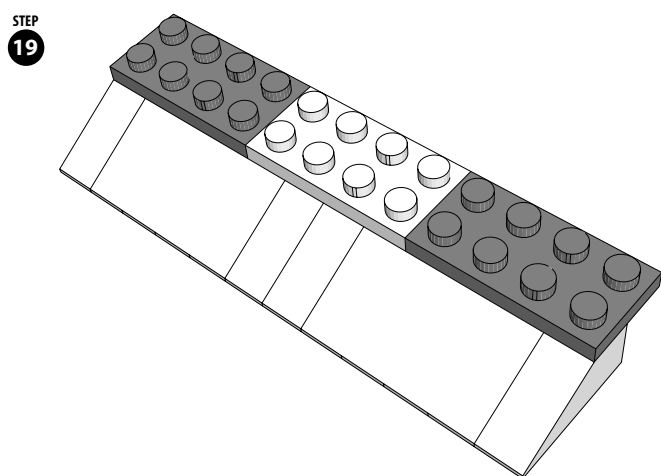
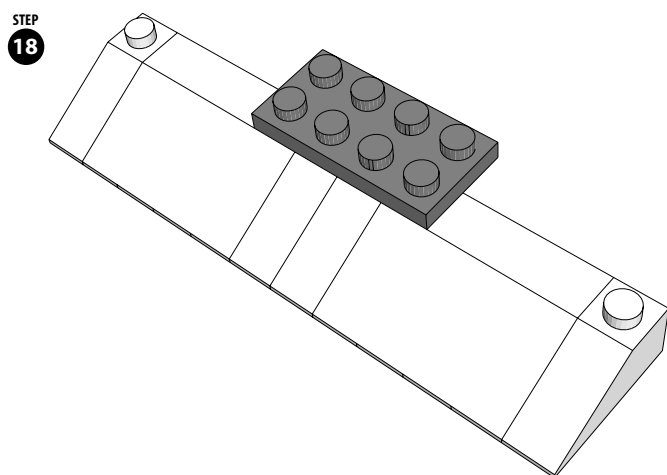
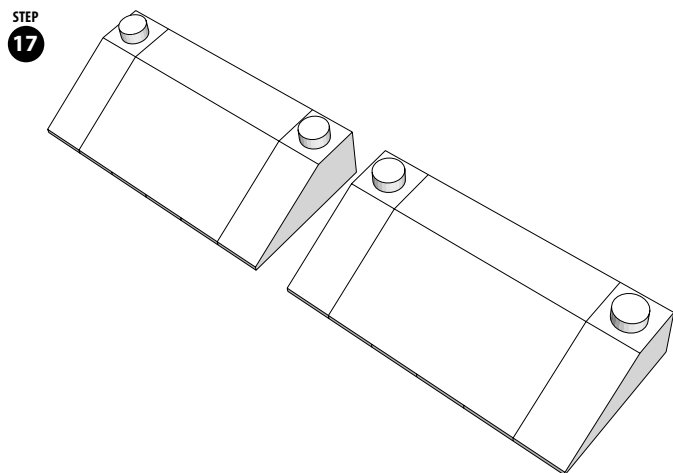
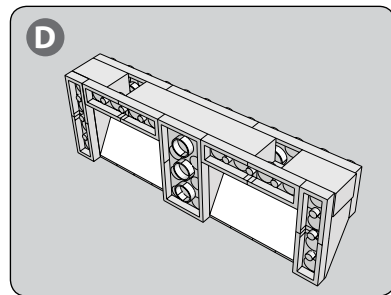

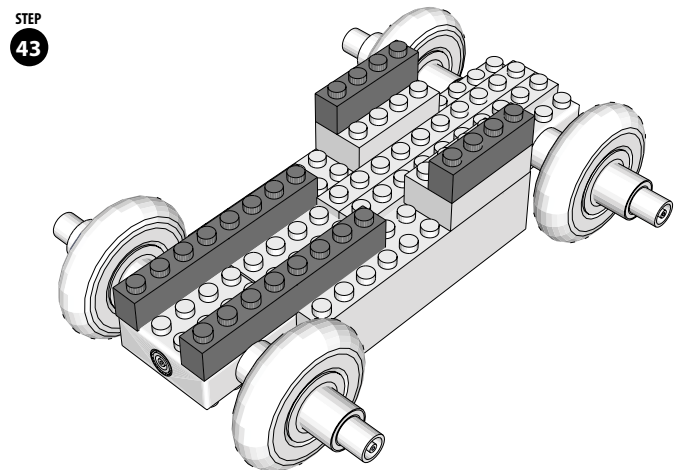
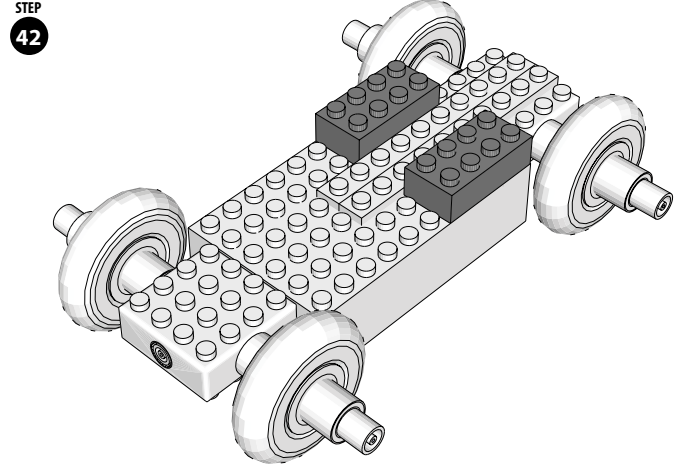
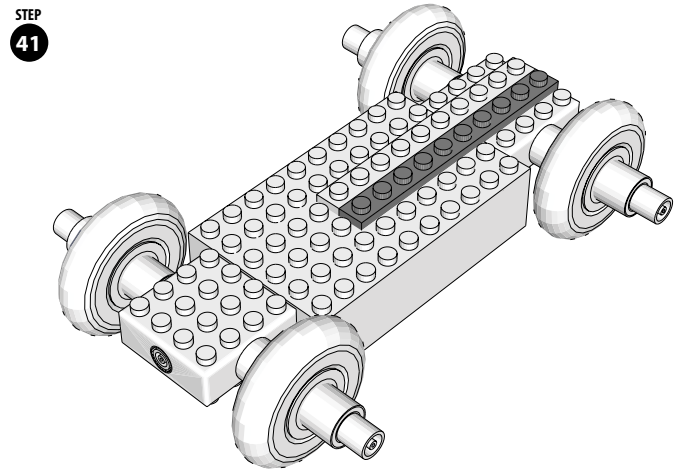
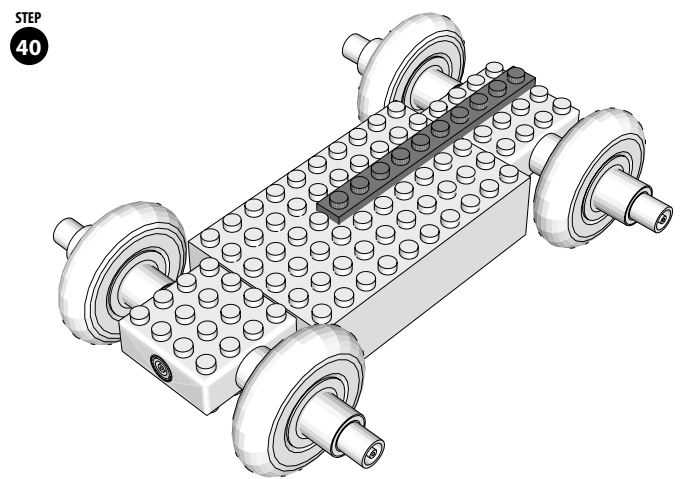
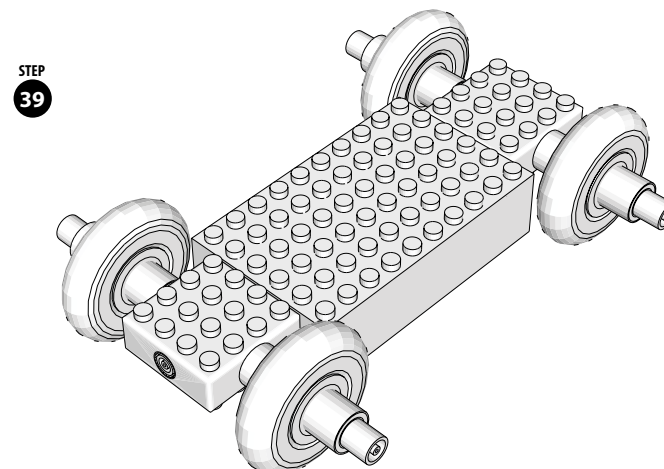
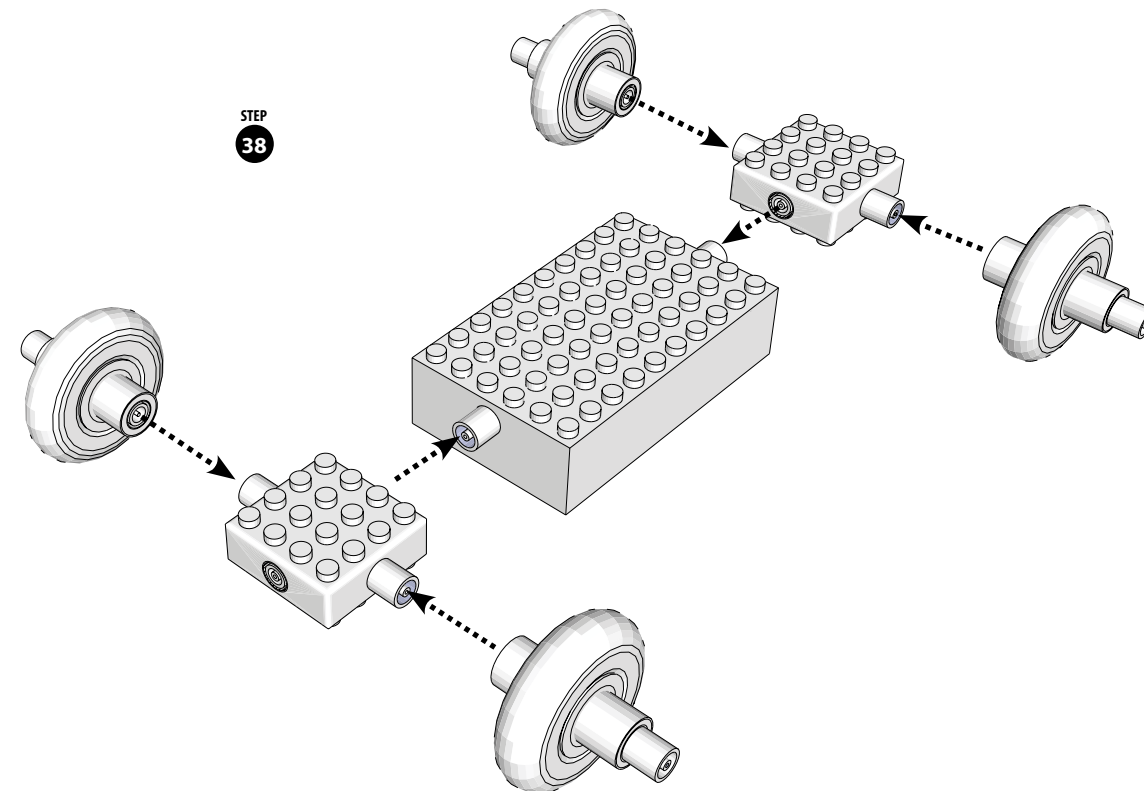
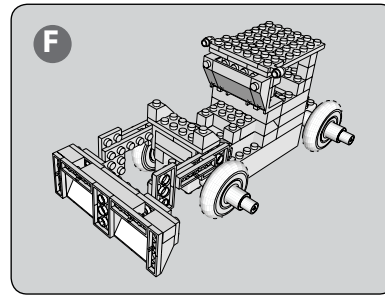
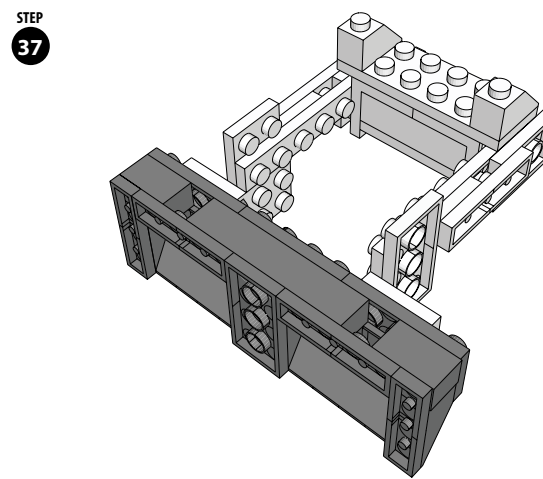
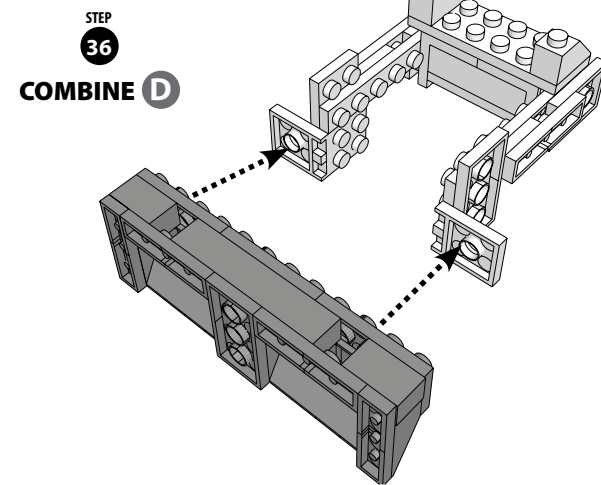
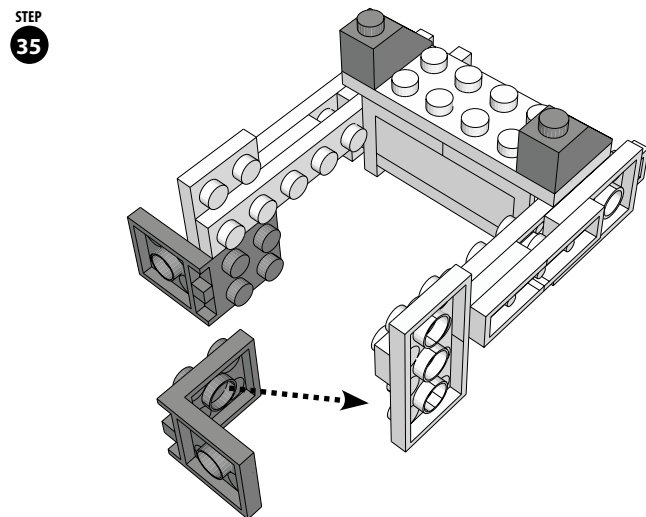
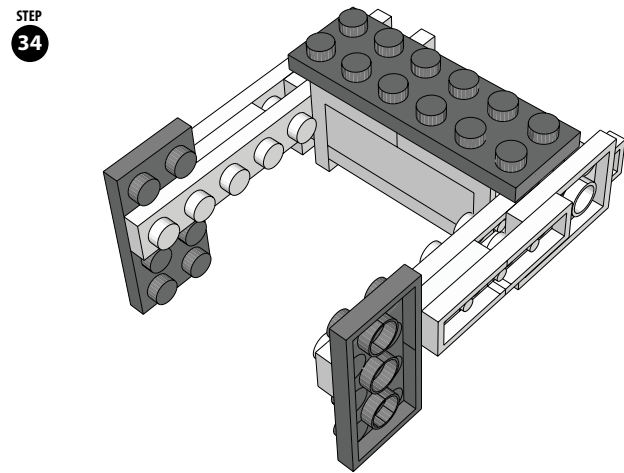
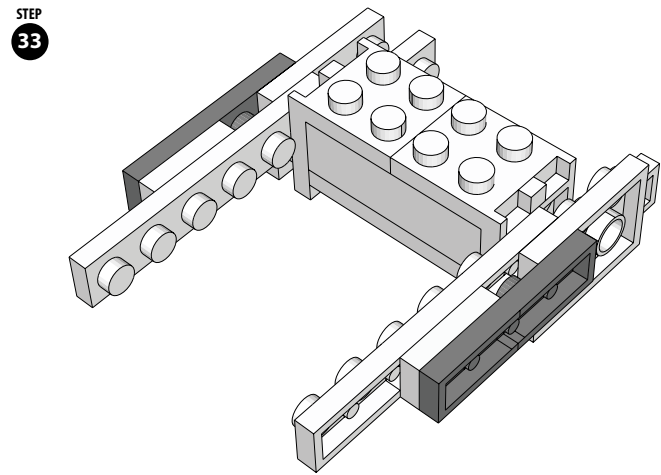
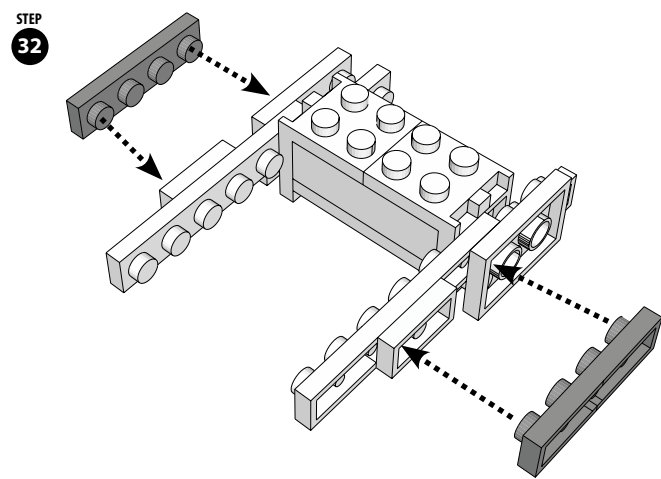

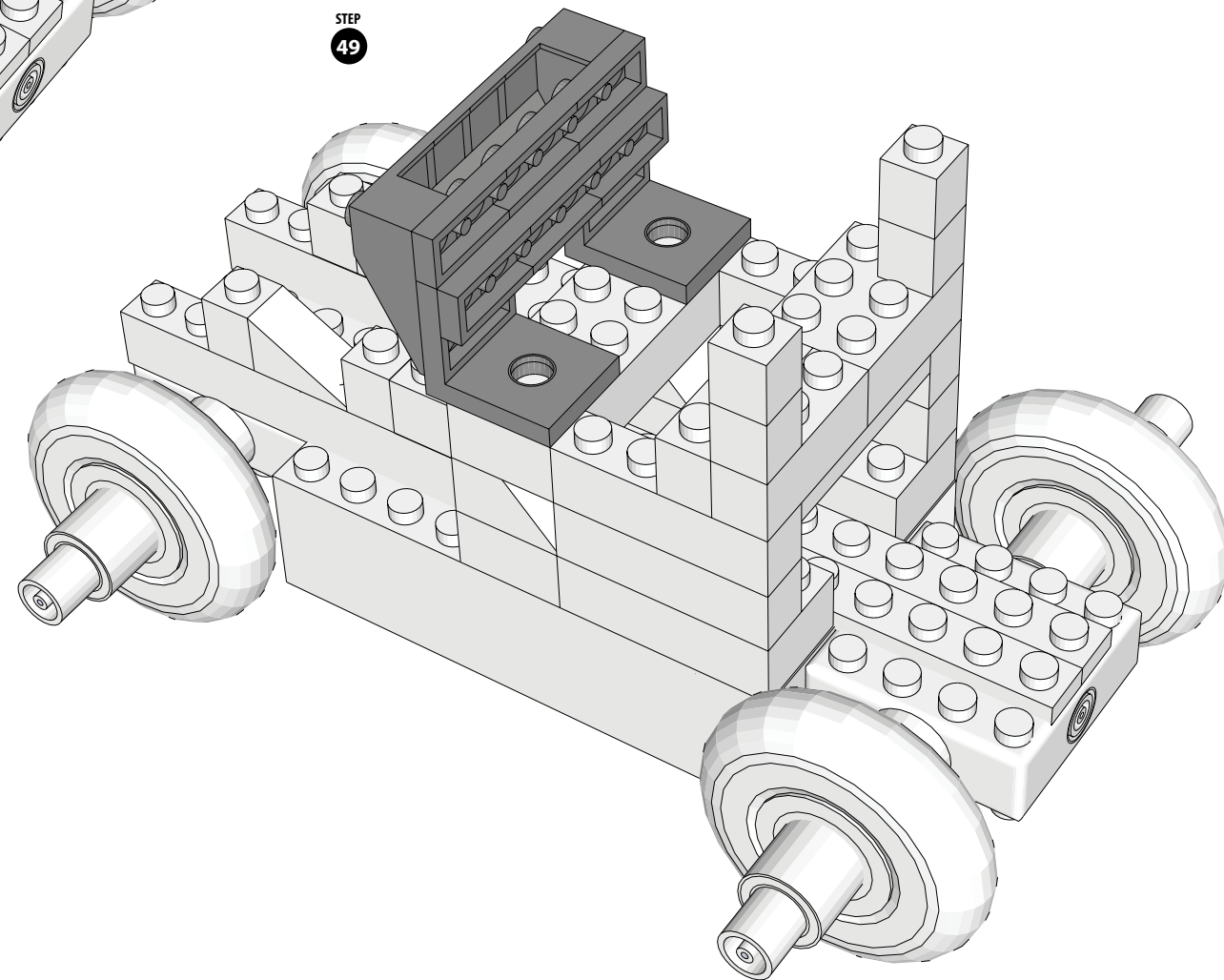
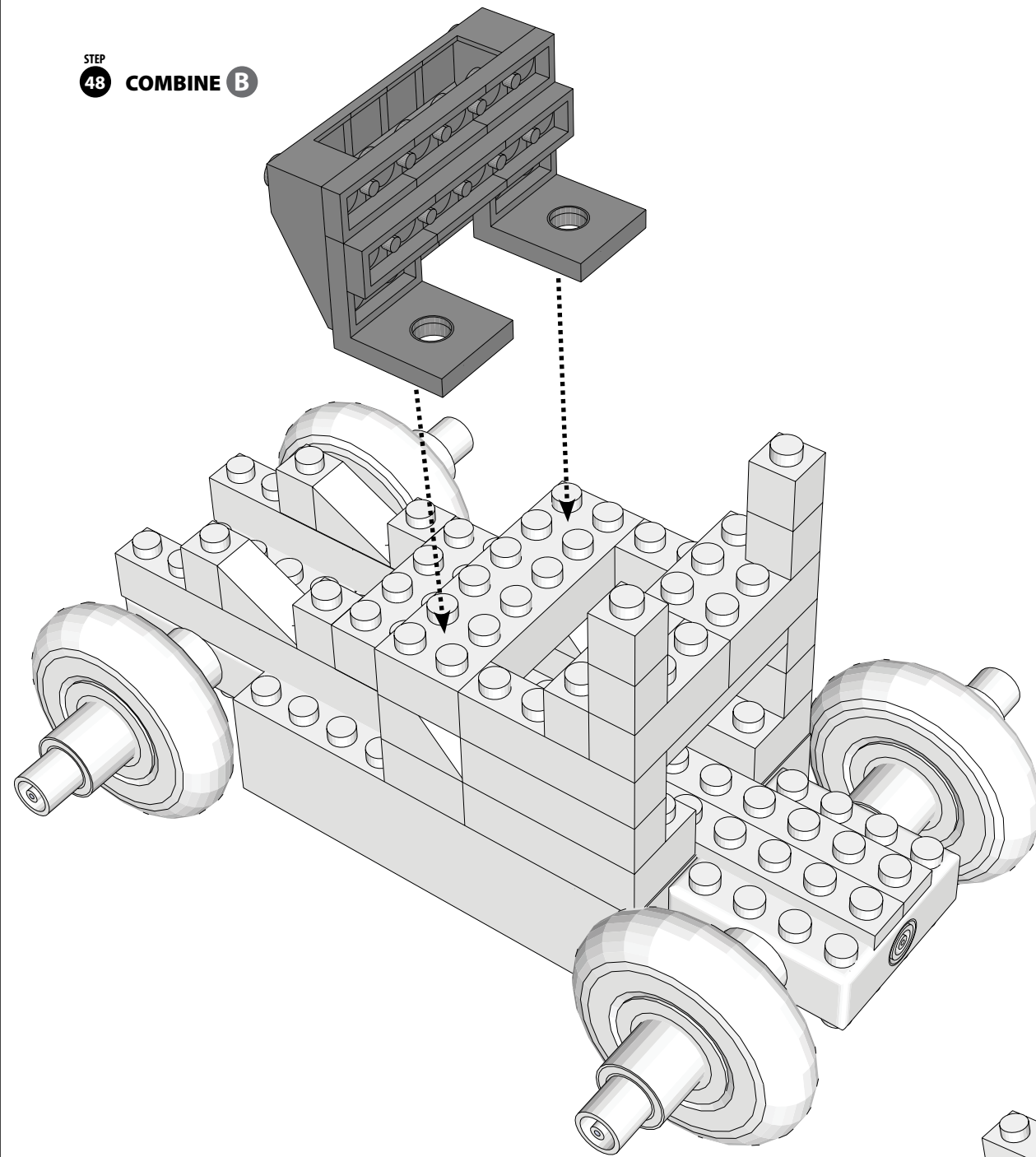
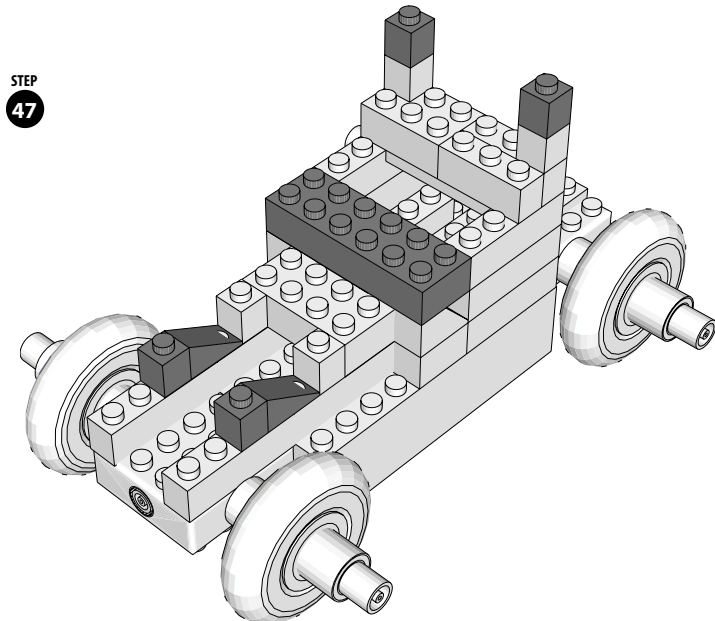
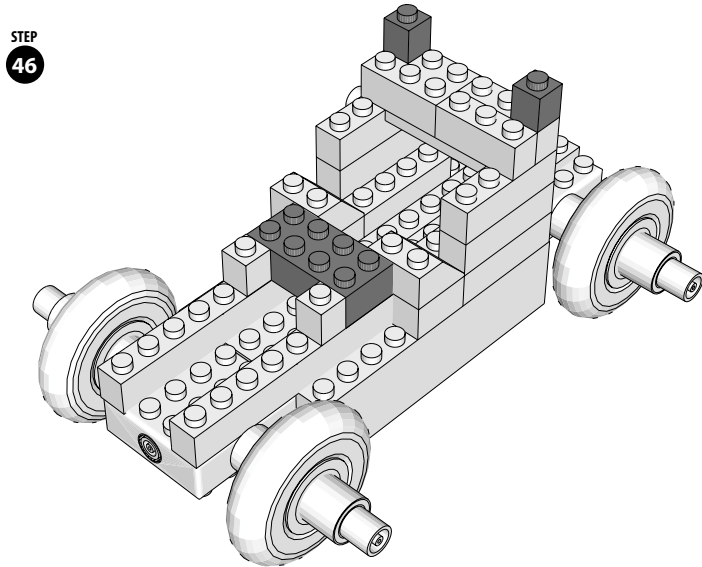
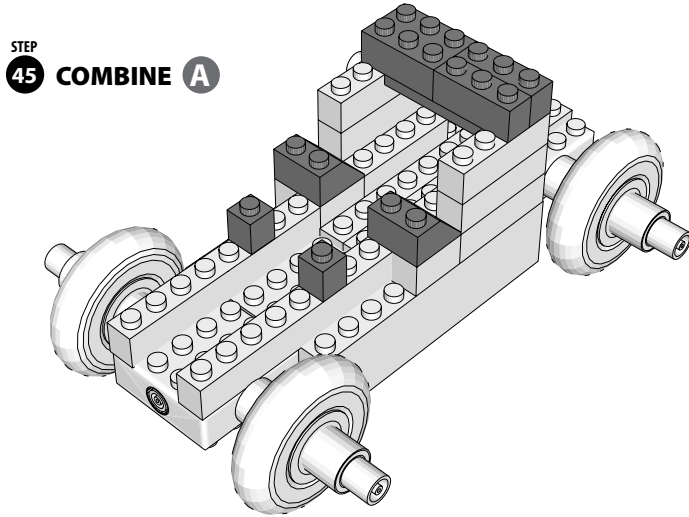
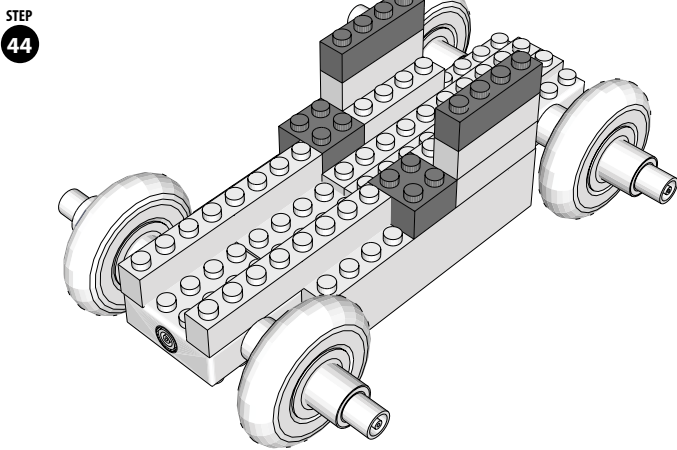

STEP
50 COMBINE C

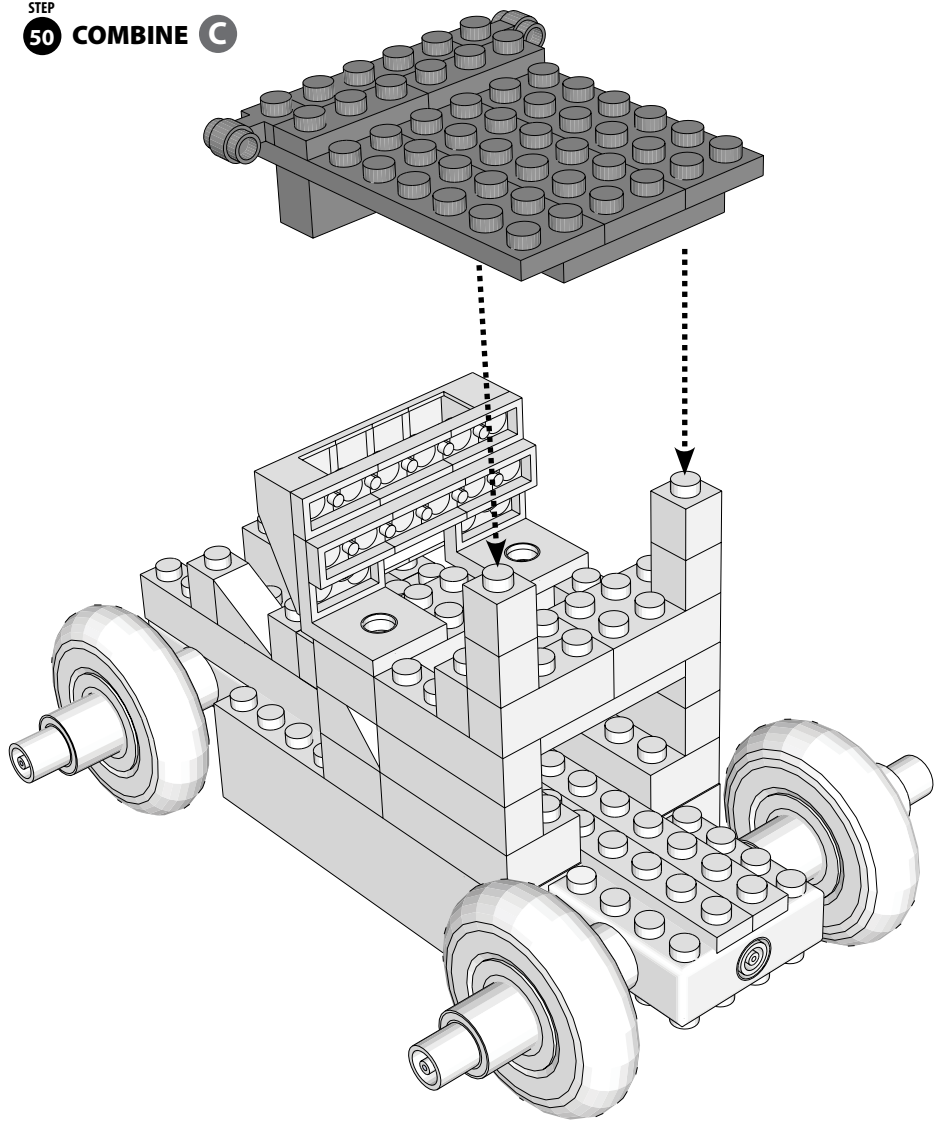

STEP
51

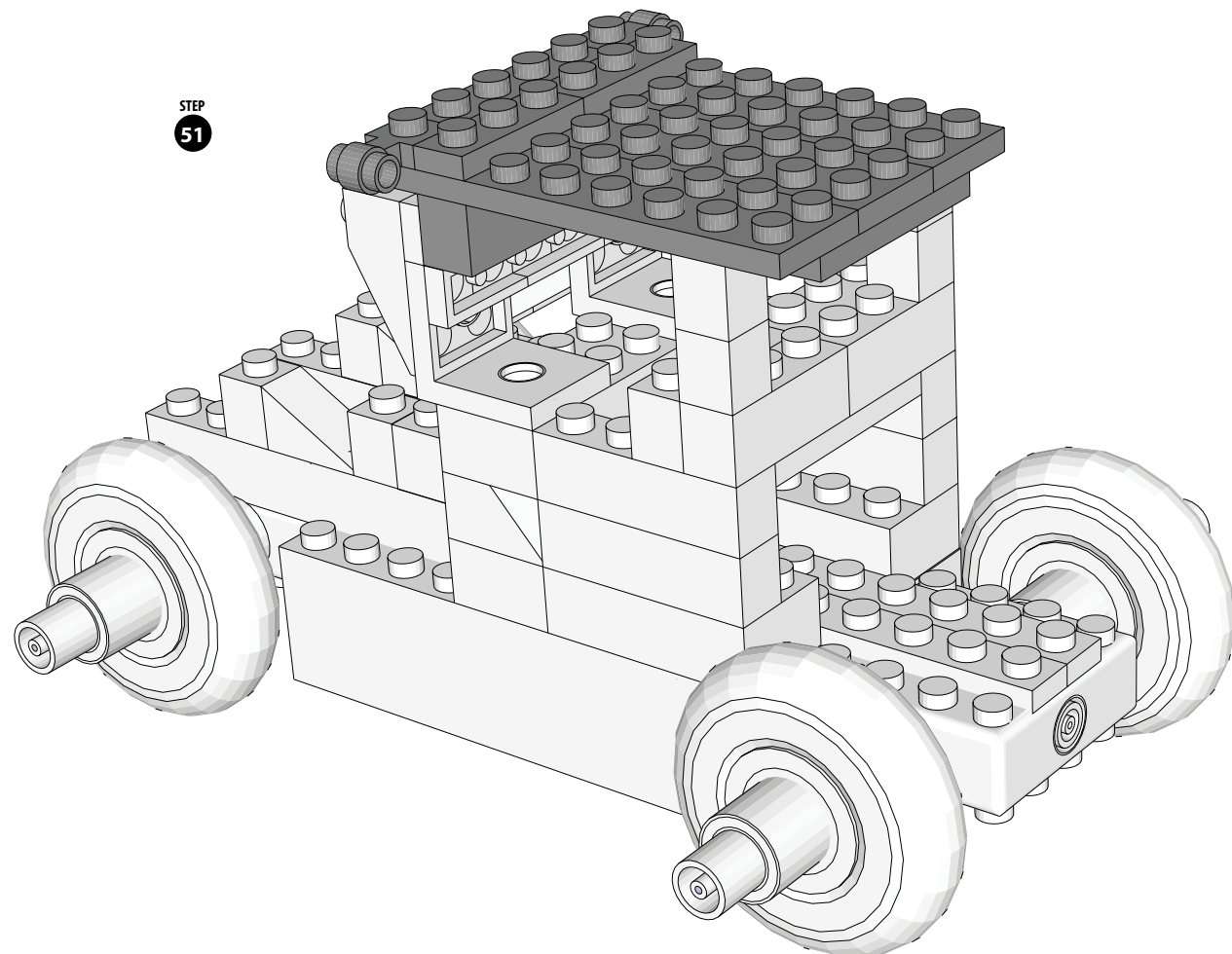

STEP
52 COMBINE E

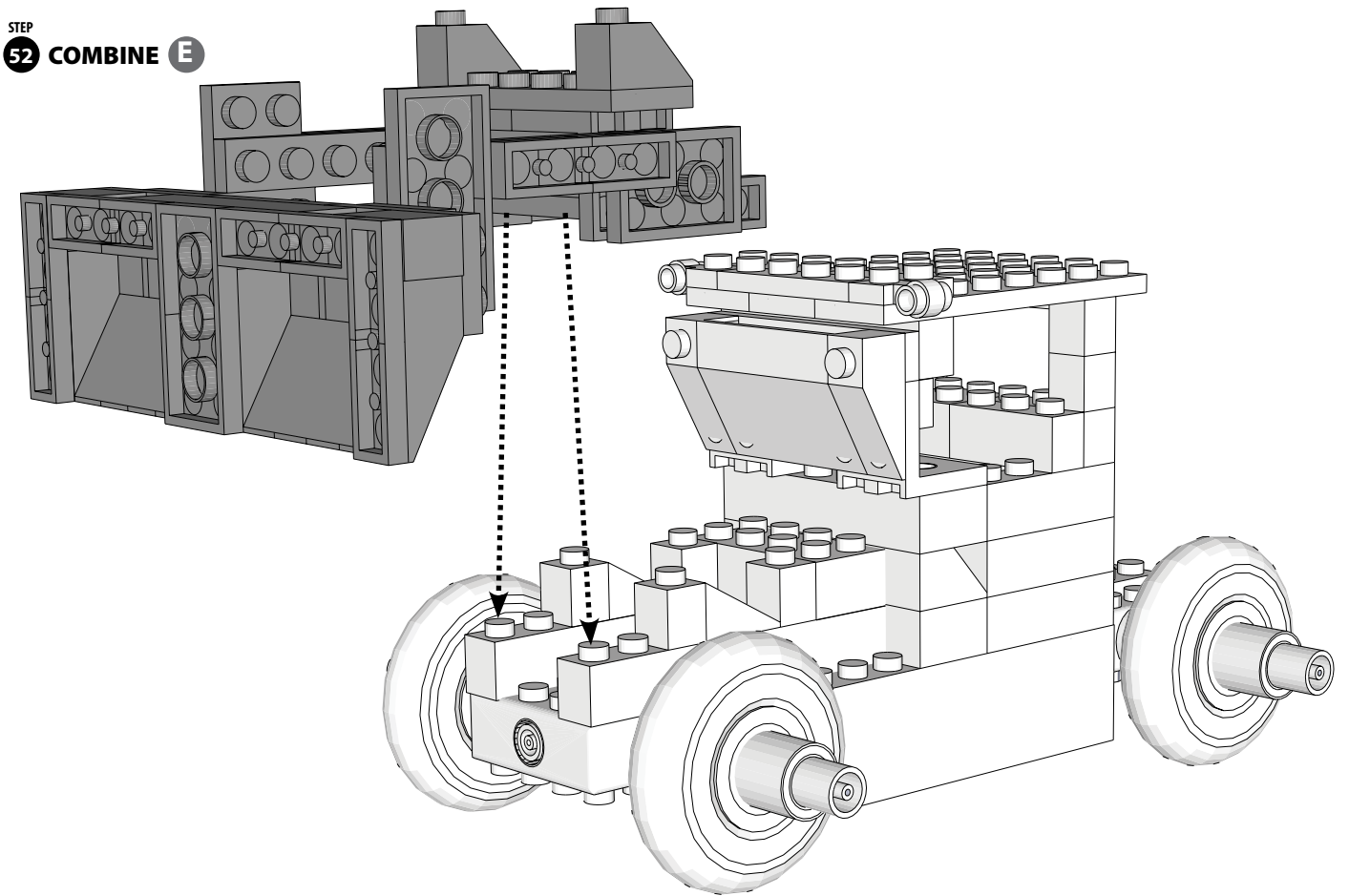

STEP
53

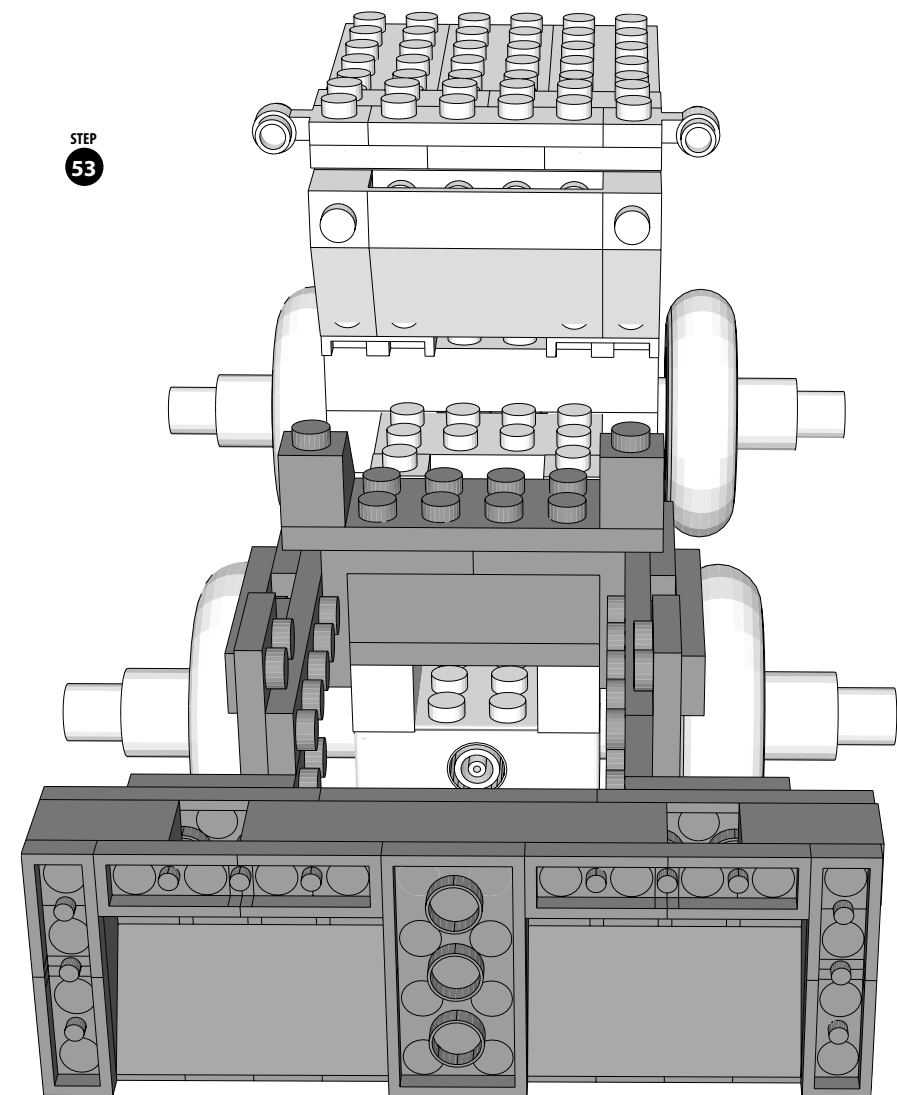

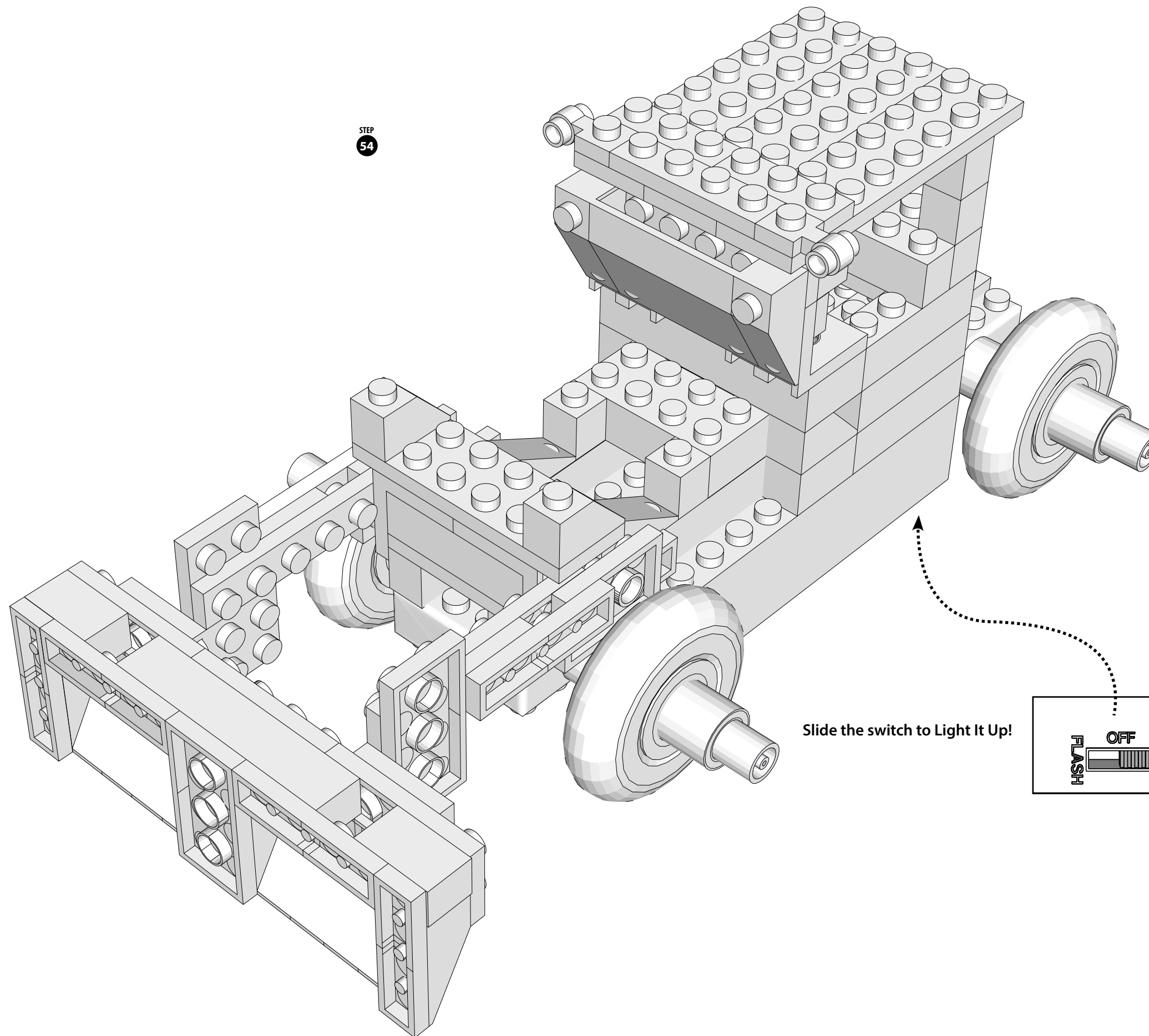

STEP
54

Slide the switch to Light It Up!

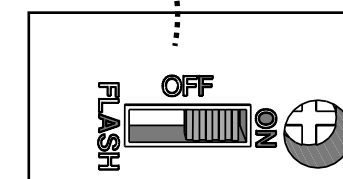

OFF - Turns lights OFF
ON - Turns lights ON
FLASH - Makes lights FLASH