

# LASER PEGS®

The Ultimate Construction Toy For Kids®

**G9030B**

**SPACE  
FIGHTER  
AGES 5+**

**16 Models+**  
Any creation you can build

**LIGHTED**  
CONSTRUCTION SET INCLUDES:

- 20 Laser Pegs®
  - 82 Construction Parts
  - Triangle Power Base
  - Instruction Manual
- Requires 3 AA Batteries

Batteries NOT  
Included

EN71, RoHS COMPLIANT



This product complies to  
all safety requirements  
of ASTM F 963

**WARNING:**  
**CHOKING HAZARD**—Small parts.  
Not for children under 3 yrs.  
Do not submerge in water.

## MODEL INSTRUCTIONS

All additional model instructions can  
be downloaded at [www.LaserPegs.com](http://www.LaserPegs.com)

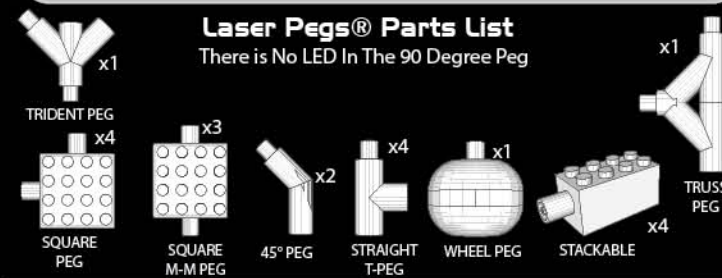

**Color Code** Each Laser Peg® is color coded on the circuit board inside each shape. There is No LED In The 90 Degree Peg.

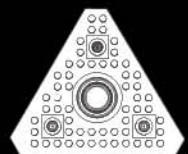

Sound Activated  
Triangle Power Base



Laser Pegs®  
Peg Cord

### Construction Parts List

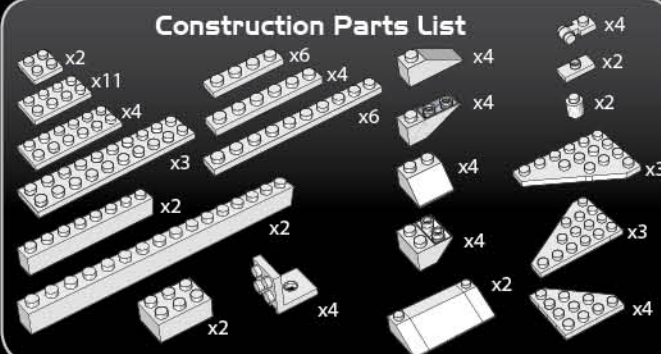



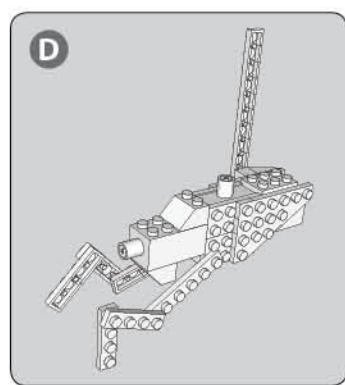

STEP 8

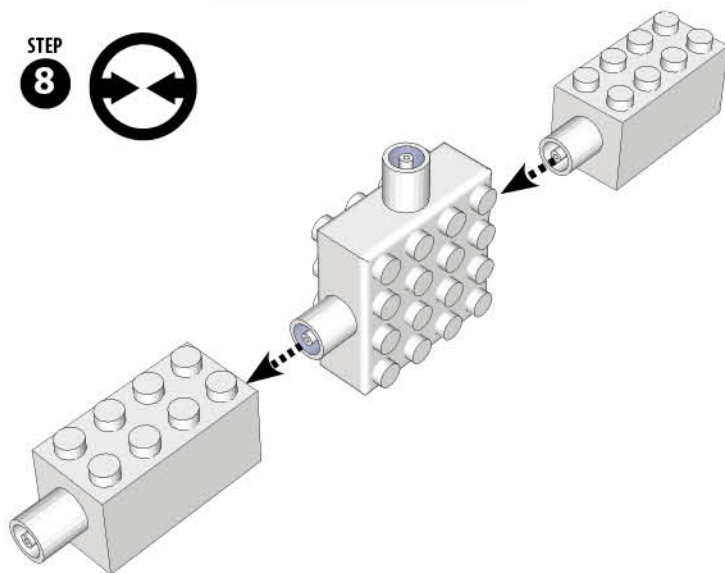

STEP 9

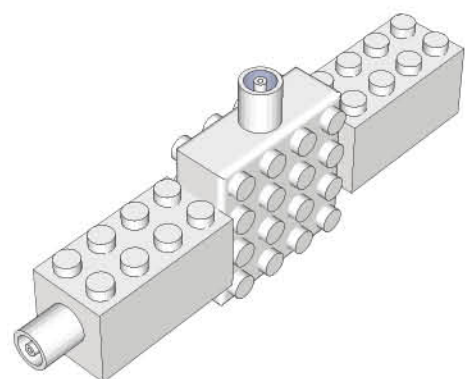

STEP 10



B

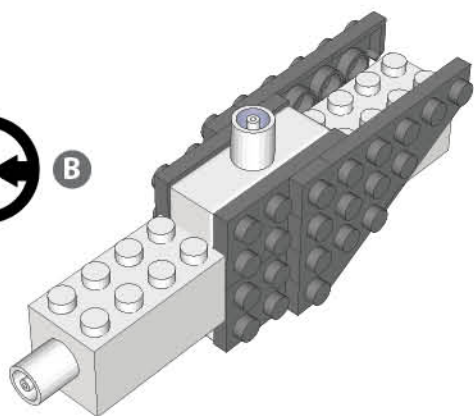

STEP 11

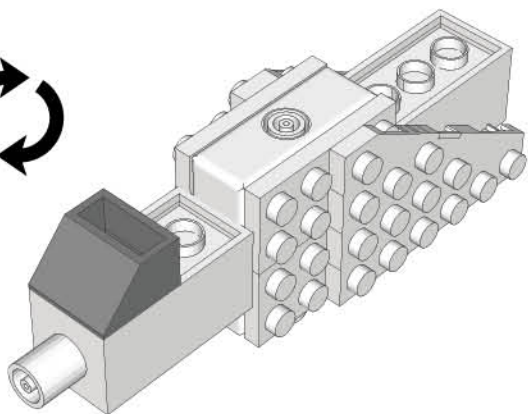

STEP 12

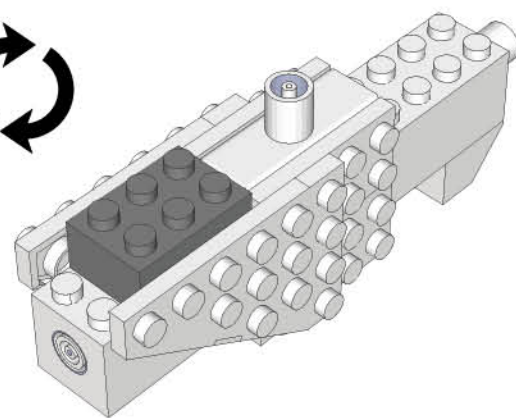
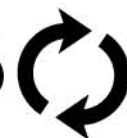

STEP 13

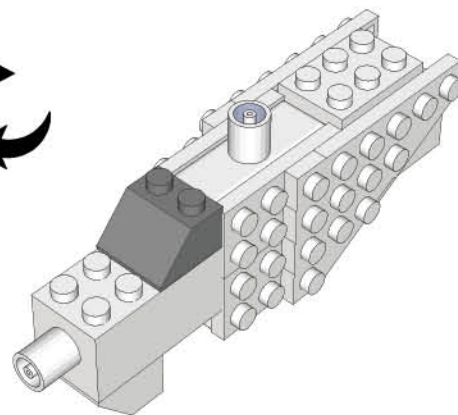
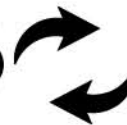

STEP 14

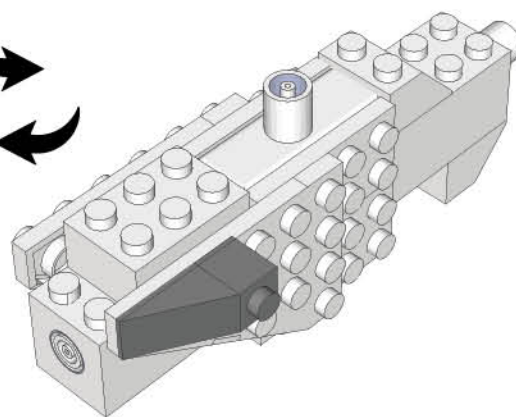

STEP 15

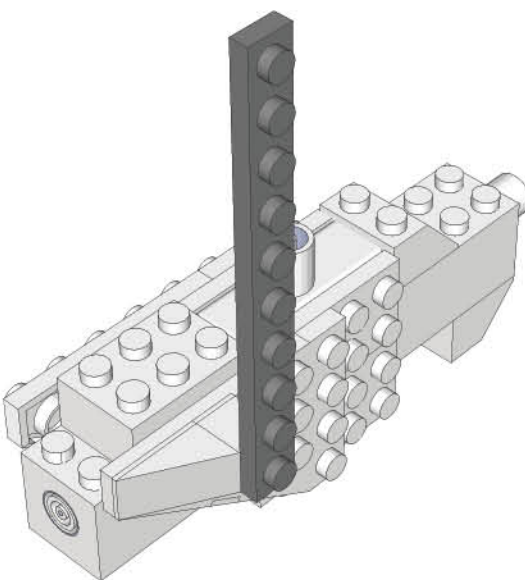

STEP 16

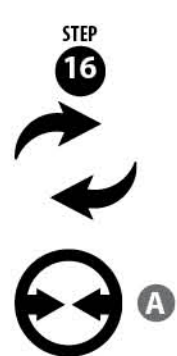

A

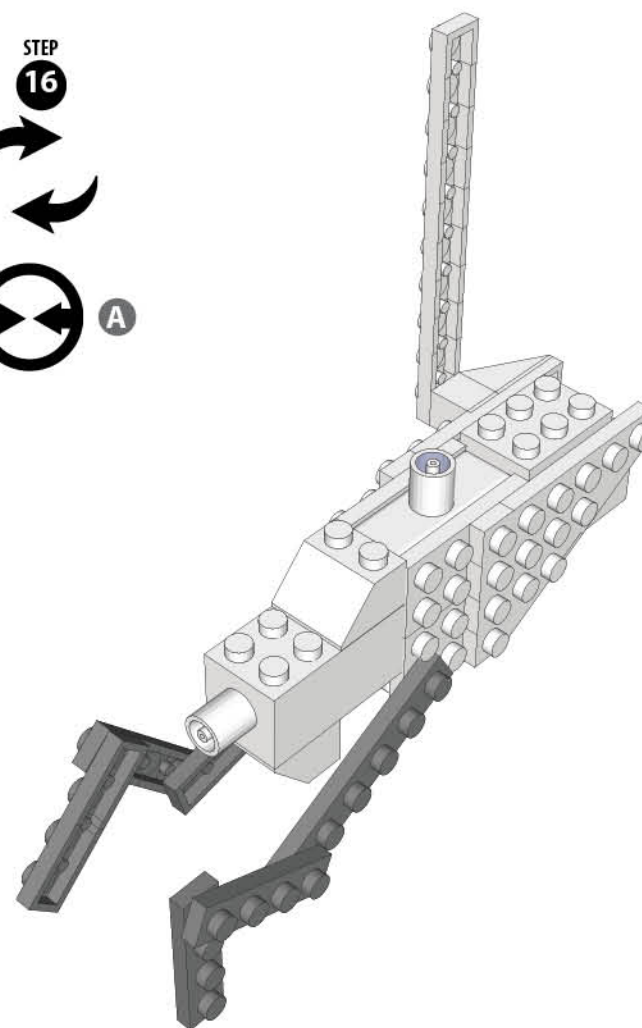

E

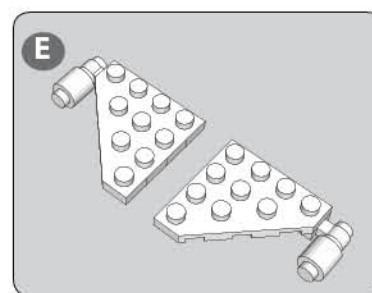

STEP 17

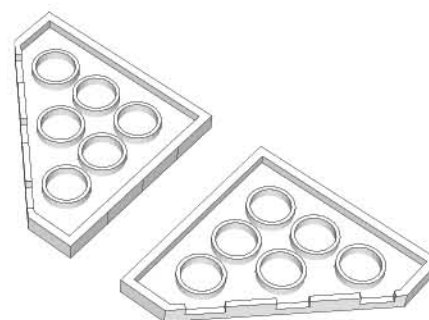

STEP 18

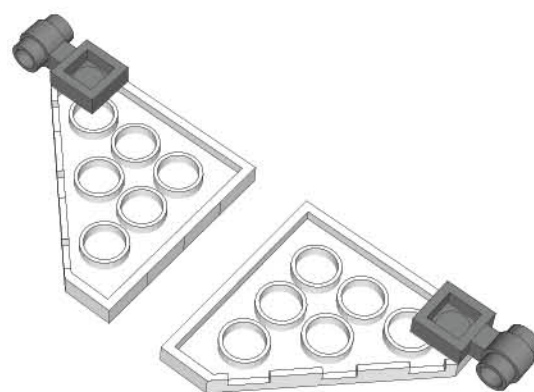

STEP 19

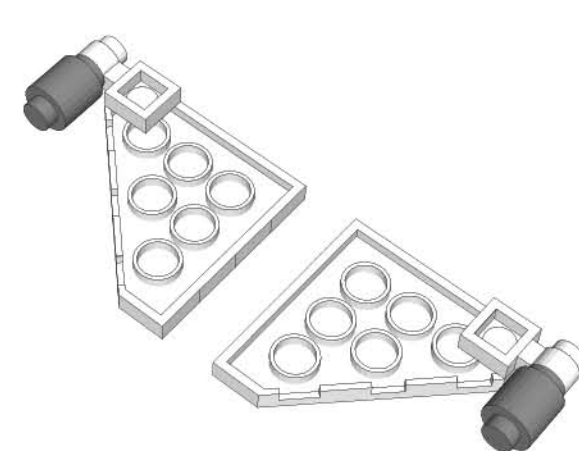

STEP 20

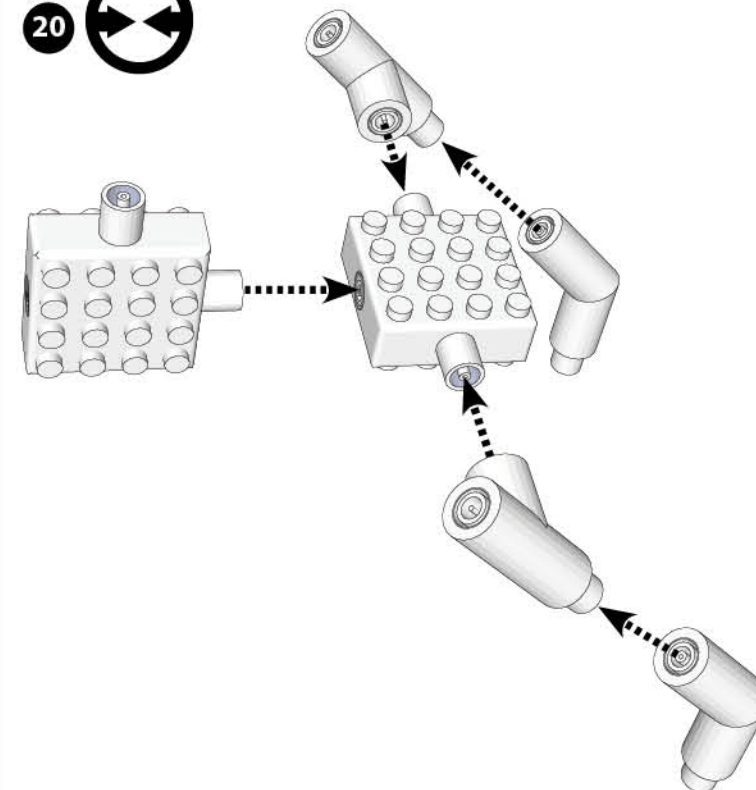

STEP 21

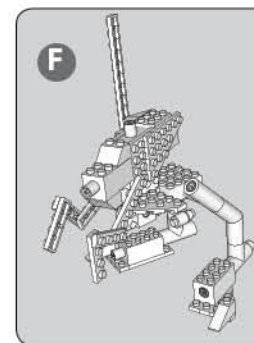
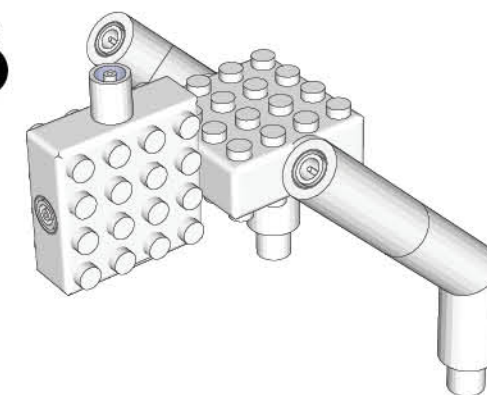

F



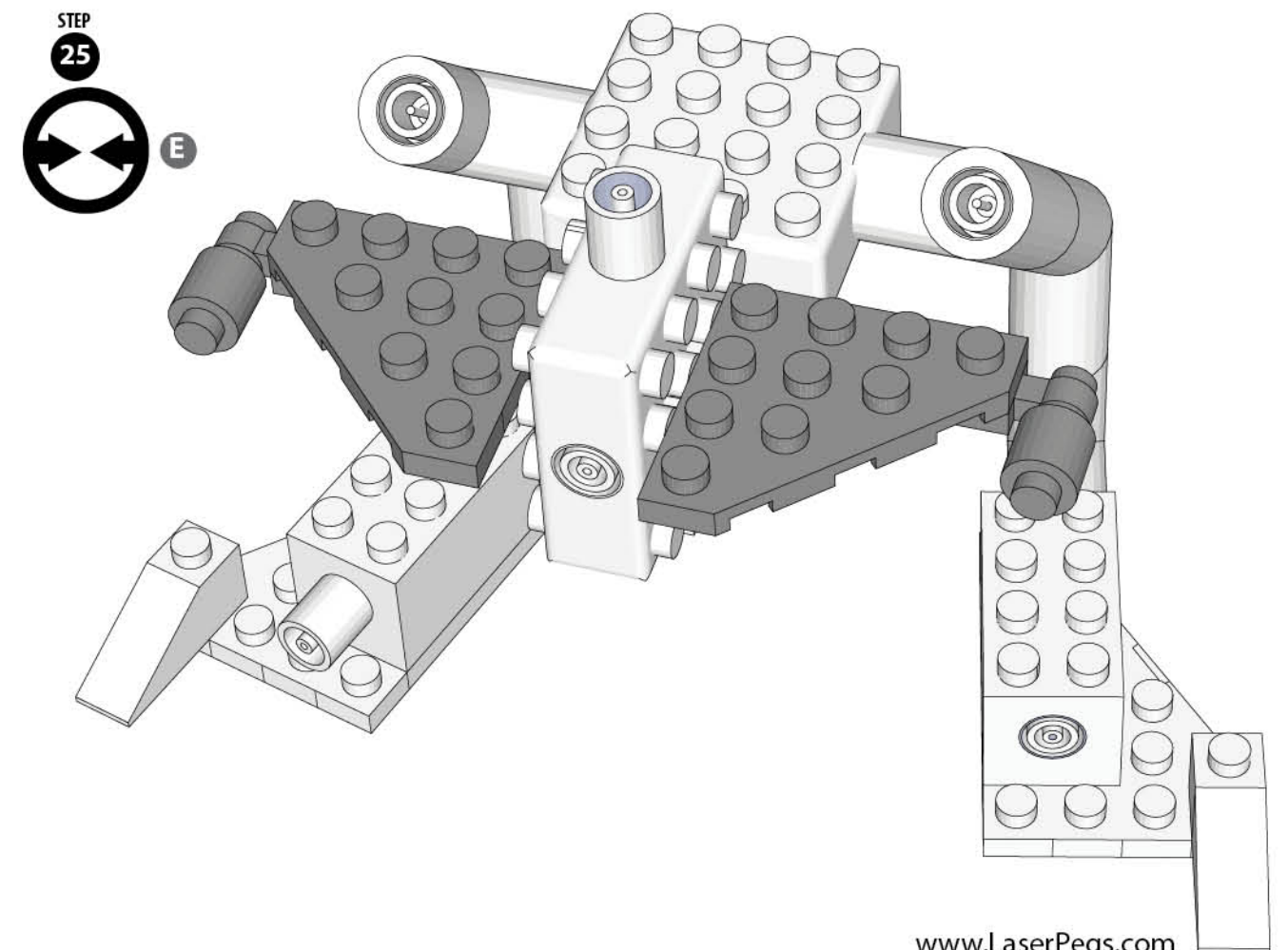
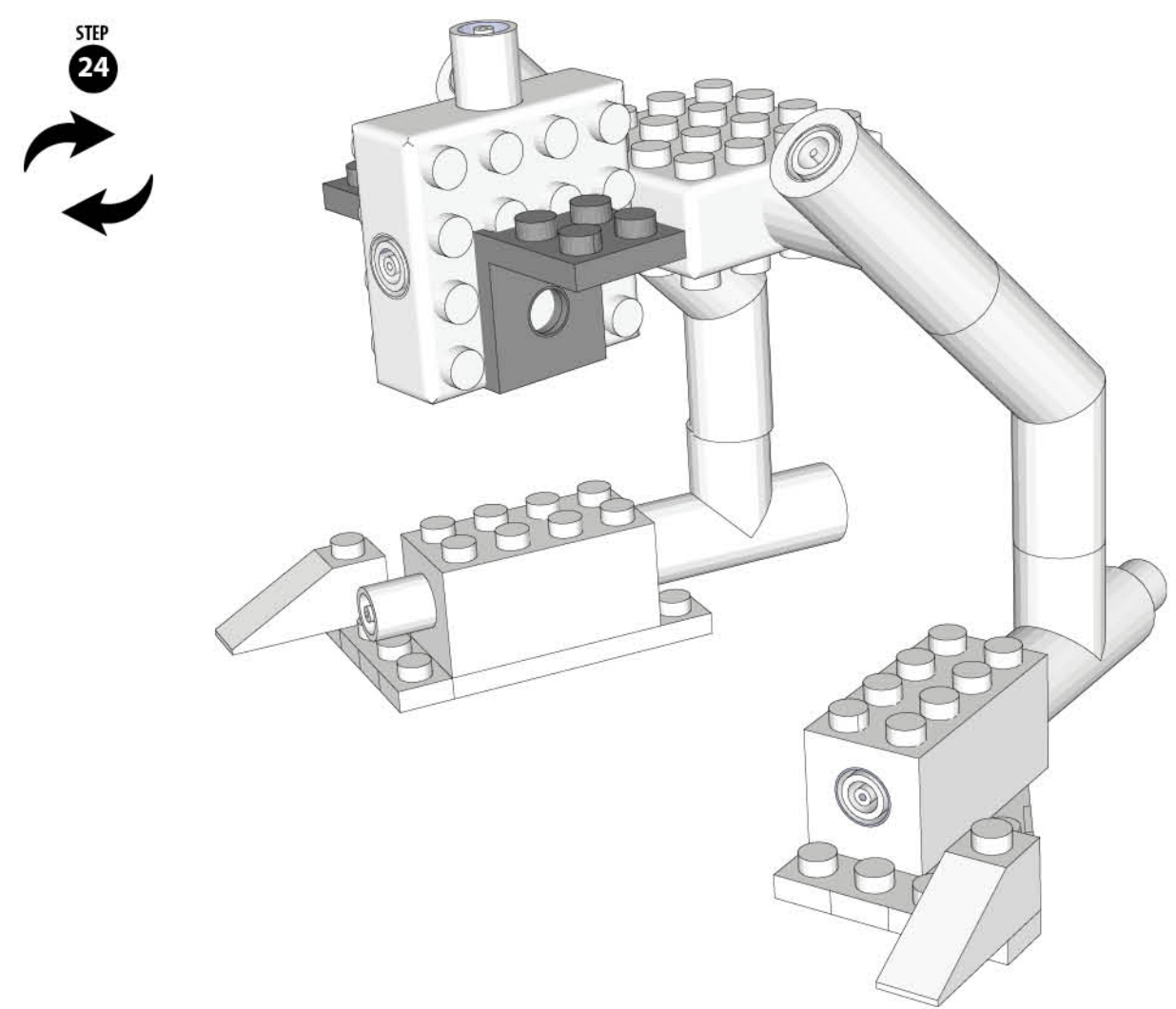
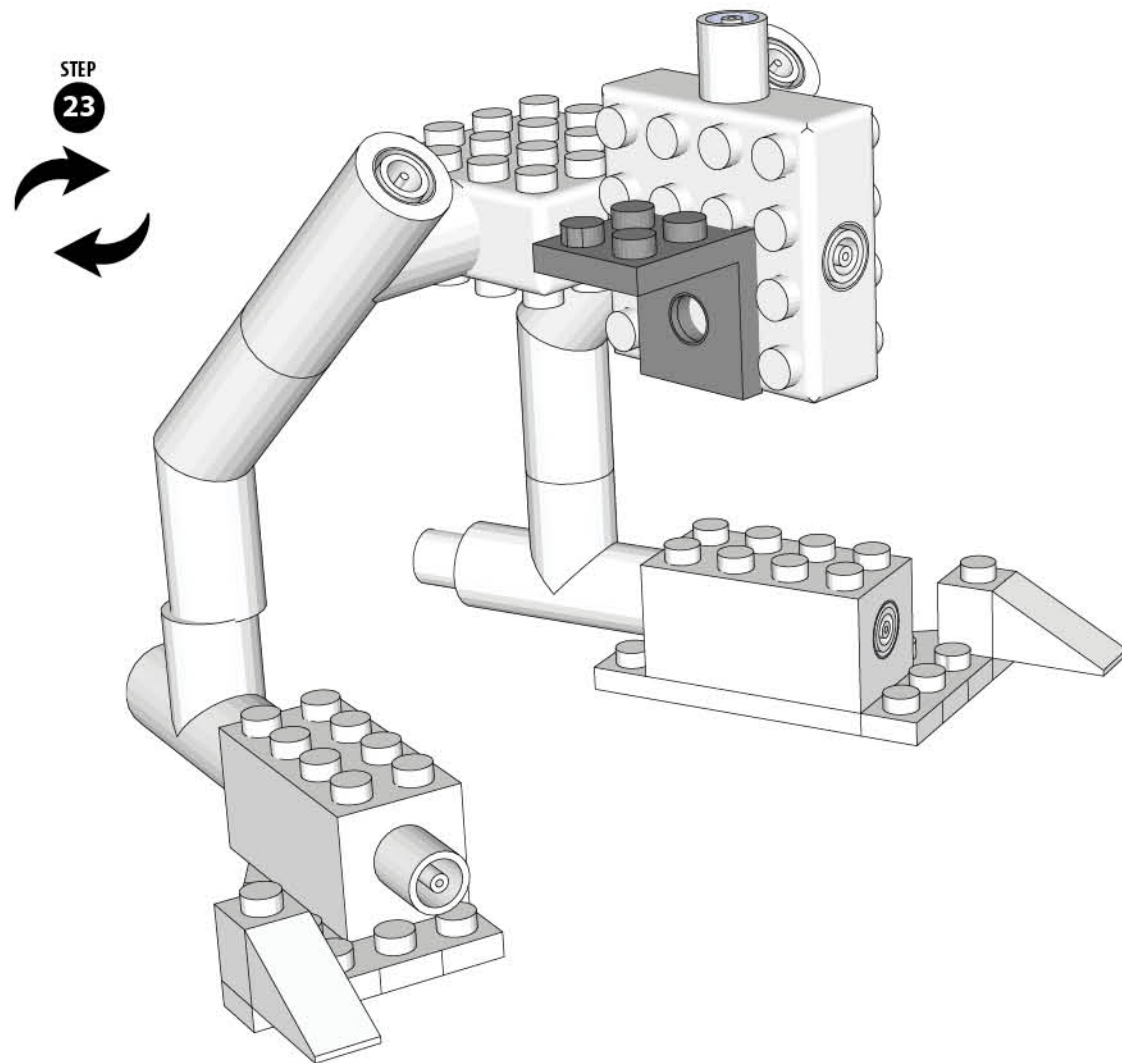
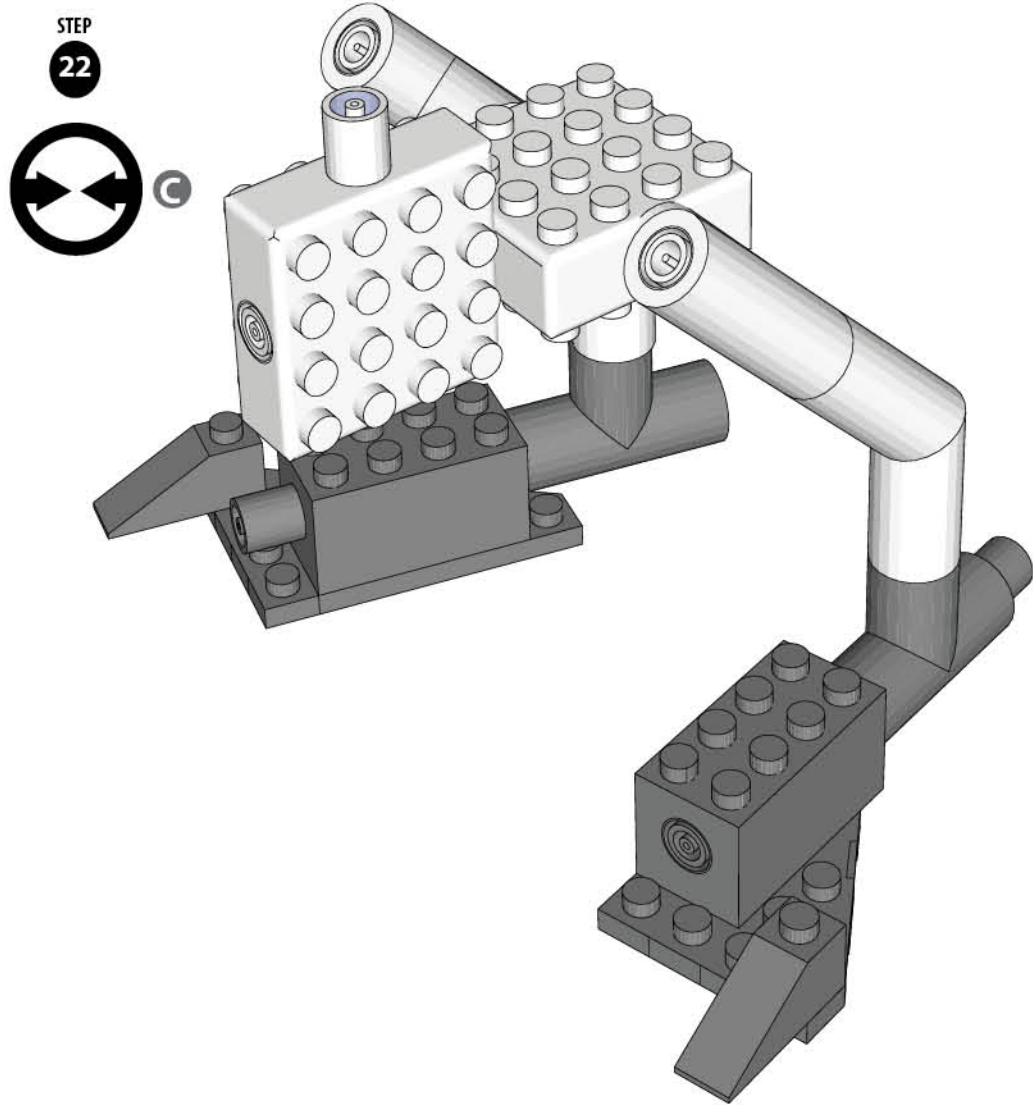

STEP

26

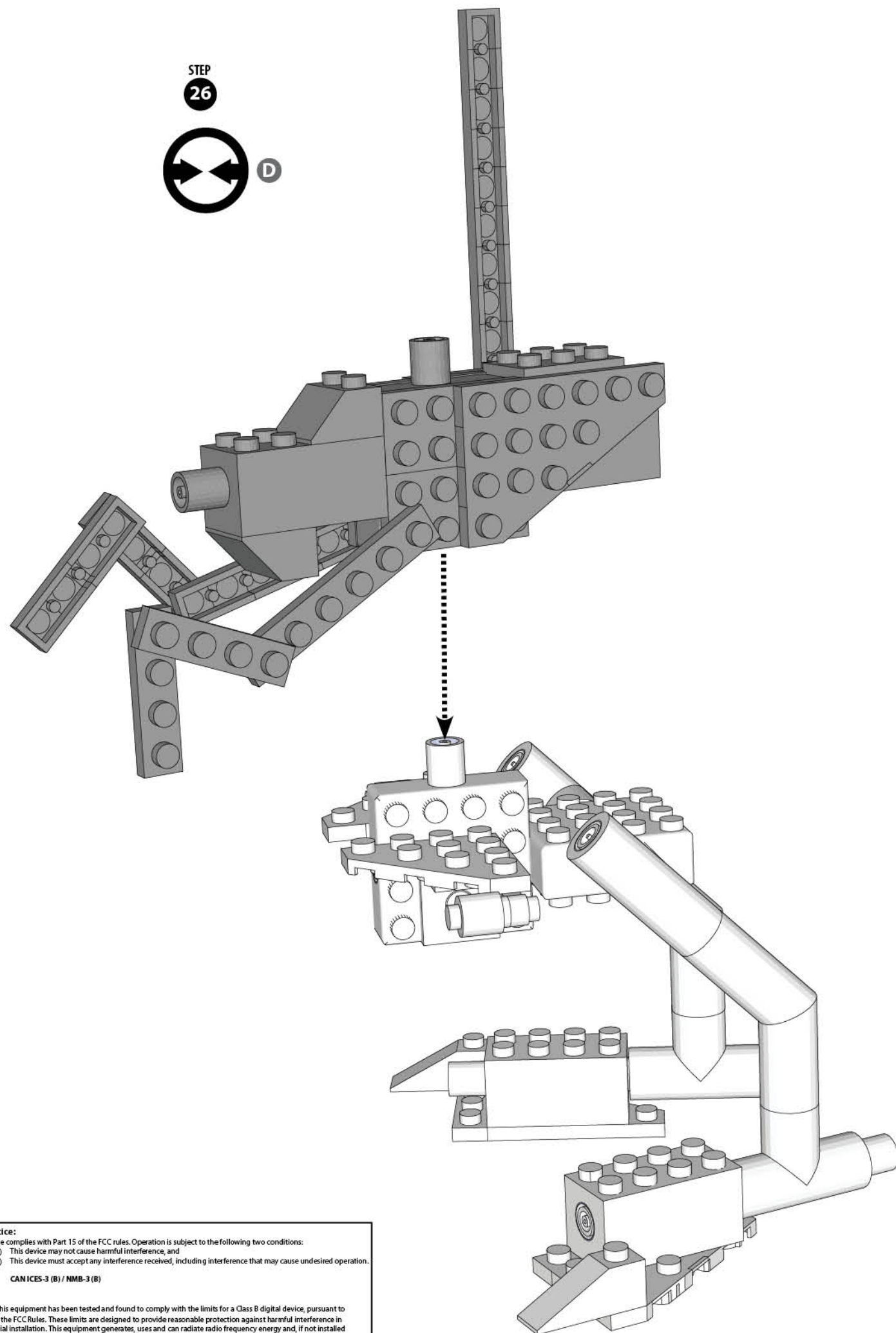

STEP

27

**ATTACH MODEL TO THE  
TRIANGLE POWER BASE  
WITH THE PEG CORD**

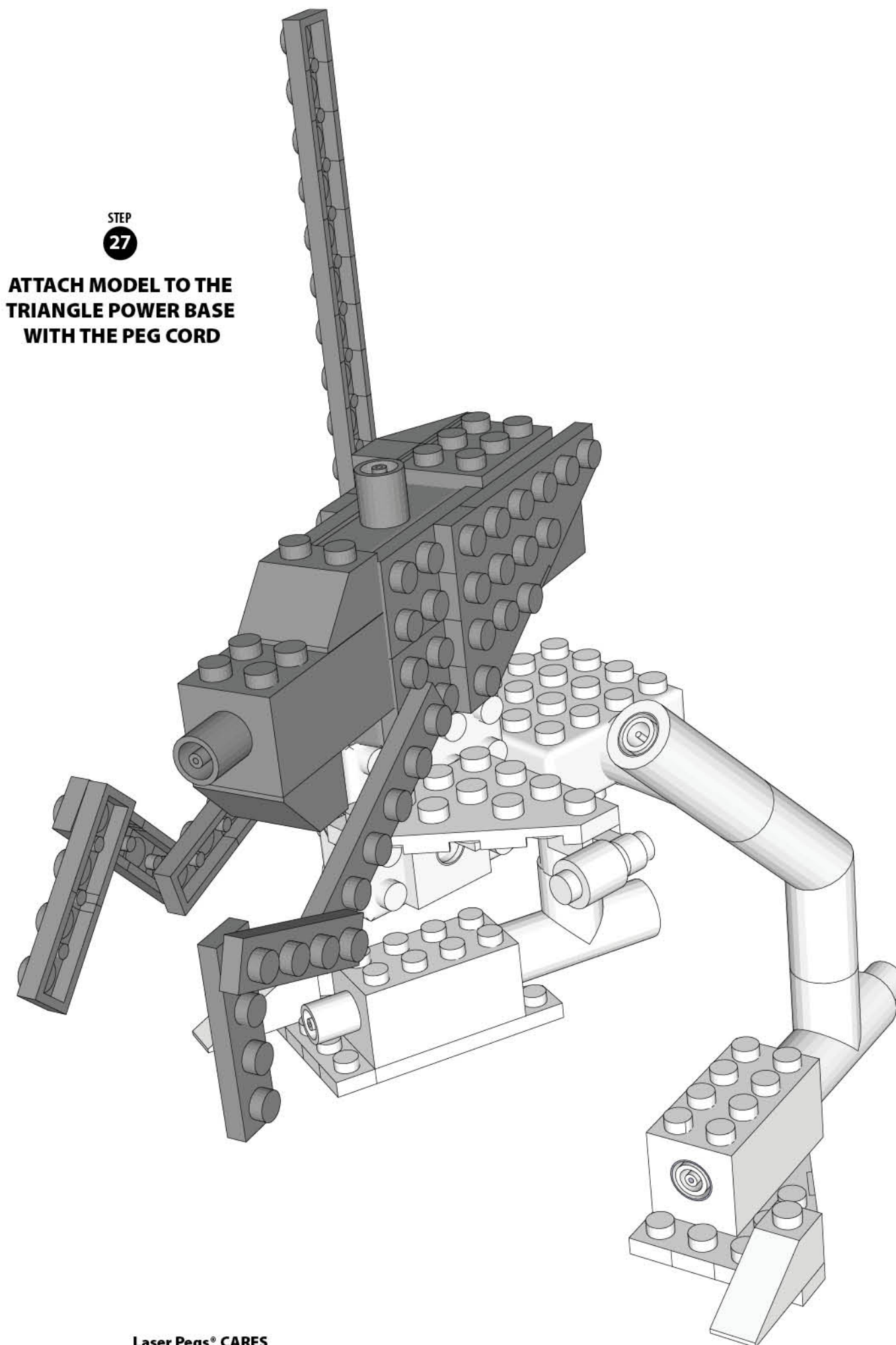

**FCC Notice:**  
This device complies with Part 15 of the FCC rules. Operation is subject to the following two conditions:  
1) This device may not cause harmful interference, and  
2) This device must accept any interference received, including interference that may cause undesired operation.

**CAN ICES-3 (B) / NMB-3 (B)**

**NOTE:** This equipment has been tested and found to comply with the limits for a Class B digital device, pursuant to Part 15 of the FCC Rules. These limits are designed to provide reasonable protection against harmful interference in a residential installation. This equipment generates, uses and can radiate radio frequency energy and, if not installed and used in accordance with the instructions, may cause harmful interference to radio communications. However, there is no guarantee that interference will not occur in a particular installation. If this equipment does cause harmful interference to radio or television reception, which can be determined by turning the equipment off and on, the user is encouraged to try to correct the interference by one or more of the following measures:

- Reorient or relocate the receiving antenna.
- Increase the separation between the equipment and receiver.
- Consult the dealer or an experienced radio/TV technician for help.

**Laser Pegs® CARES**  
**Questions? Comments?**  
**For additional compliance info:**  
**1-866-432-3735**  
**Contact: Support@LaserPegs.com**

MADE IN CHINA  
[www.LaserPegs.com](http://www.LaserPegs.com)  
Copyright 2014© All Rights Reserved Global & Multiple Patents Pending.  
US Patent #7,731,558