

LASER PEGS®

The Ultimate Construction Toy For Kids®

G9030B

**SPACE
FIGHTER
AGES 5+**

16 Models+
Any creation you can build

LIGHTED
CONSTRUCTION SET INCLUDES:

- 20 Laser Pegs®
 - 82 Construction Parts
 - Triangle Power Base
 - Instruction Manual
- Requires 3 AA Batteries

Please read this manual before you begin! Failure to follow this manual's instructions may result in damage to the Triangle Power Base, AC Adapter and/or Laser Pegs®. Not adhering to these instructions will void the manufacturer's warranty. The packaging must be kept because it contains important information.

WARNING:
CHOKING HAZARD—Small parts.
Not for children under 3 yrs.
Do not submerge in water.

EN71, RoHS COMPLIANT

Batteries NOT
Included



This product complies to
all safety requirements
of ASTM F 963

MODEL INSTRUCTIONS

All additional model instructions can
be downloaded at www.LaserPegs.com

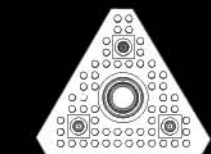
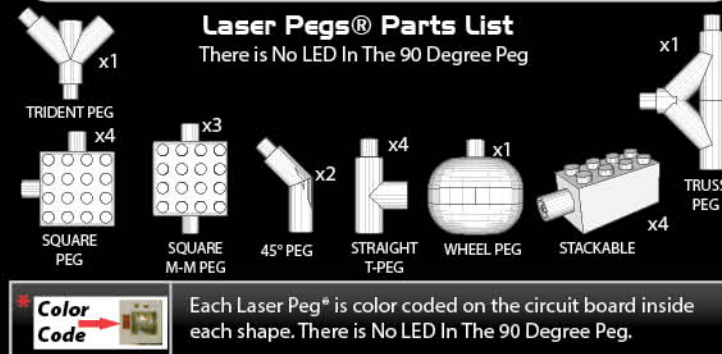

Sound Activated
Triangle Power Base



Laser Pegs®
Peg Cord

Construction Parts List

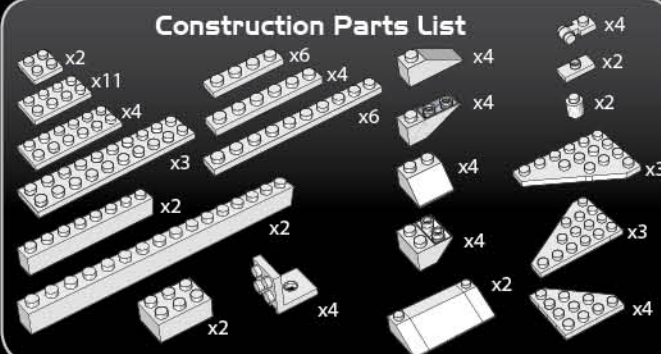

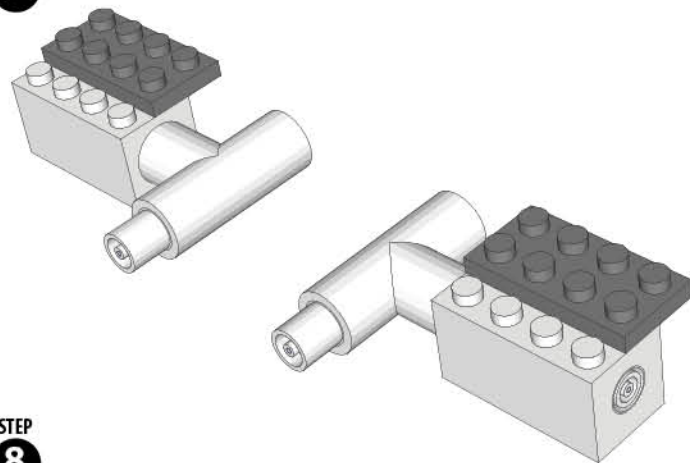
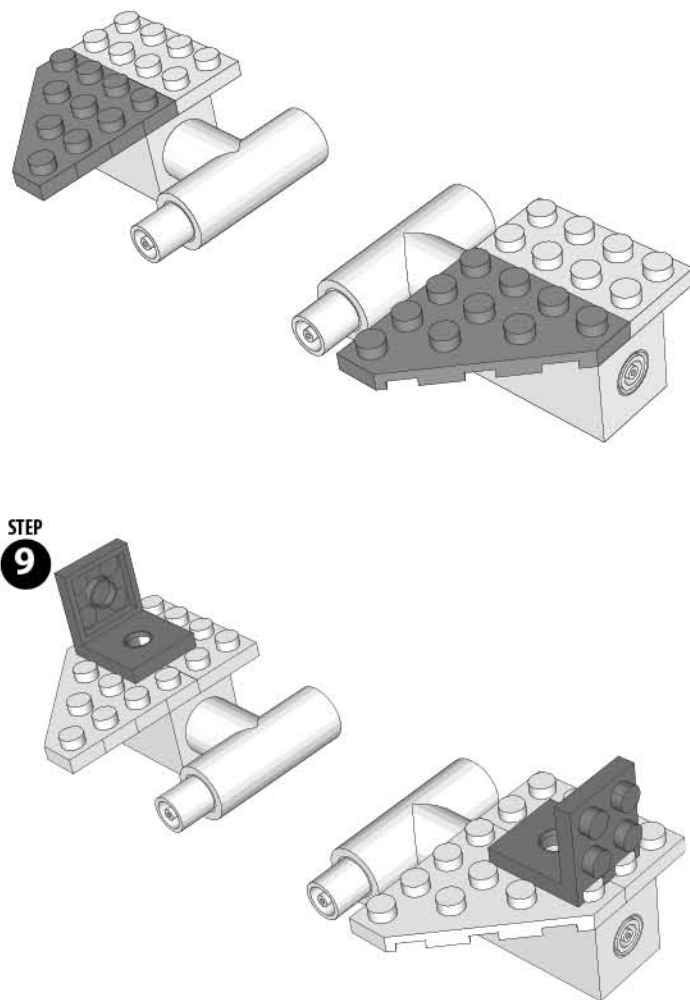
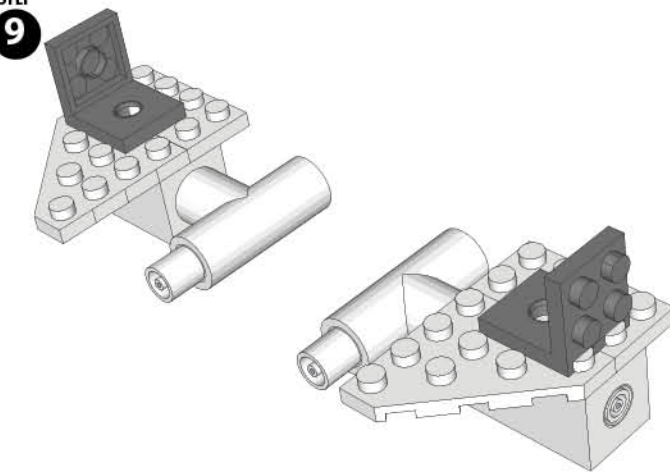
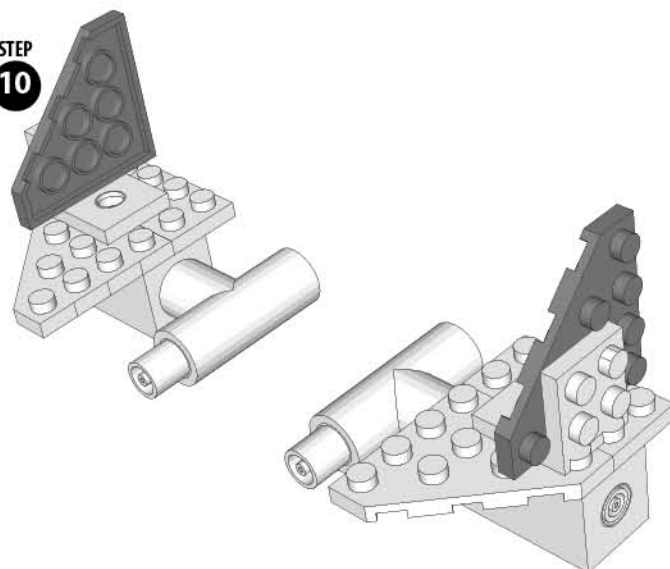
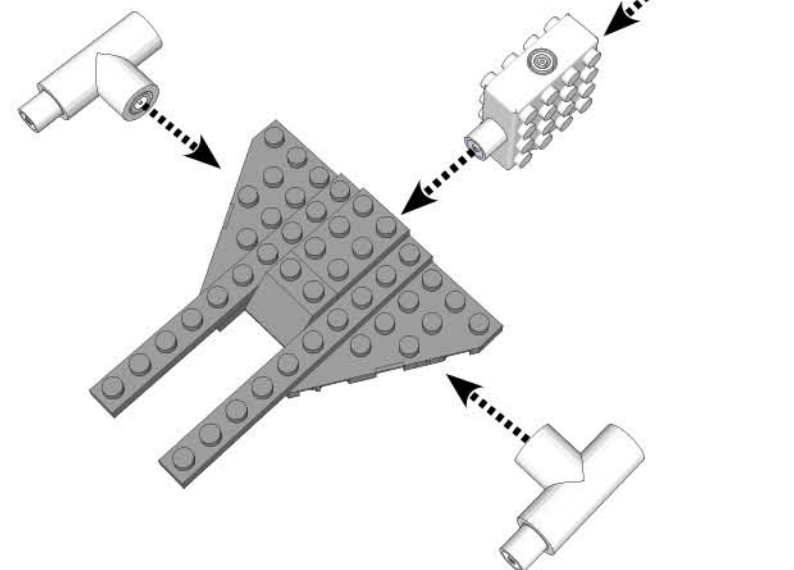
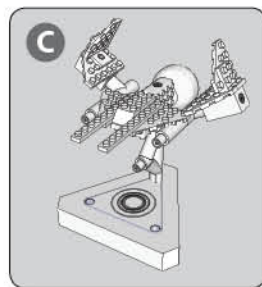
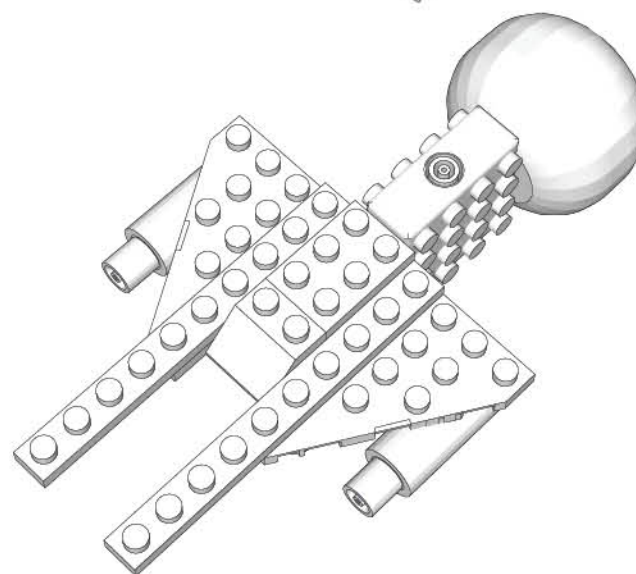
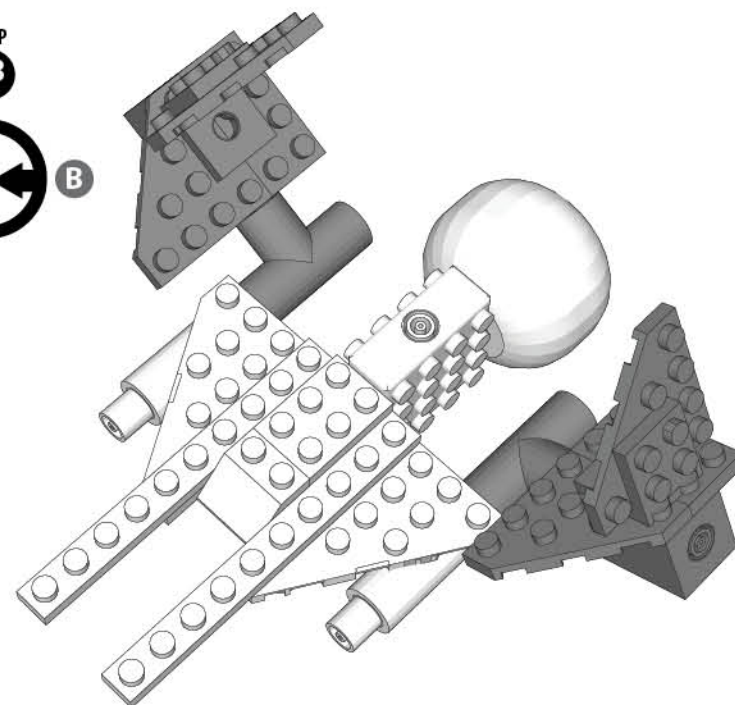
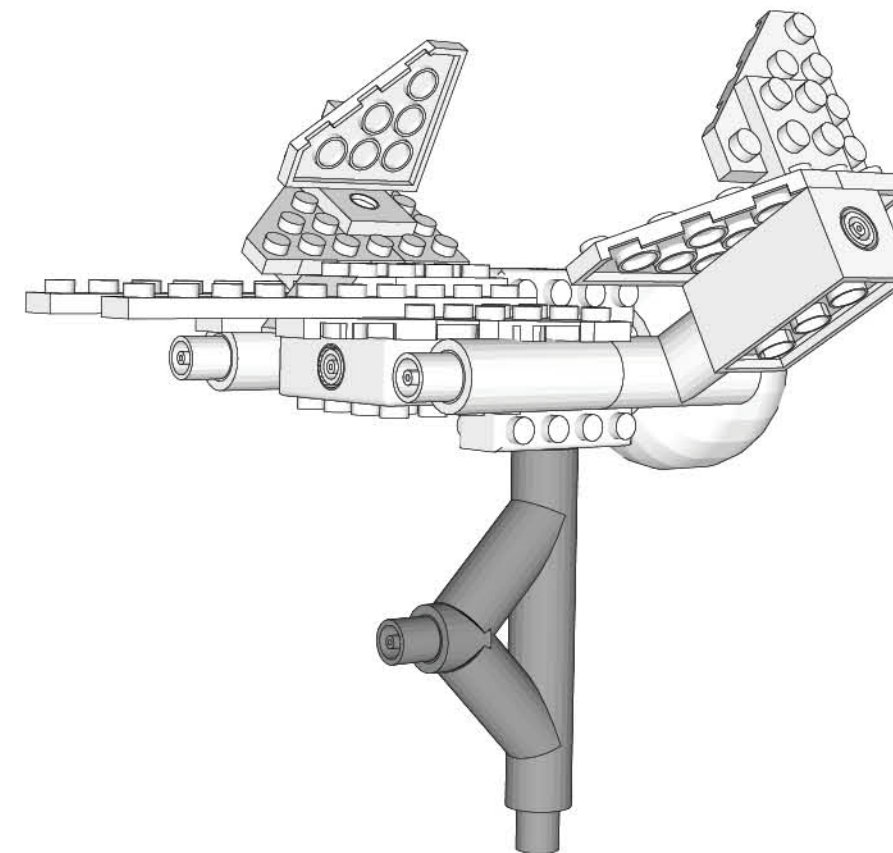
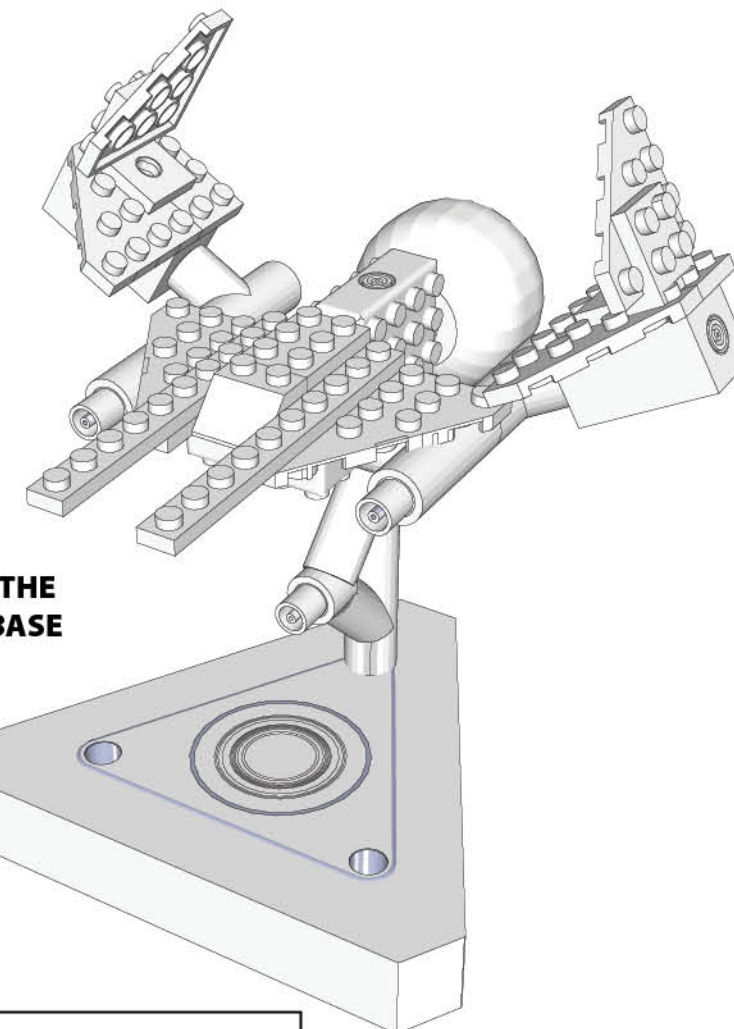
STEP
7STEP
8STEP
9STEP
10STEP
11STEP
12STEP
13STEP
14STEP
15

ATTACH MODEL TO THE TRIANGLE POWER BASE

FCC Notice:

This device complies with Part 15 of the FCC rules. Operation is subject to the following two conditions:

- 1) This device may not cause harmful interference, and
- 2) This device must accept any interference received, including interference that may cause undesired operation.

CAN ICES-3 (B) / NMB-3 (B)

NOTE: This equipment has been tested and found to comply with the limits for a Class B digital device, pursuant to Part 15 of the FCC Rules. These limits are designed to provide reasonable protection against harmful interference in a residential installation. This equipment generates, uses and can radiate radio frequency energy and, if not installed and used in accordance with the instructions, may cause harmful interference to radio communications. However, there is no guarantee that interference will not occur in a particular installation. If this equipment does cause harmful interference to radio or television reception, which can be determined by turning the equipment off and on, the user is encouraged to try to correct the interference by one or more of the following measures:

- Reorient or relocate the receiving antenna.
- Increase the separation between the equipment and receiver.
- Consult the dealer or an experienced radio/TV technician for help.

MADE IN CHINA

www.LaserPegs.com

Copyright 2014© All Rights Reserved Global & Multiple Patents Pending.
US Patent #7,731,558