

LASER PEGS®

The Ultimate Construction Toy For Kids®

NATIONAL GEOGRAPHIC™
DINOSAURS
Ages 5 +

24 Models+
ANY CREATION YOU CAN BUILD
LIGHT UP
CONSTRUCTION SET INCLUDES:

- 27 Laser Pegs®
- 191 Construction Parts
- Laser Pegs® Peg Cord
- Triangle Power Base
- Instruction Manual

Requires 3-AA Batteries

Batteries NOT Included



EN71, RoHS COMPLIANT

This product complies to all safety requirements of ASTM F 963

MODEL INSTRUCTIONS

All additional model instructions can be downloaded at www.LaserPegs.com

Laser Pegs® Parts List

There is No LED In The 90 Degree Peg

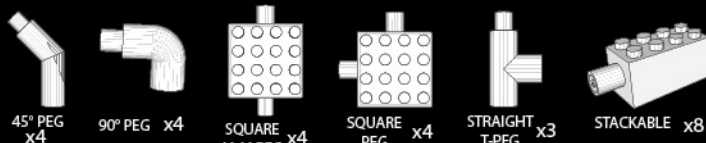

Each Laser Peg® is color coded on the circuit board inside each shape. There is No LED In The 90 Degree Peg.



Laser Pegs® link that allows you to connect to other construction kits.

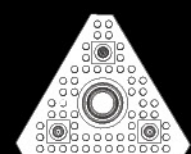

Sound Activated Triangle Power Base

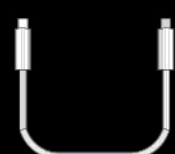

Laser Pegs® Peg Cord

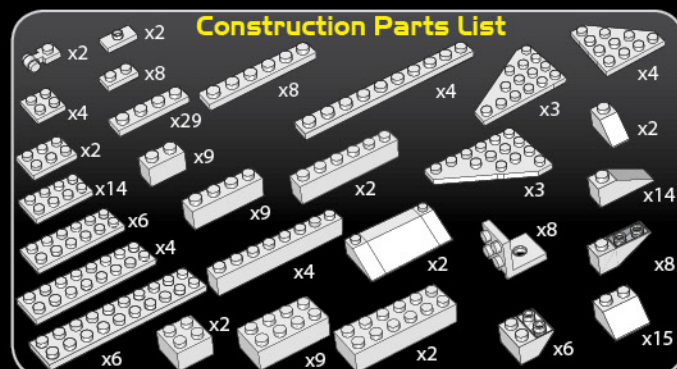

www.LaserPegs.com

This manual is copyright and cannot be reproduced or used online without Laser Pegs® Ventures LLC permission. © Copyright 2014. All Rights Reserved US Patent #7,731,558 Additional Global & Multiple Patents Pending. Laser Pegs® Ventures LLC. 8304 Consumer Ct Sarasota FL. 34240. Contact: Support@LaserPegs.com

Connecting Pegs

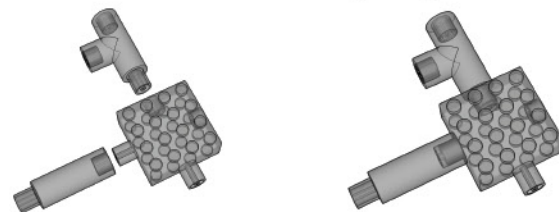

To construct with Laser Pegs®, slide two pieces together to form a connection. Slide each piece on and off smoothly. The 90° Pegs are essential to construction but they DO NOT LIGHT UP.

Environmental Phenomena

* The unit may malfunction if subjected to radio-frequency interference. It SHOULD revert to normal operation when the interference stops. If not, it may become necessary to turn the power off and back on, or remove and reinstall the batteries.

* In the unlikely event of an electrostatic discharge, the unit may malfunction and lose memory, requiring the user to reset the device by removing and reinstalling the batteries.

Push Red Power Button to turn on/off

Push Red Power Button to cycle through 4 different light settings.

SOUND/ON/FLASH/FLASH FASTER

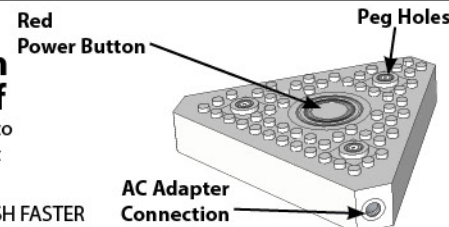

WARNING: STROBE LIGHTS MAY CAUSE SEIZURES

Replacing Batteries

1. Remove the three (3) screws.
2. Place three (3) AA batteries in the correct position - as displayed inside the Triangle Power Base.
3. Reassemble the Triangle Power Base.
4. Replace the three (3) screws.
5. Push RED Power Button to turn on!
6. Do not mix old and new batteries.
7. Do not mix alkaline, standard (carbon-zinc), or rechargeable (nickel-cadmium, NiMH) batteries!
8. Exhausted batteries are to be removed from the Triangle Power Base.
9. Never connect more than 200 Laser Pegs®
10. Non-rechargeable batteries are not to be recharged.
11. Rechargeable batteries are only to be recharged under adult supervision.
12. Rechargeable batteries are to be removed from the toy before being recharged.
13. Batteries are to be inserted with the correct polarity.
14. The supply terminals are not to be short-circuited.
15. DO NOT THROW BATTERIES INTO FIRE!

Remove the 3 Phillips head screws

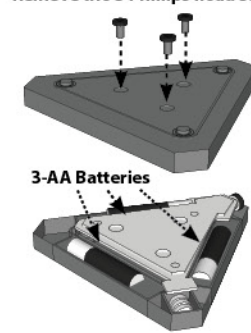

3-AA Batteries

Remove the three Phillips head screws with a 4mm screw driver. Requires (3AA) Batteries

Please dispose of batteries properly as per state and local regulations.

Using an AC Adapter

Remove all batteries from Laser Pegs® power base before using the 5-volt AC adapter.

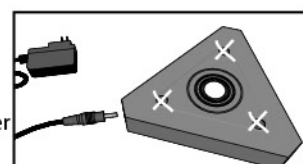

When using an AC Adapter, NEVER place the adapter plug into the Triangle Power Base top peg holes.

*To avoid short-circuits, keep metal objects and other unauthorized materials from obstructing the peg holes.

Never connect more than 200 Laser Pegs® when using a 5-volt (2000mA) AC Adapter.

The AC adapter and the Triangle Power Base are to be regularly examined for damage to the cord, plug, enclosure and other parts, and in the event of such damage, they must not be used until the damage has been repaired.

WARNING! Each Laser Peg® draws current from the batteries. Therefore, the more pegs you use, the quicker you will deplete your battery power! As the power weakens, the current will slowly fail and some Laser Pegs® will illuminate (typically the reds and yellows) and some won't. When the Laser Pegs® dim the Laser Pegs® are not broken, they just need stronger batteries or an AC Adapter.

You have 3 simple options...

1. Use a 5-volt AC Adapter - available from www.LaserPegs.com
2. Change the batteries.
3. Use high quality batteries. They will last a little longer, but they will still deplete rapidly the more laser pegs you connect!

DO NOT SUBMERGE IN WATER

HUAYANGOSAUR: Unlike other dinosaurs in the stegosaur category, huayangosaurs had teeth in the fronts of their mouths and narrow, spike-shaped plates along their backs. Most other stegososaurs had no front teeth and wider back plates.



HUAYANGOSAUR

Model Difficulty Level

4

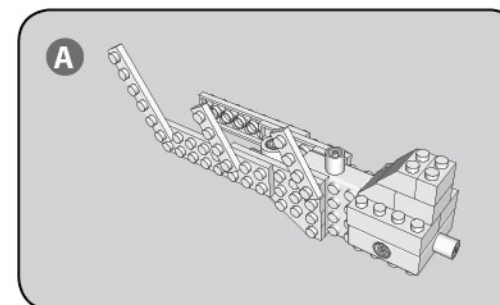
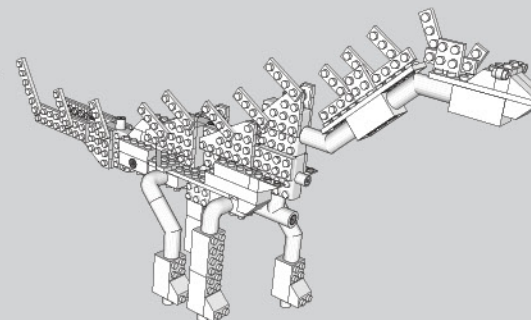

STEP 1

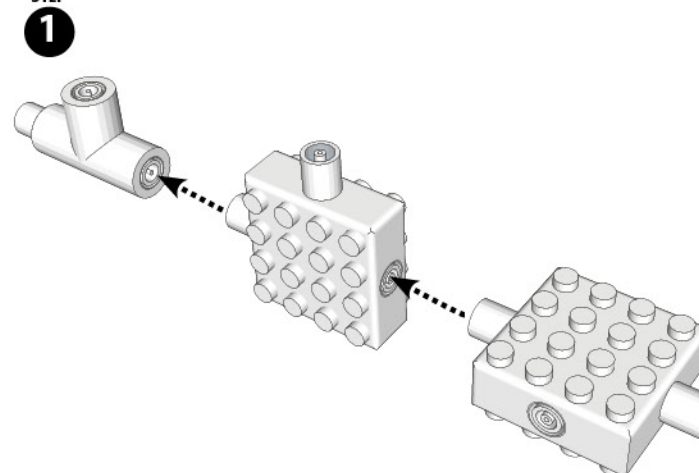

STEP 2

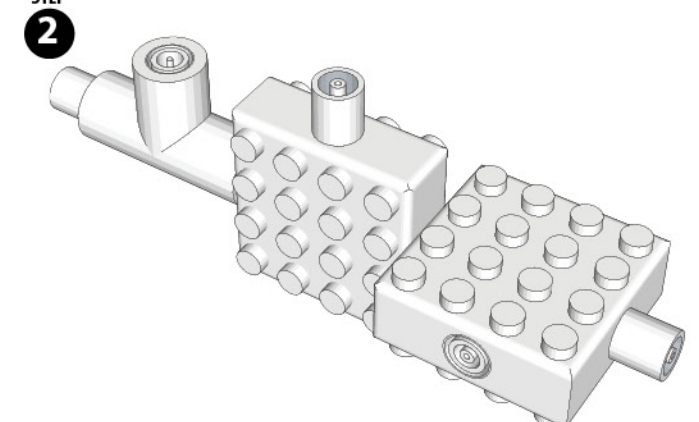

STEP 3

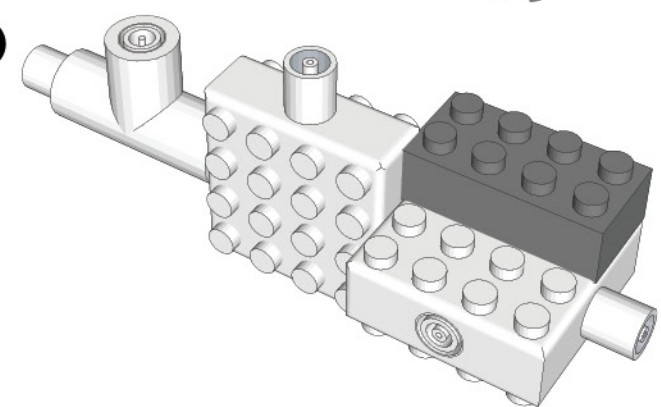

STEP 4

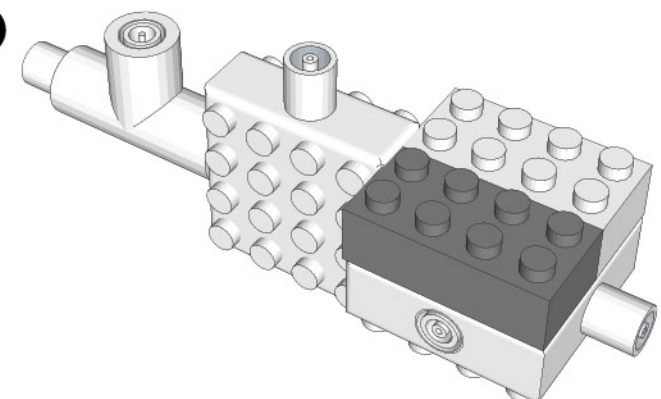

STEP 5

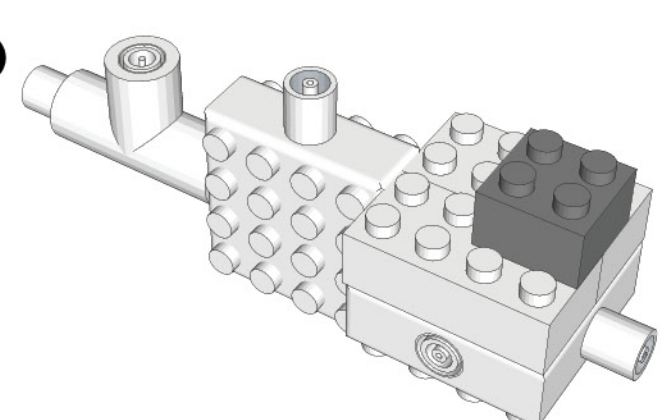

STEP 6

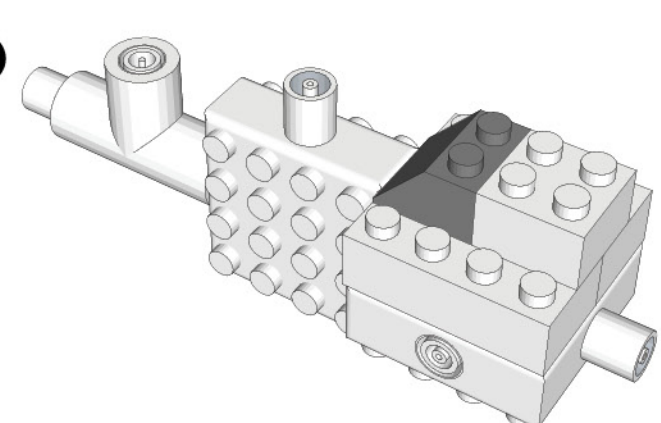

Laser Pegs® CARES

Questions? Comments?

For additional compliance info:

1-866-432-3735

Contact: Support@LaserPegs.com

www.LaserPegs.com

Copyright 2014 © All Rights Reserved Global & Multiple Patents Pending. US Patent #7,731,558

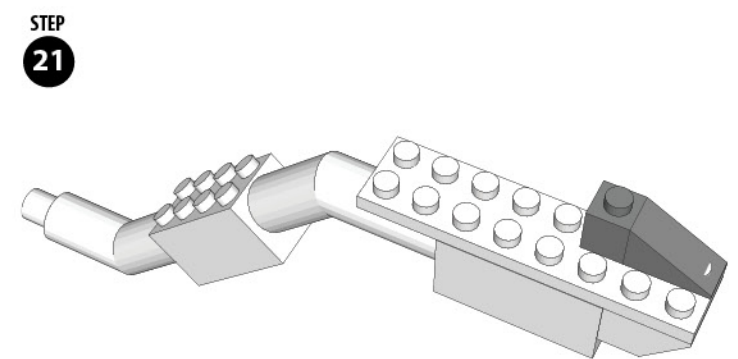
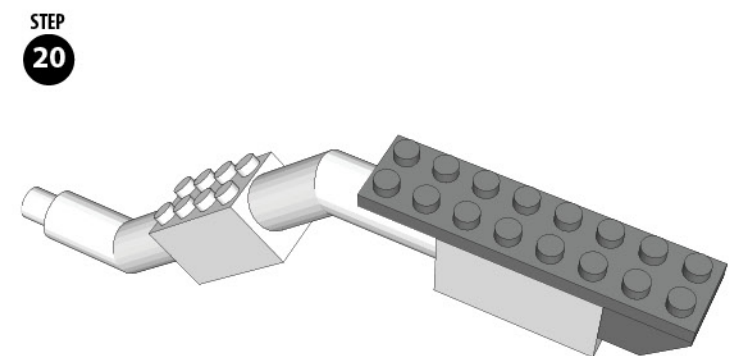
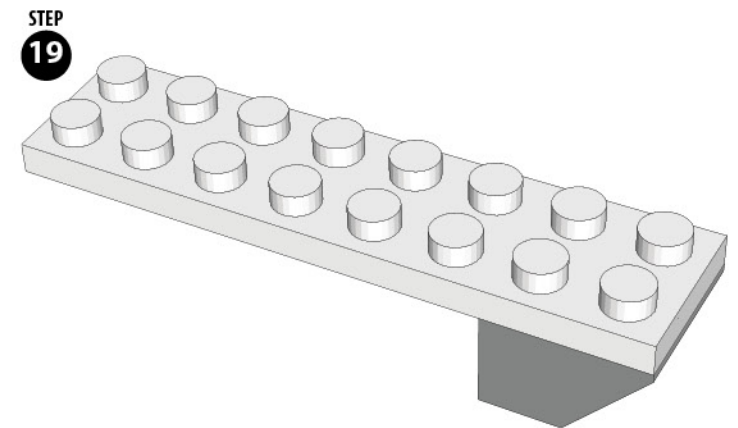
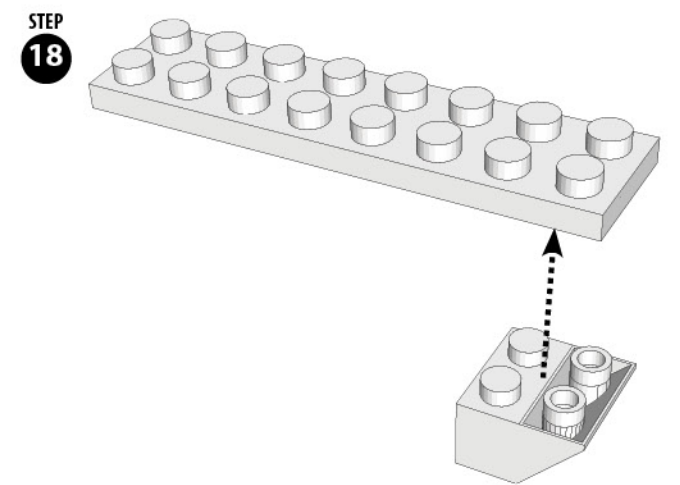
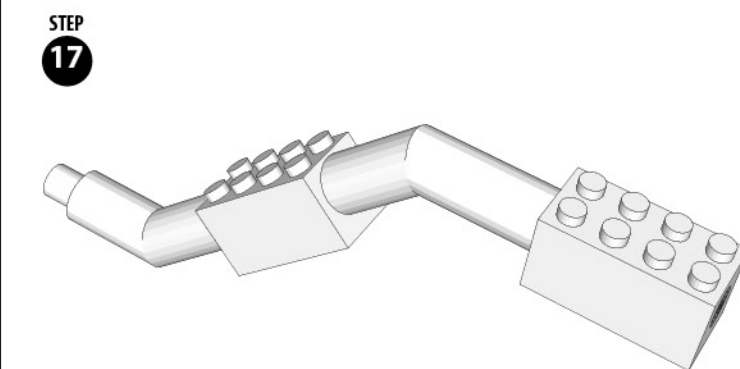
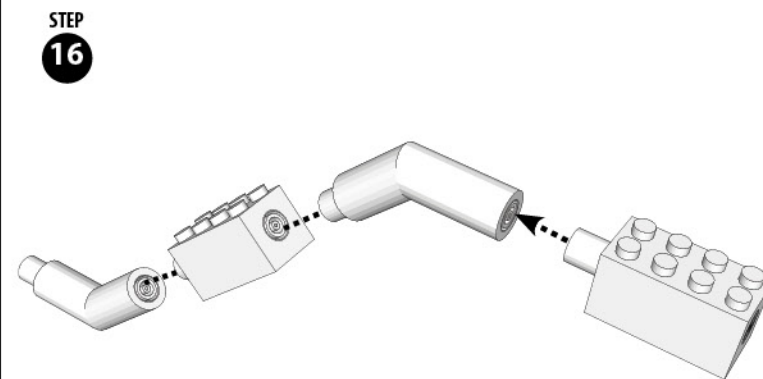
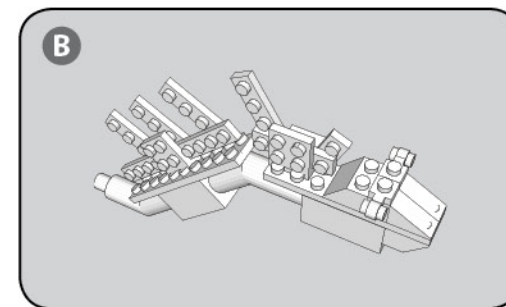
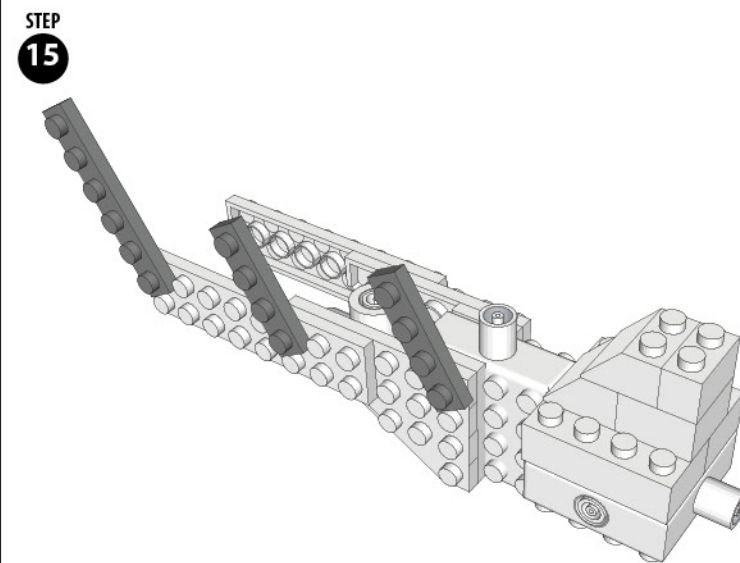
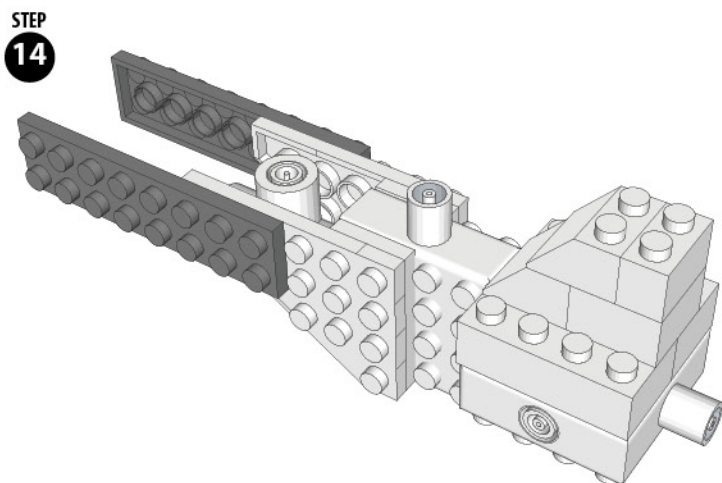
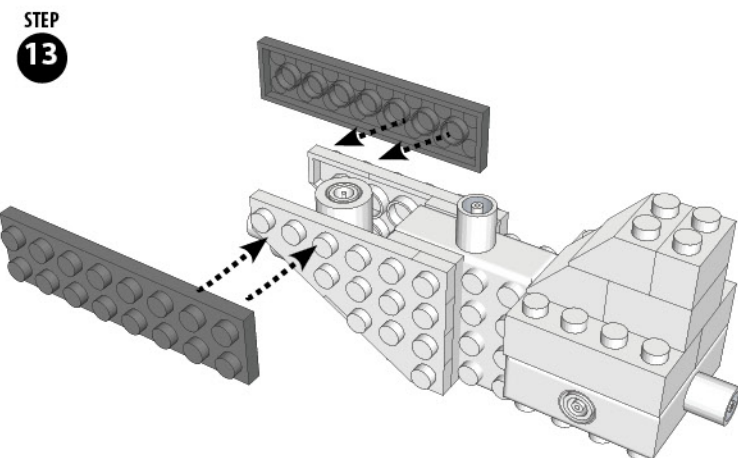
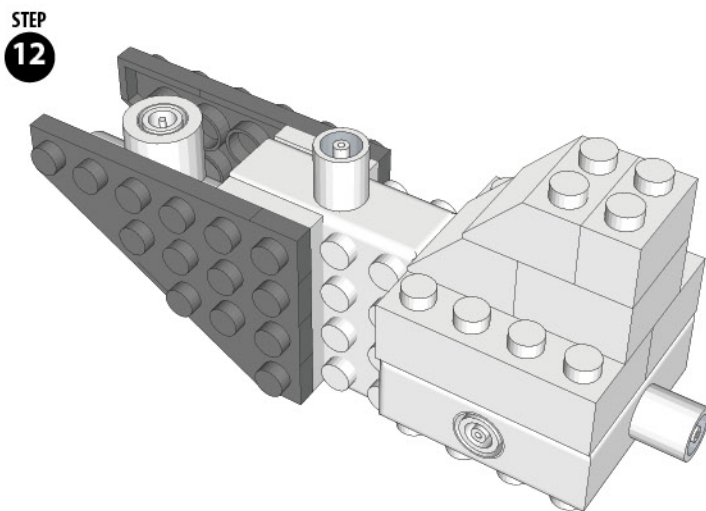
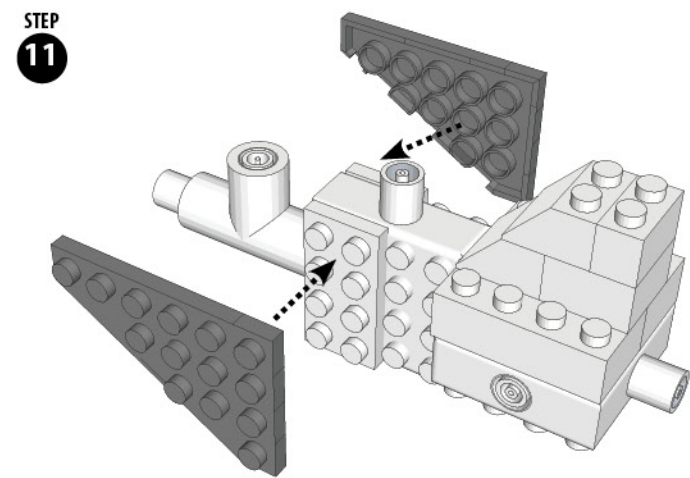
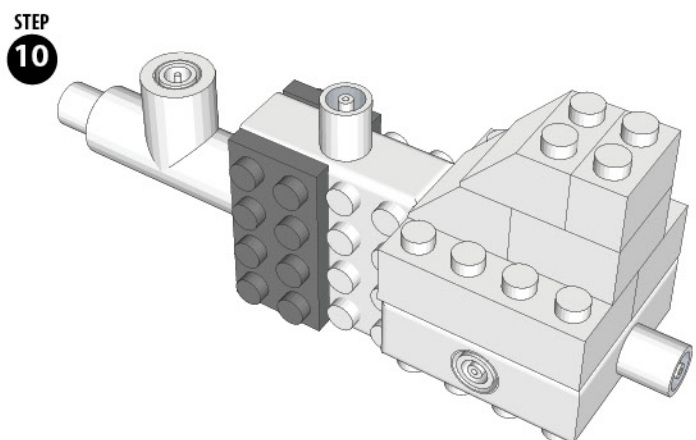
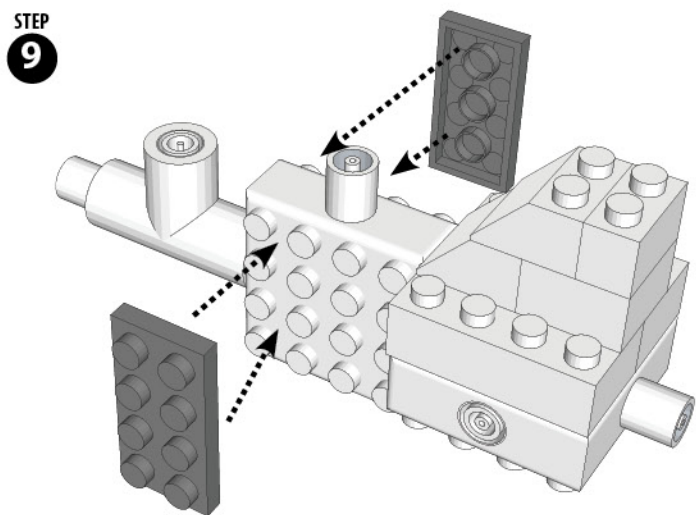
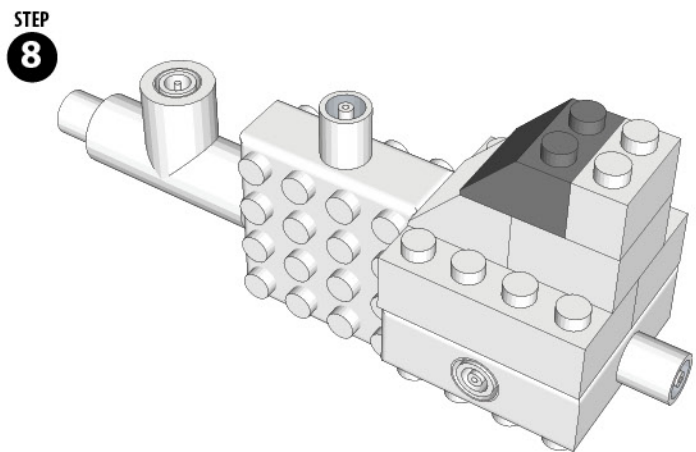
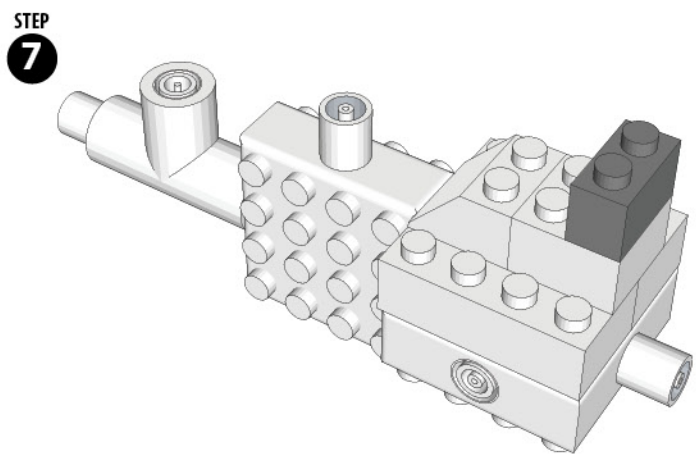

A perspective view of the assembled LEGO Technic model. The motor is connected to a series of gears, which drive a final output mechanism consisting of a long white beam with a black and white angled piece at the end. The model is shown in a 3D perspective view.

A perspective view of the completed LEGO Technic assembly. The motor is connected to a series of gears that drive a final output mechanism, which appears to be a lever or a piston. The assembly is built using a combination of black and white Technic bricks and connectors.

STEP
26

ROTATE



This diagram shows the assembly from the previous step being rotated. A curved arrow labeled "ROTATE" indicates a 90-degree clockwise rotation. The assembly, which includes a white base, a grey motor, and a black sensor unit, is shown in its new orientation.

The diagram illustrates the assembly sequence for a LEGO Technic structure. The sequence begins with a 1x4 plate (bottom left) and proceeds through various connectors and plates, ending with a 1x4 plate (top left). Dotted arrows indicate the assembly path.

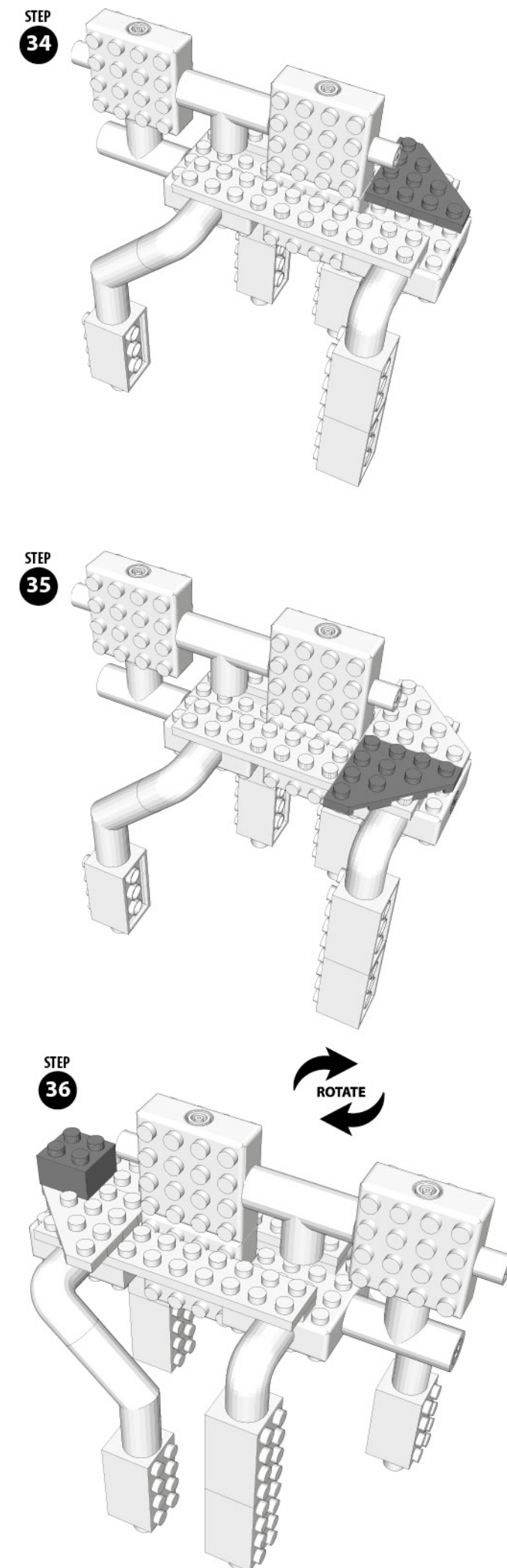
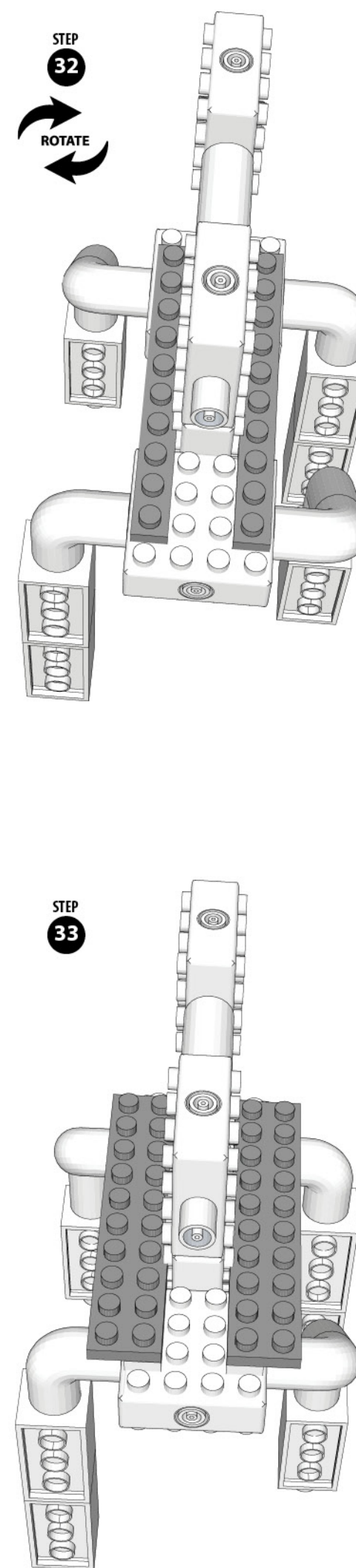
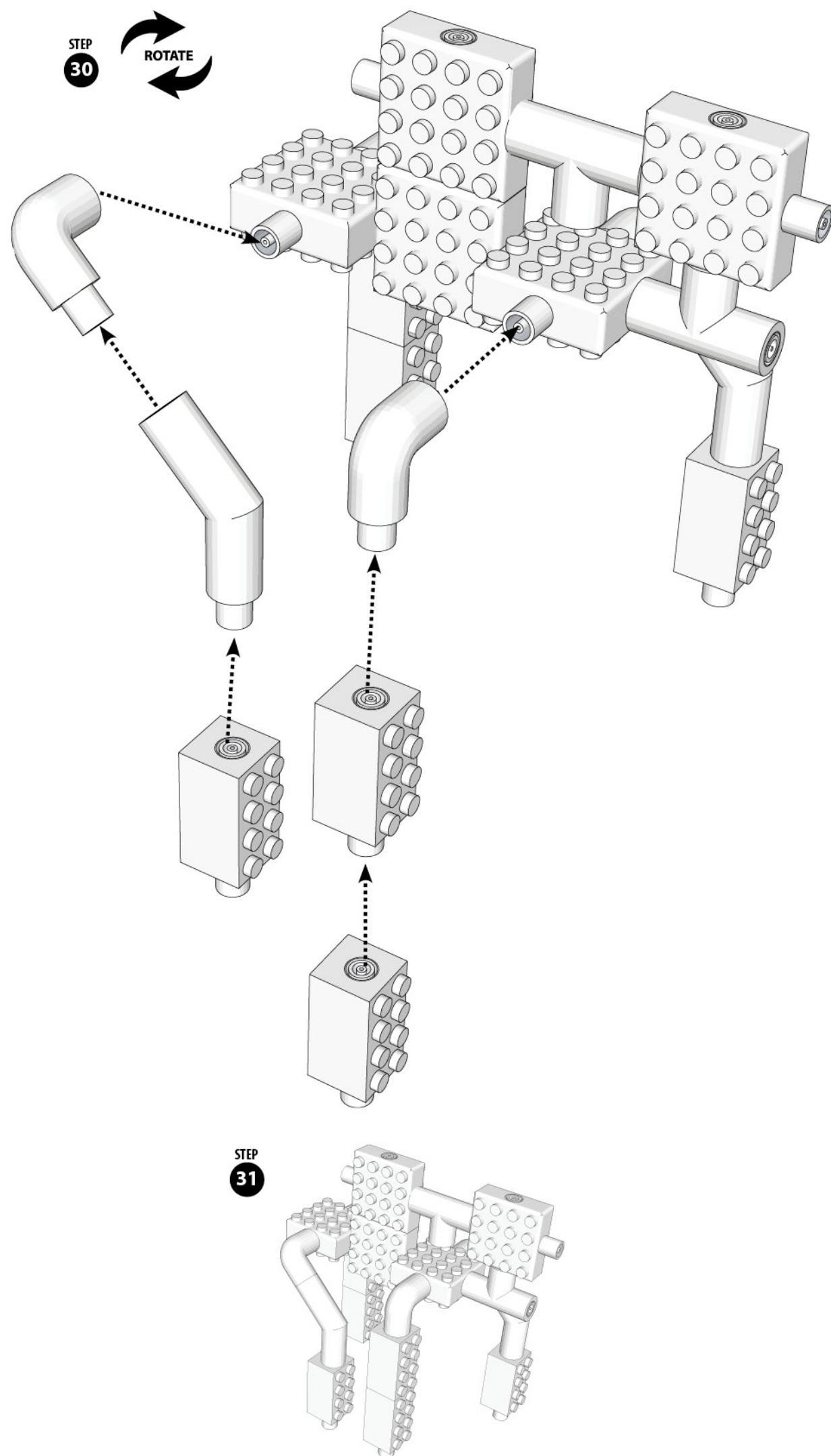

STEP
37

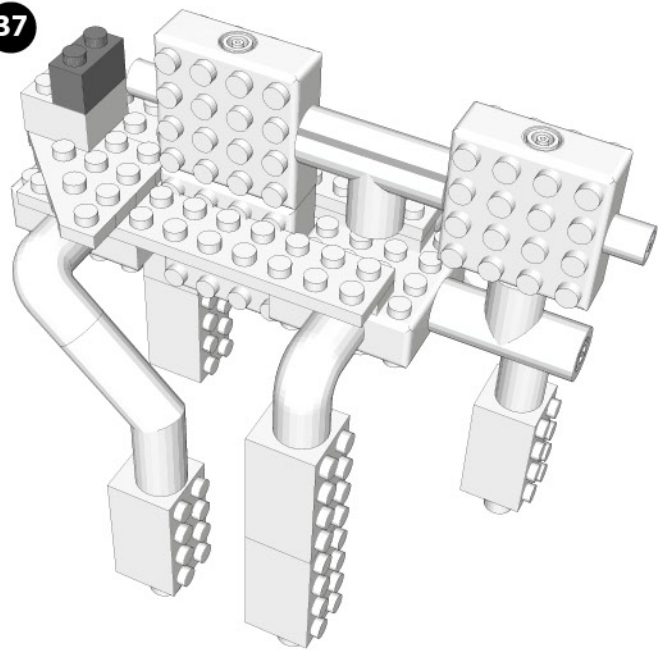

STEP
38

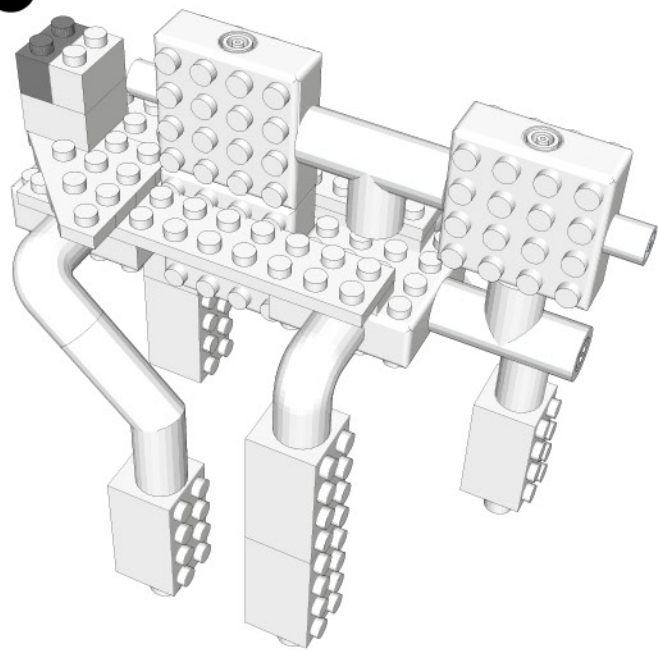

STEP
39

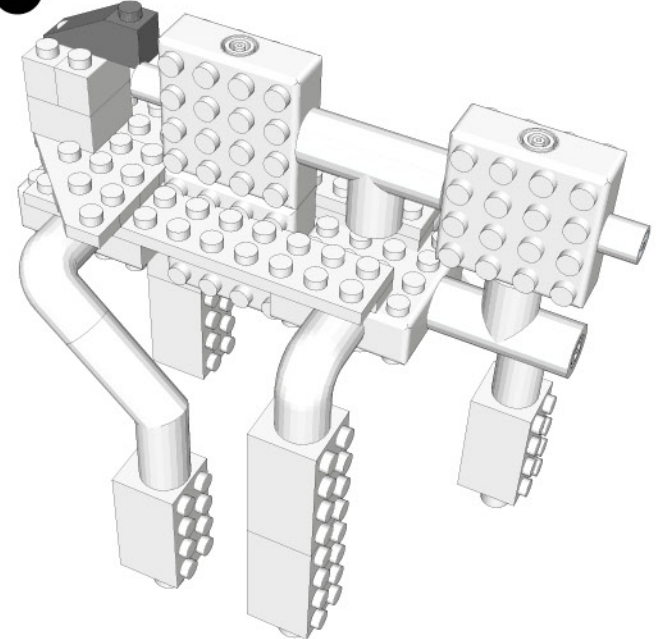

STEP
40

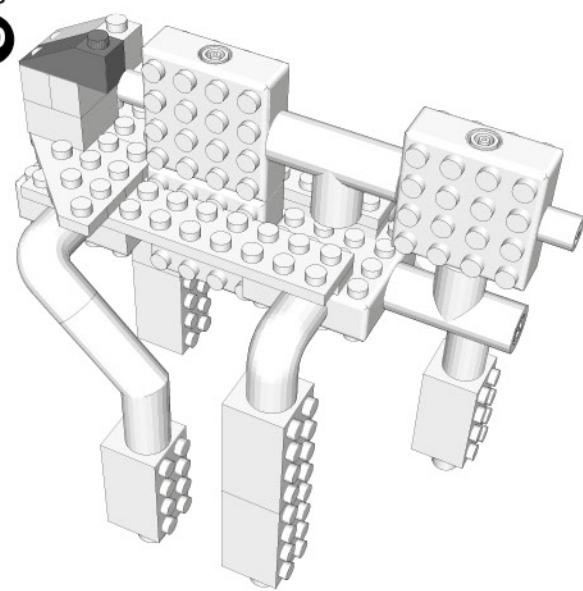

STEP
41

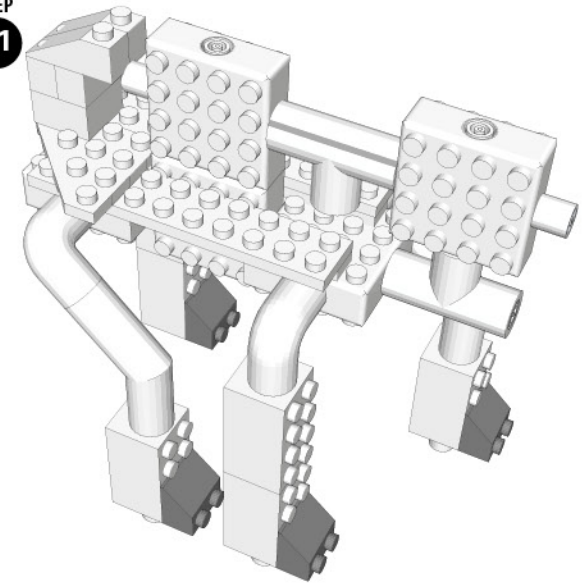

STEP
42

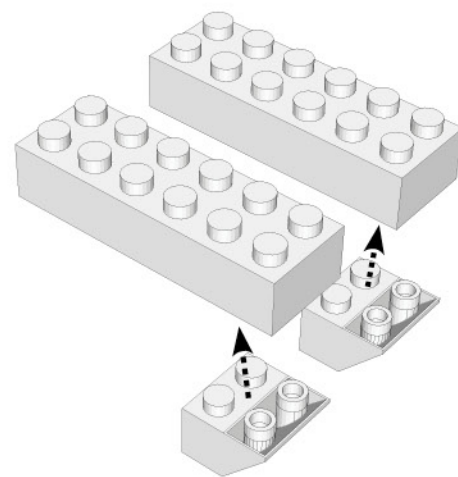

STEP
43

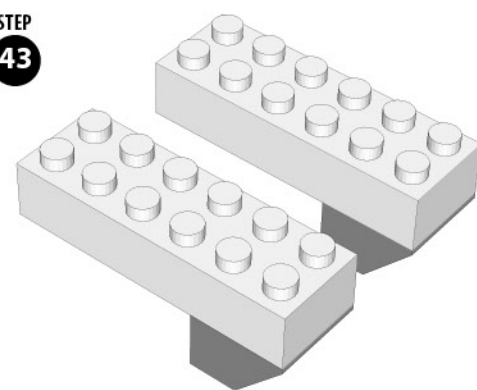

STEP
44

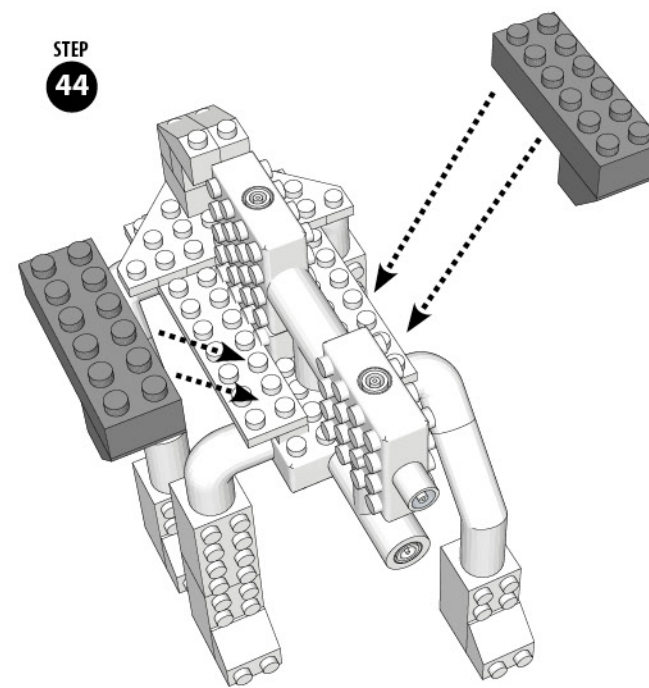

STEP
45

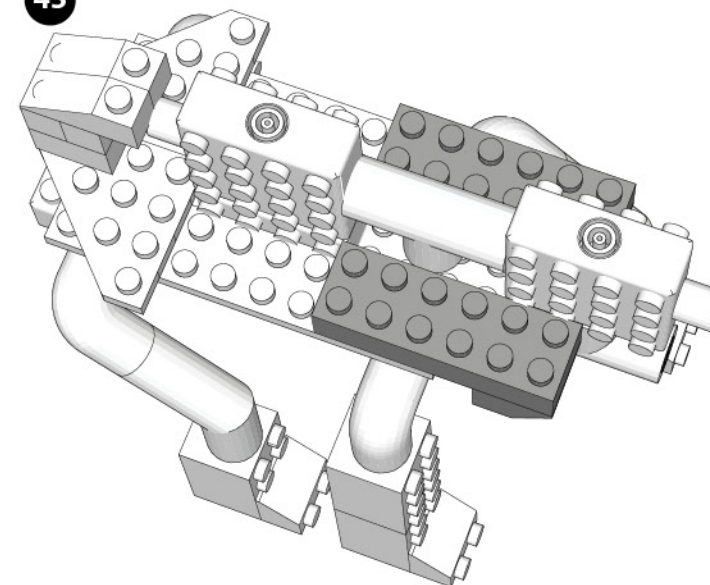

STEP
46

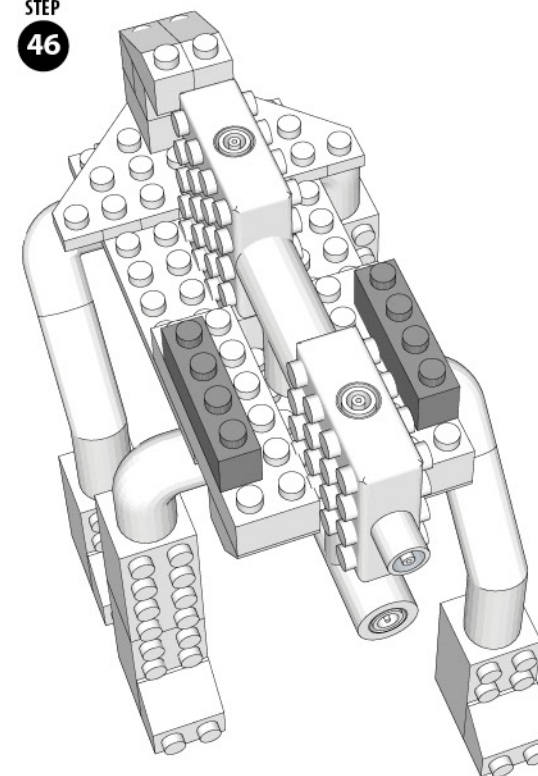

STEP
47

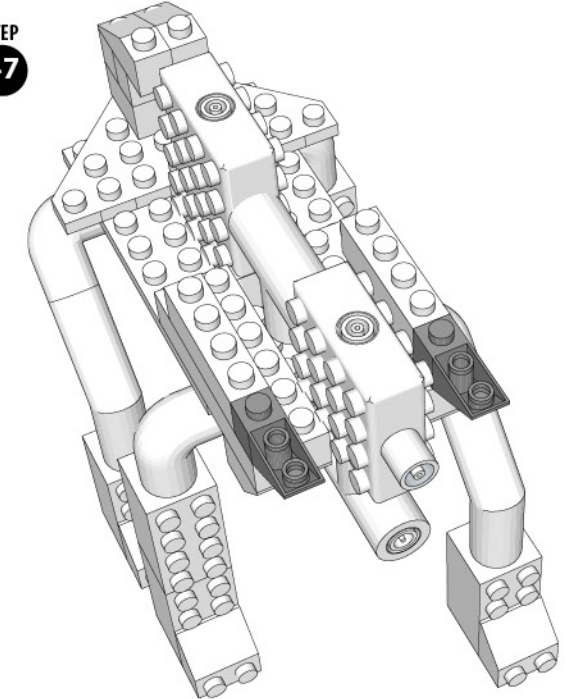

STEP
48

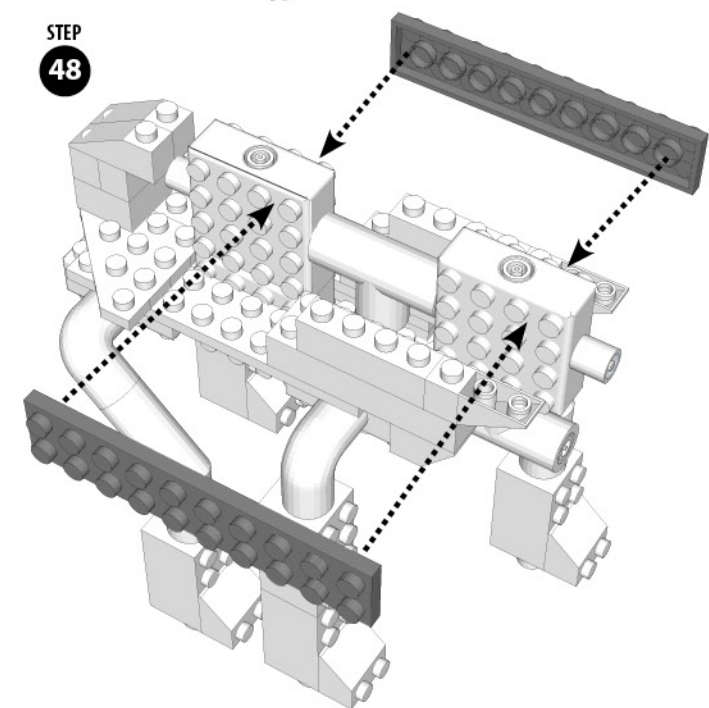

STEP
49

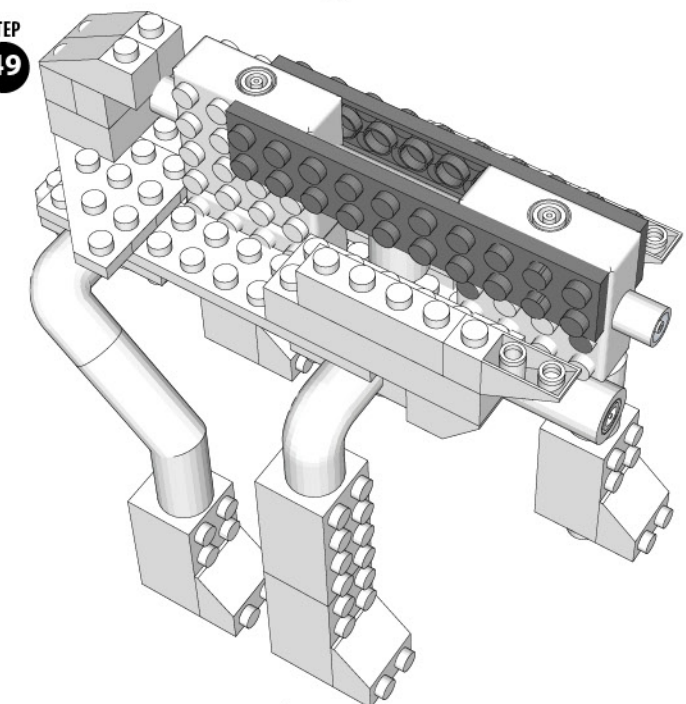

STEP
50

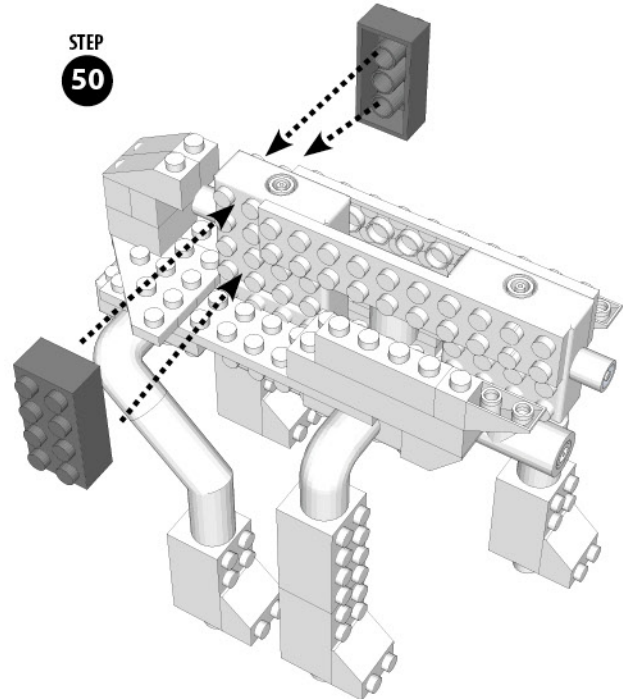

STEP
51

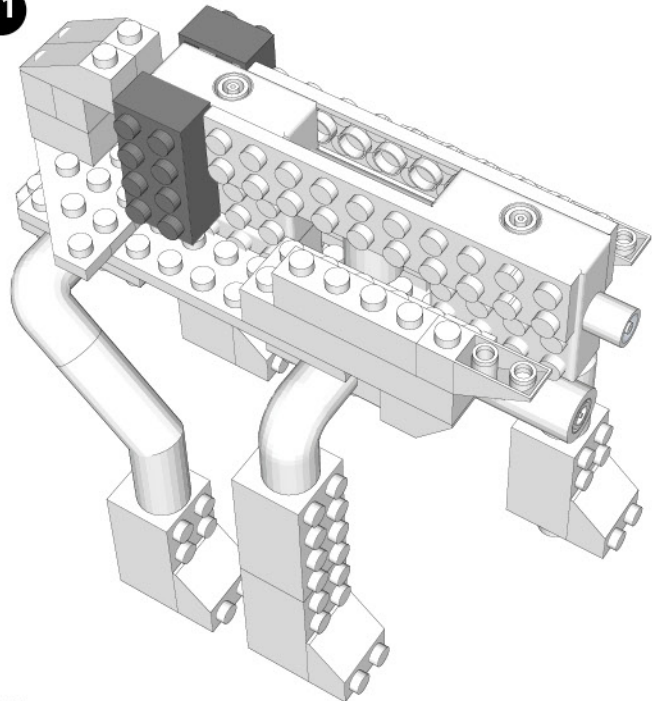

STEP
52

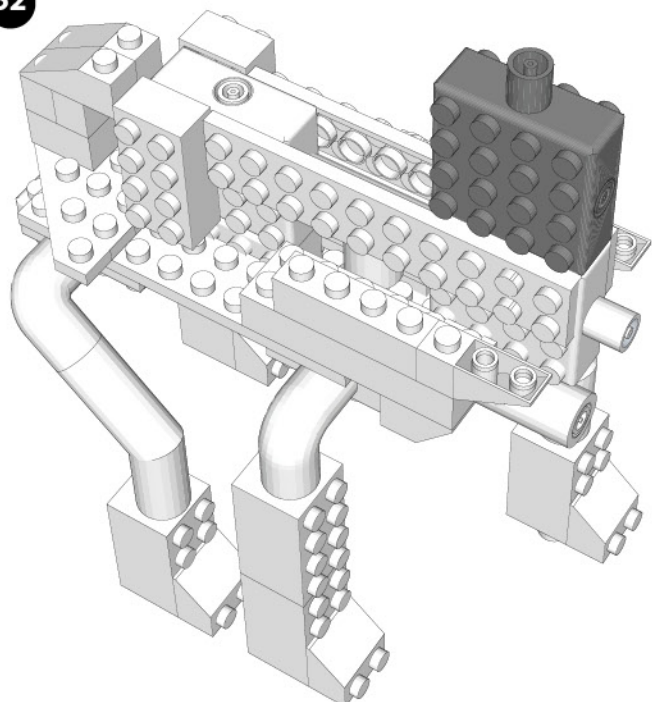

STEP
53

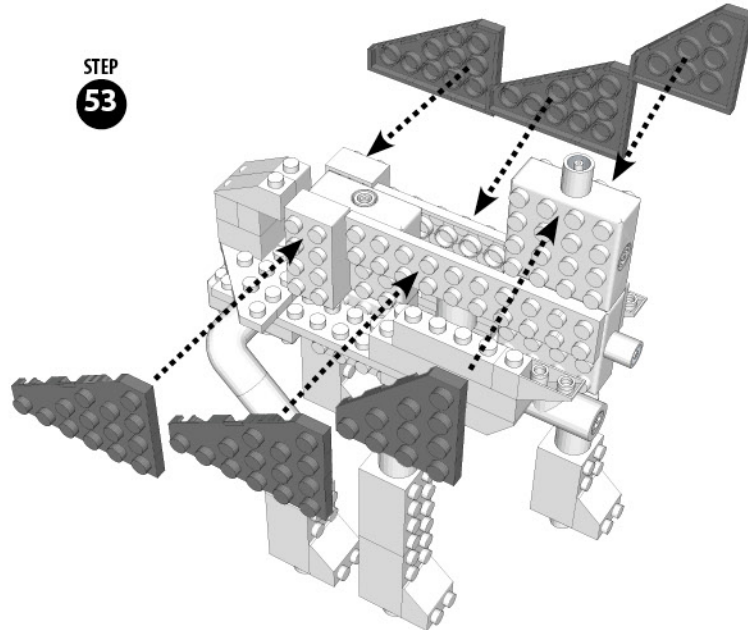

STEP
54

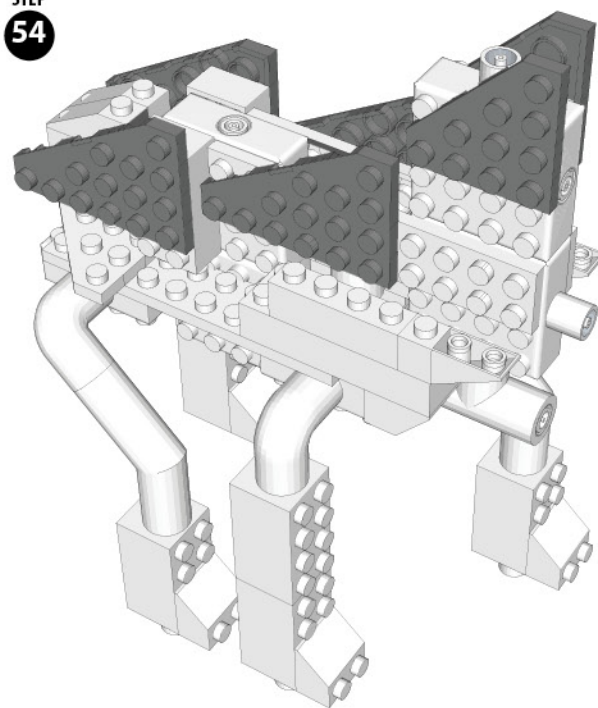

STEP
55

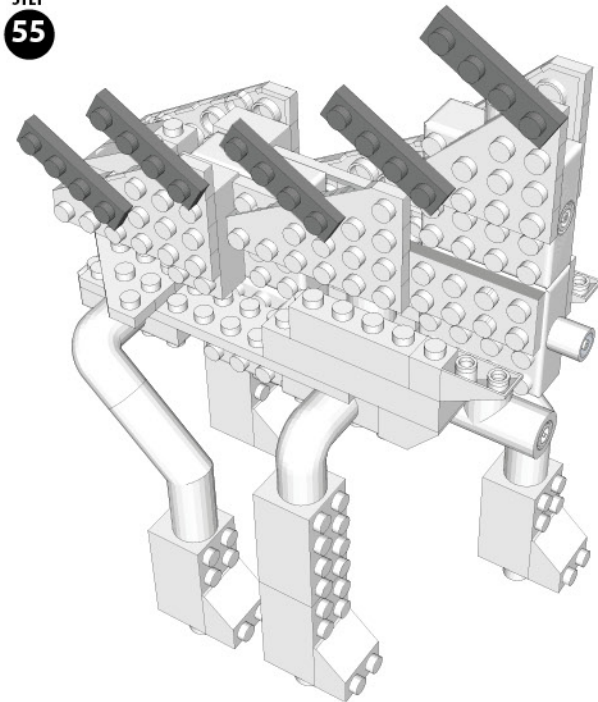

STEP
56

COMBINE
A B

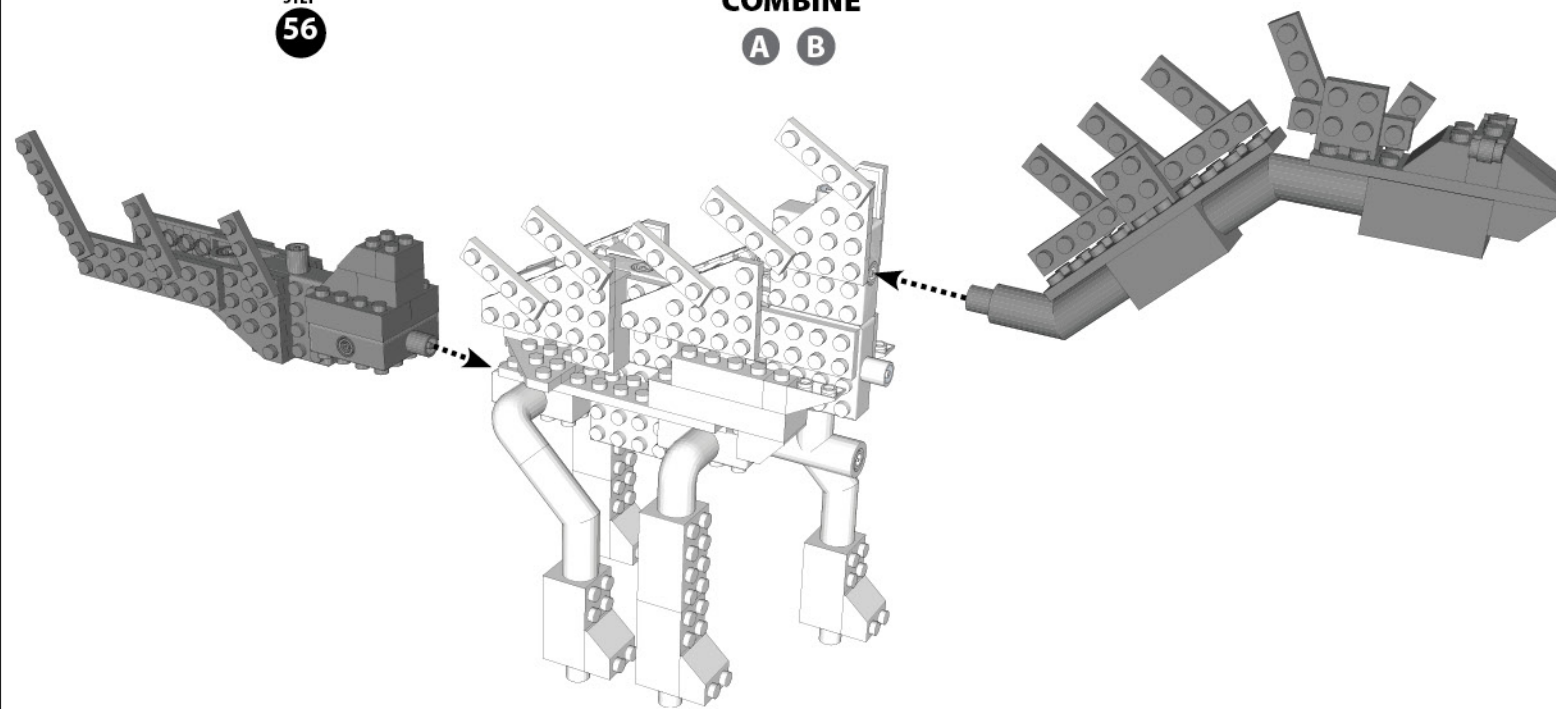

STEP
57

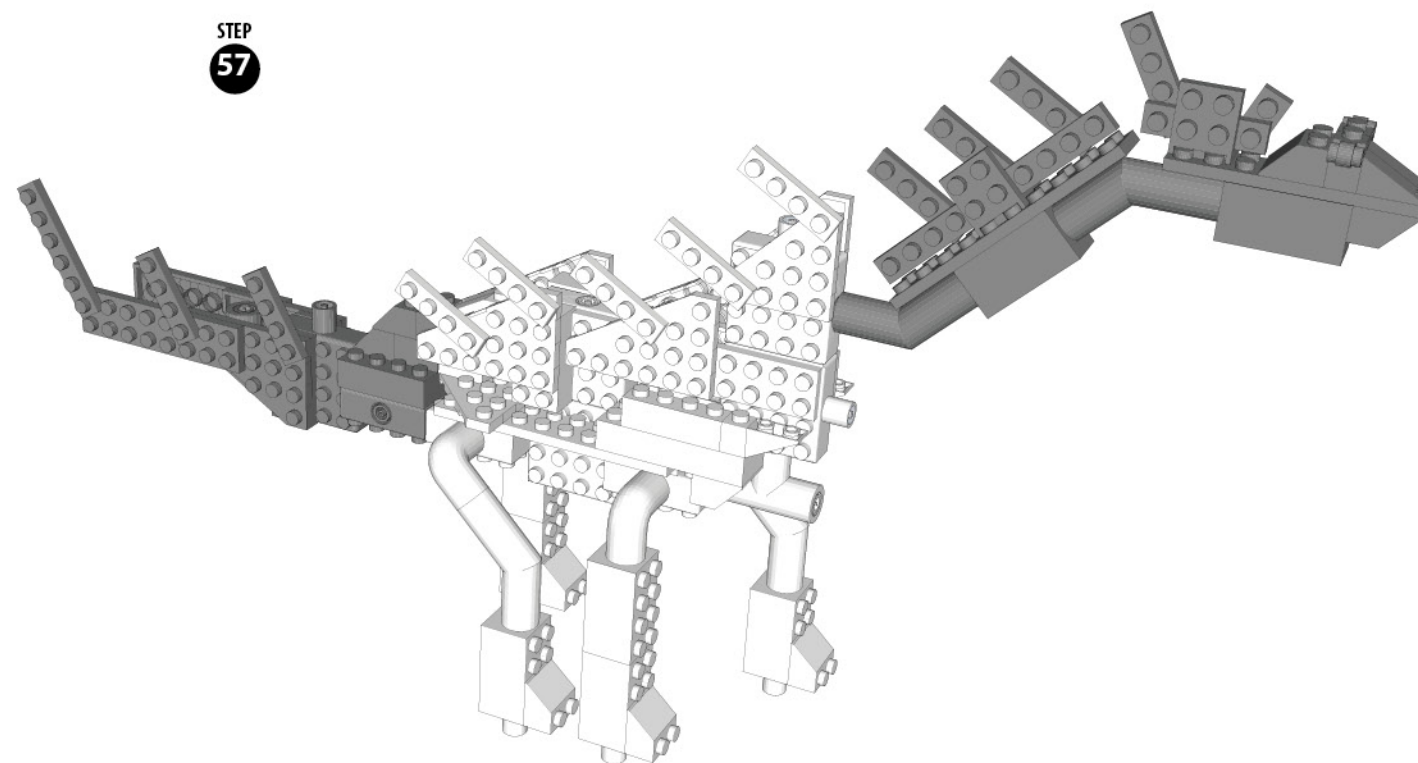

**ATTACH THE MODEL TO THE TRIANGLE
POWER BASE WITH THE PEG CORD**

NATIONAL GEOGRAPHIC KIDS and Yellow Border Design are trademarks of the National Geographic Society, used under license. All rights reserved.



National Geographic's net proceeds support vital exploration, conservation, research, and education programs.

MADE IN CHINA

www.LaserPegs.com

Copyright 2014 © All Rights Reserved Global & Multiple Patents Pending.
US Patent #7,731,558