

LASER PEGS®

The Ultimate Construction Toy For Kids®

PBI420B

POWER BLOCK
Construction
Series

Ages 5+

8 Models+
Any creation you can build

LIGHTED
MOBILE POWER BLOCK™ SET
INCLUDES:

- 100 Tinted Bricks
- 4 Tire Pegs
- 2 Square M-M Pegs
- 1 Mobile Power Block™

Requires 3 AAA Batteries

Batteries NOT
Included



EN71, RoHS COMPLIANT



This product complies to
all safety requirements
of ASTM F 963

DO NOT SUBMERGE IN WATER

WARNING:
CHOKING HAZARD-Small parts.
Not for children under 3 yrs.
Do not submerge in water.

MODEL INSTRUCTIONS

All additional model instructions can
be downloaded at www.LaserPegs.com

Laser Pegs® Parts List

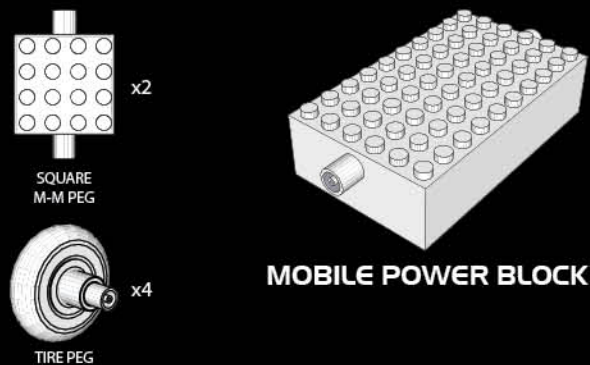

MOBILE POWER BLOCK™



Each Laser Peg® is color coded on the circuit board inside
each shape.



EXCAVATOR: With the advent of hydraulic-powered attachments such as a breaker, a grapple or an auger, the excavator is frequently used in many applications other than excavation.

EXCAVATOR

Model
Difficulty
Level

4

The TRY-ME mechanism is for display purposes ONLY and should be discarded as per state and local regulations. It is NOT intended to be used for the building of this model.

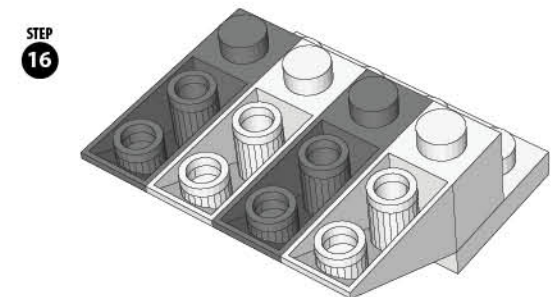
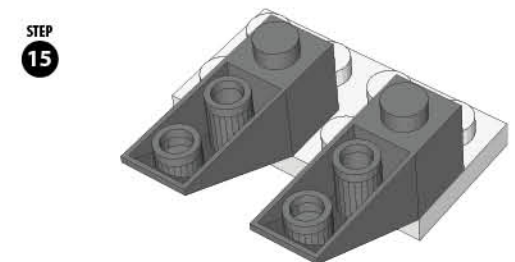
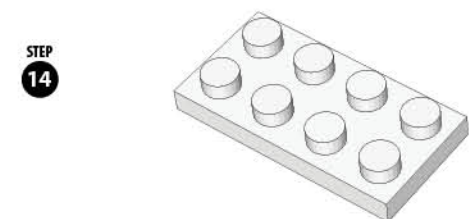
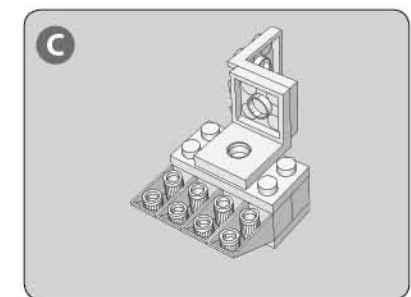
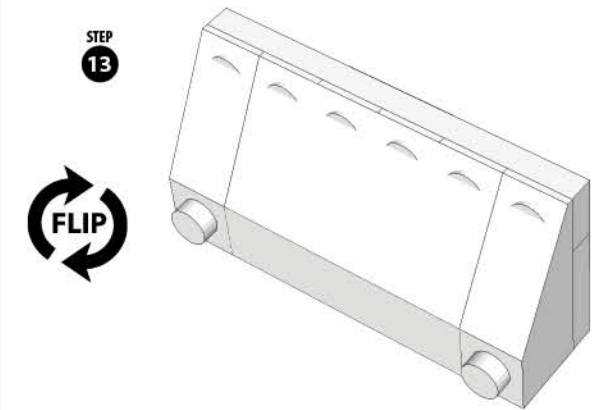
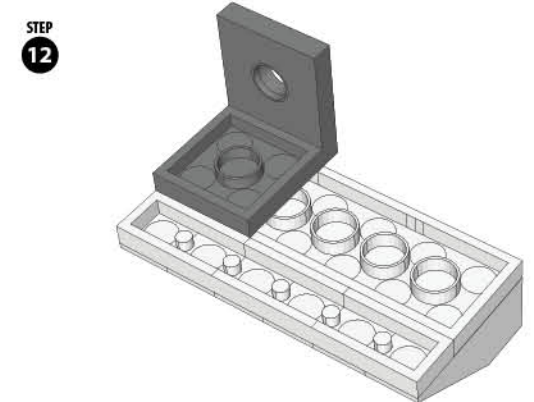
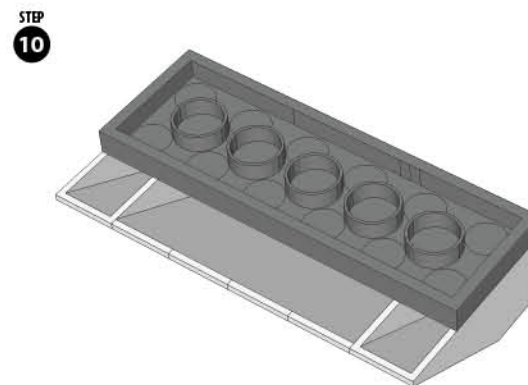
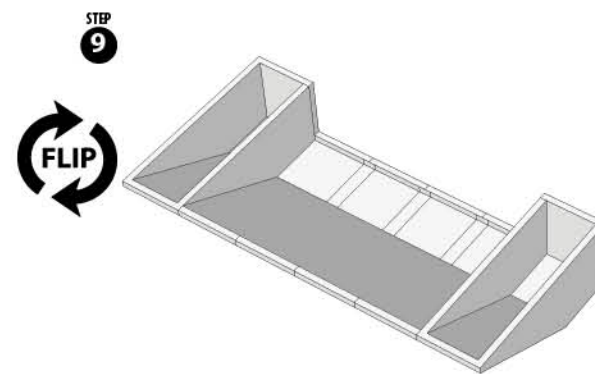
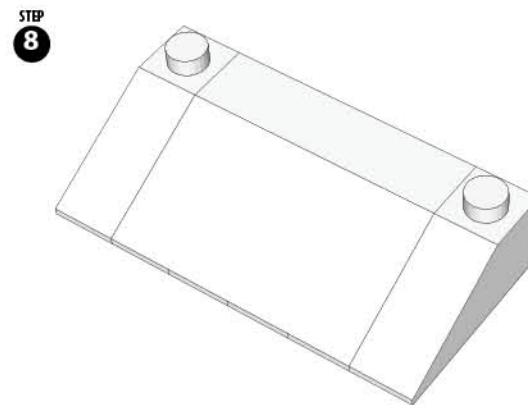
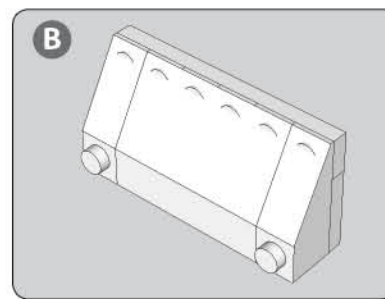
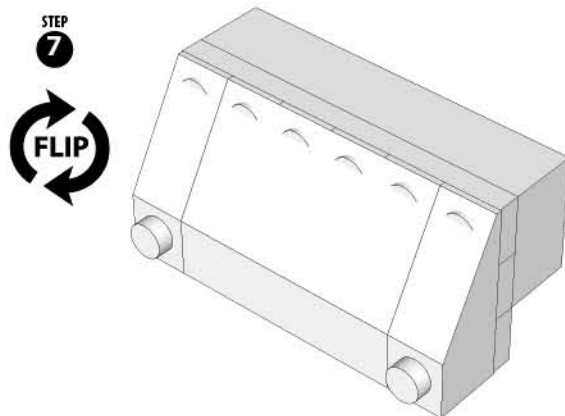
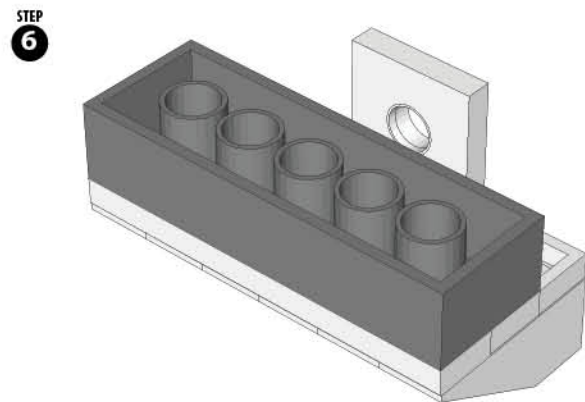
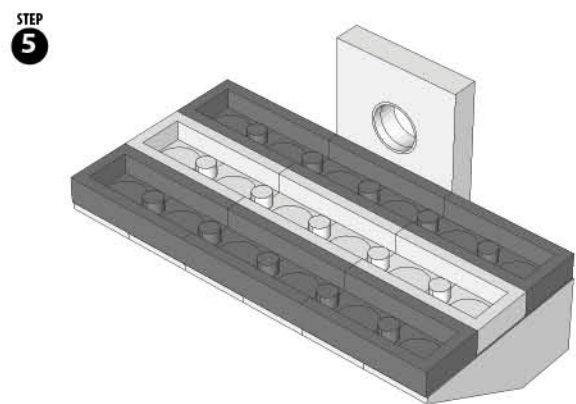
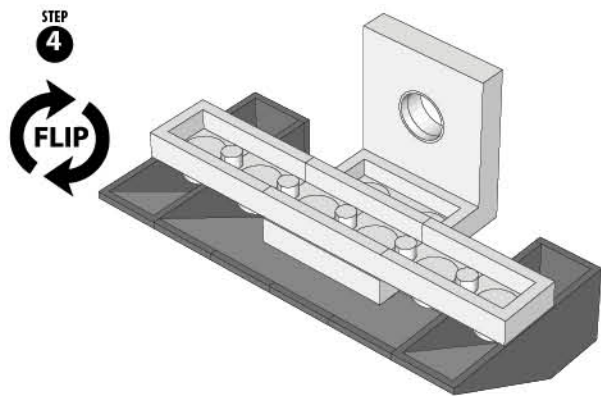
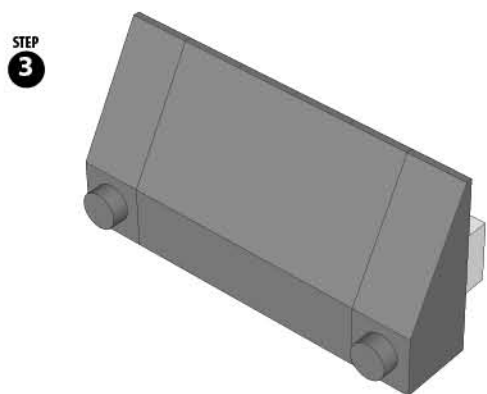
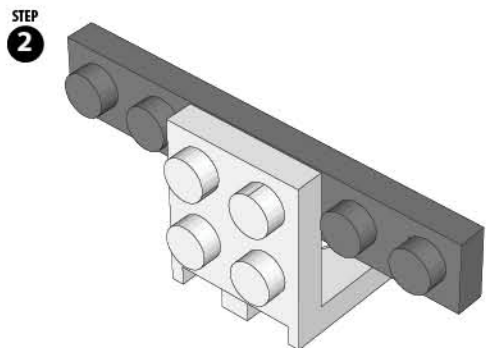
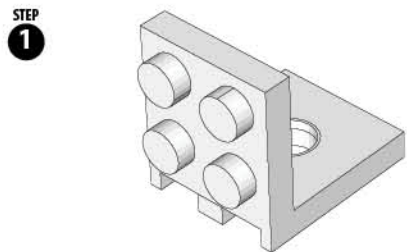
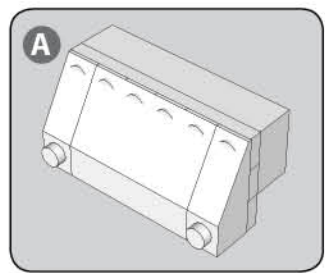

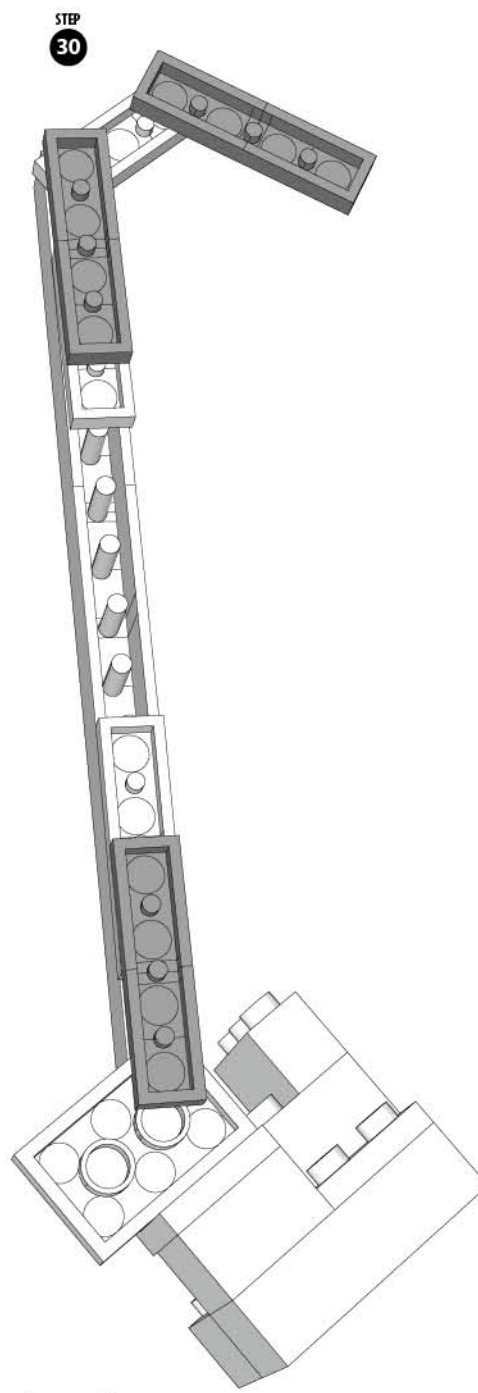
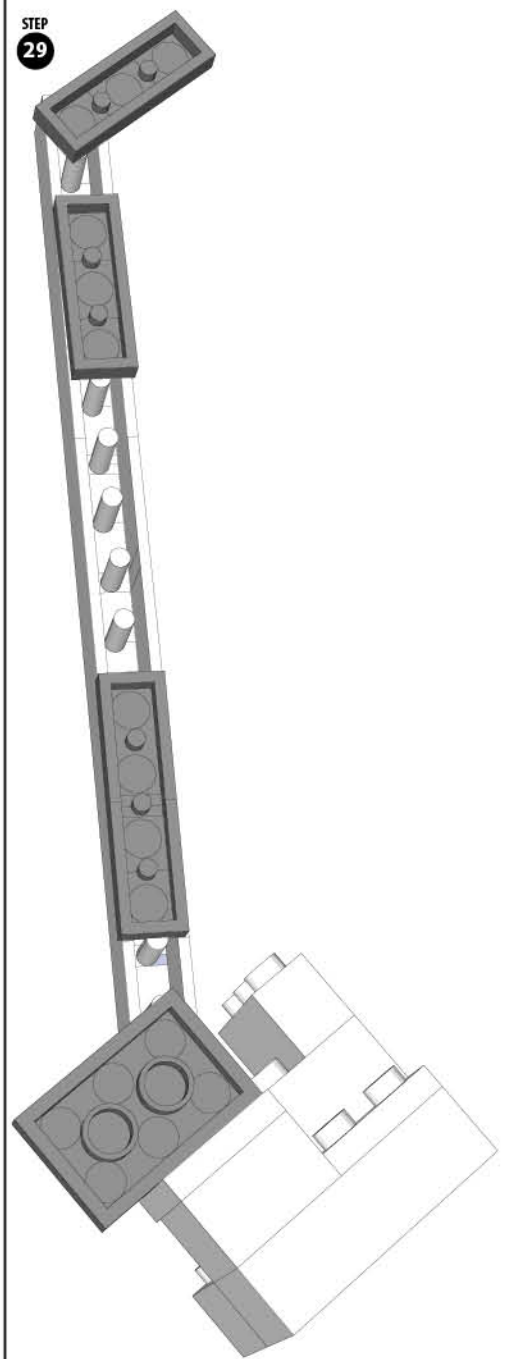
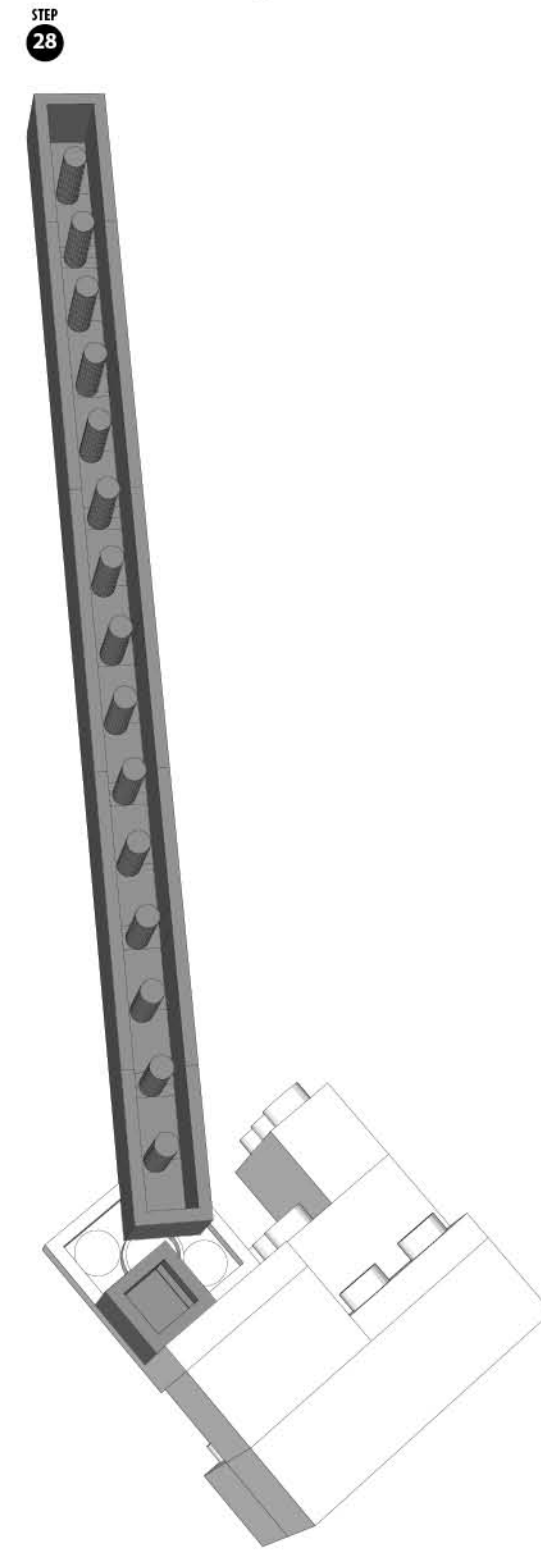
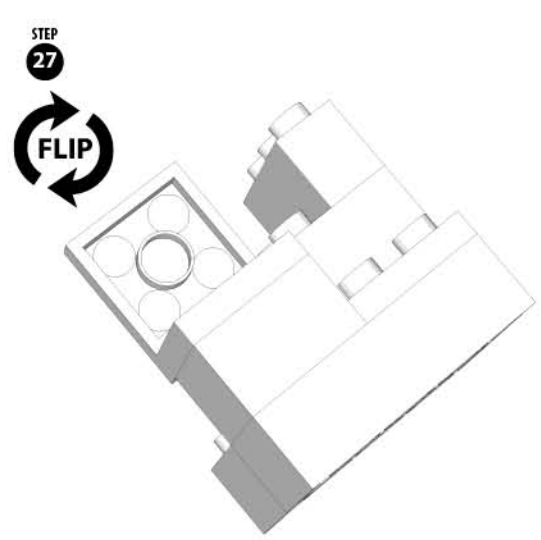
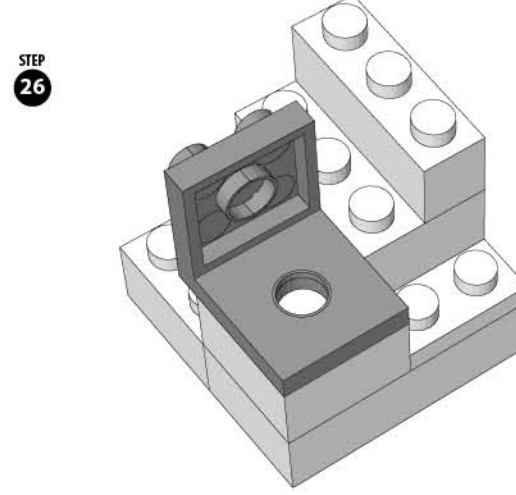
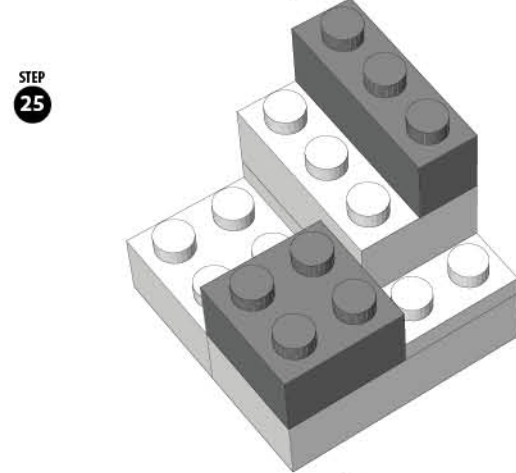
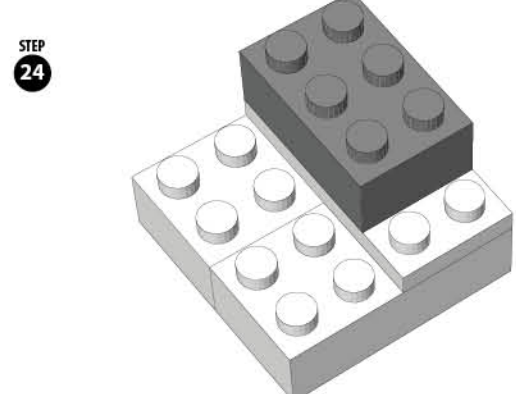
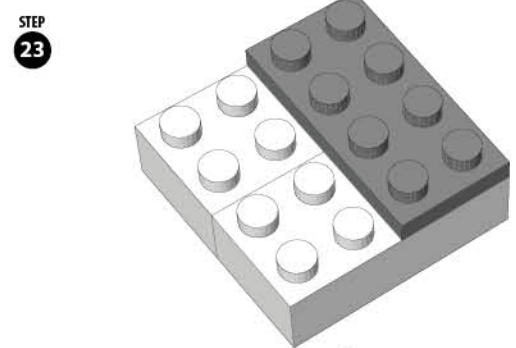
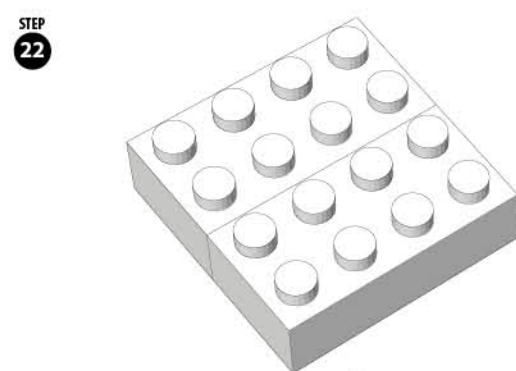
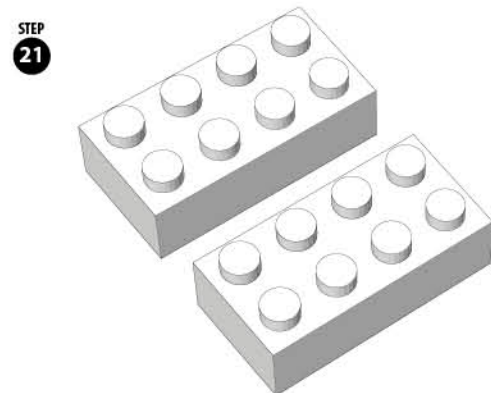
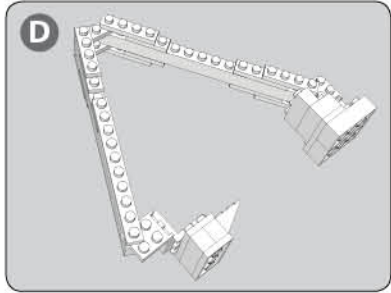
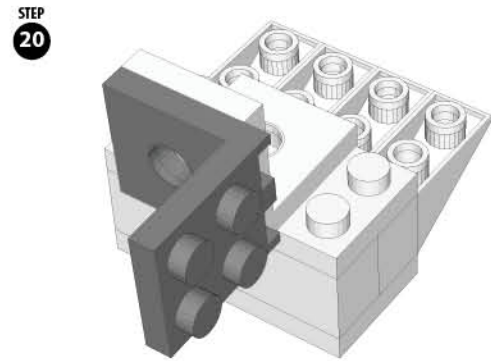
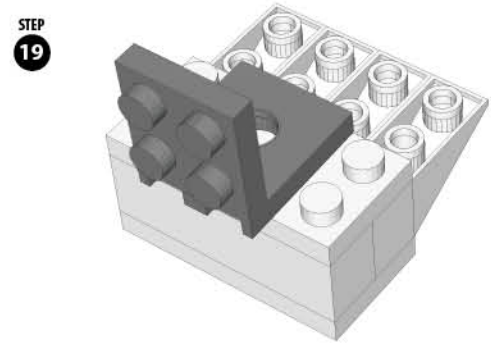
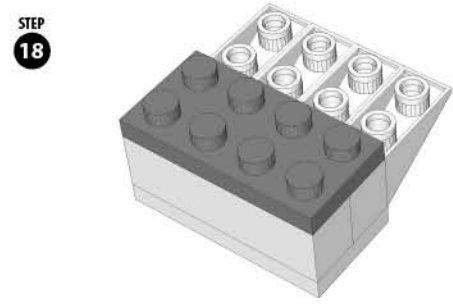
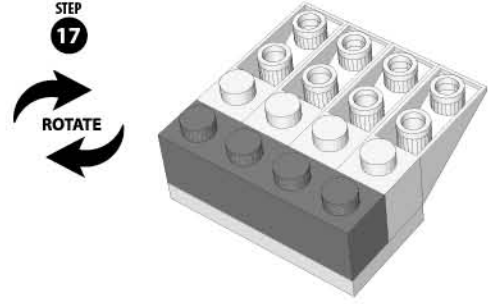

STEP
31

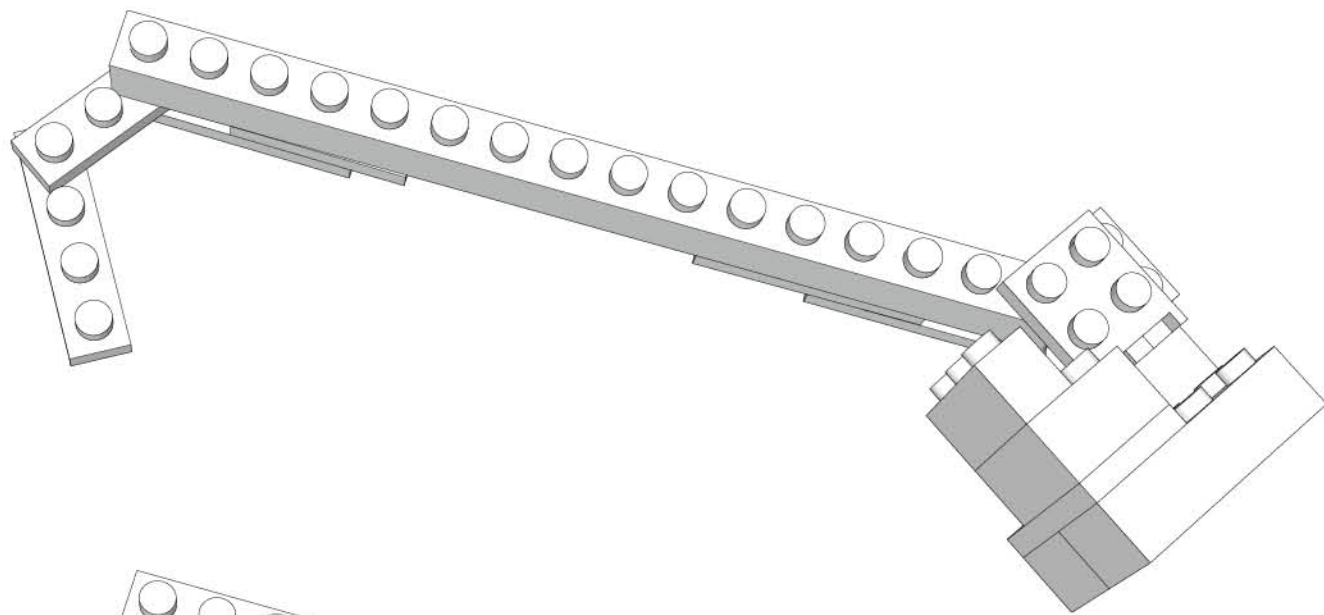

STEP
32

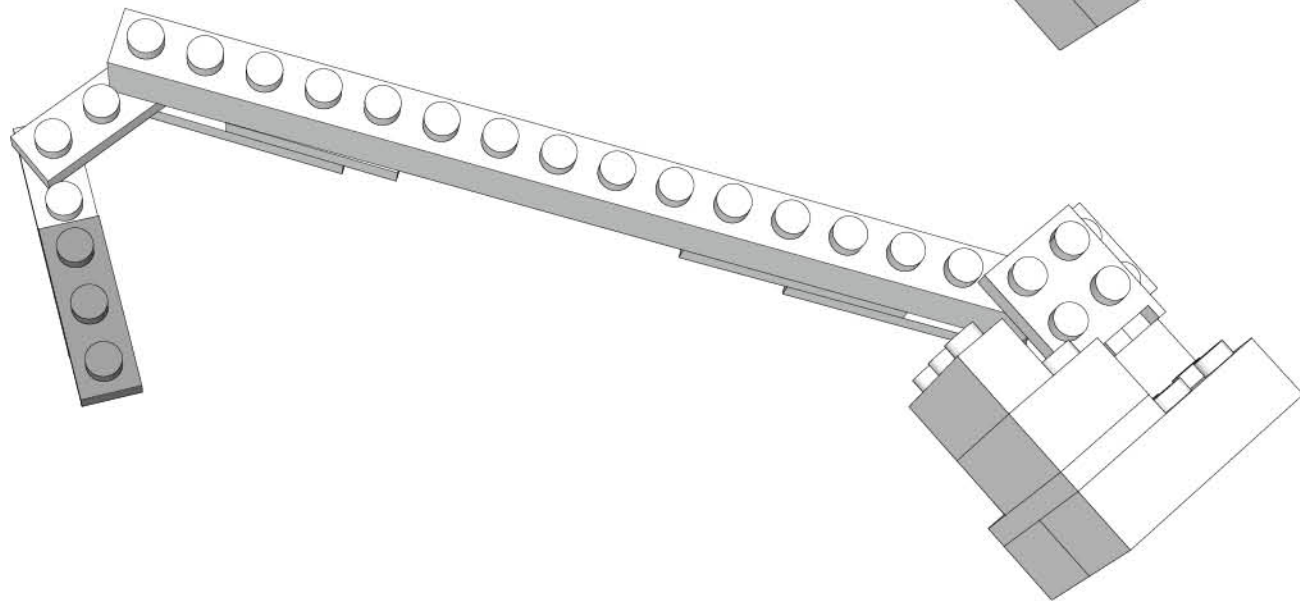

STEP
33

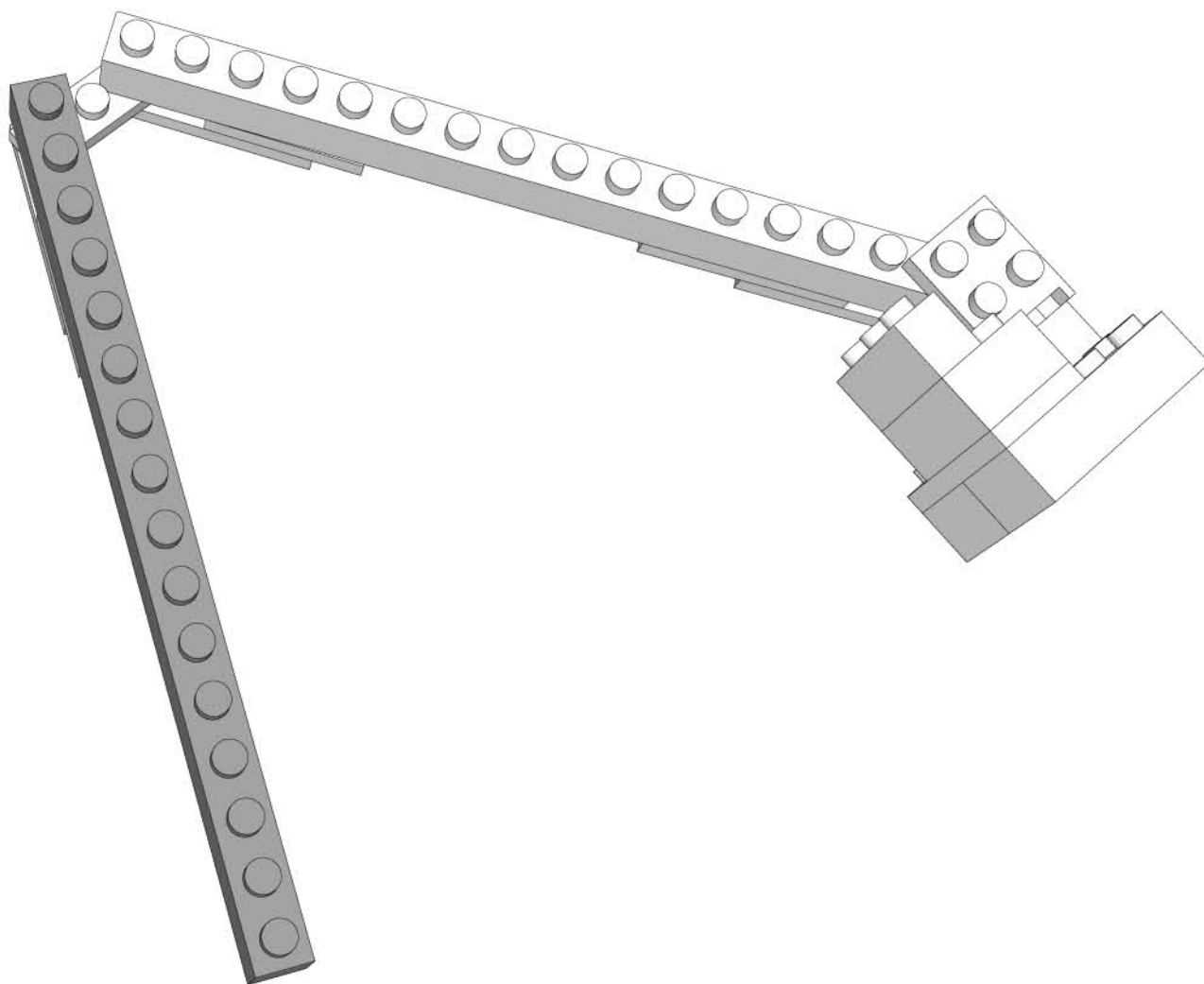

STEP
34

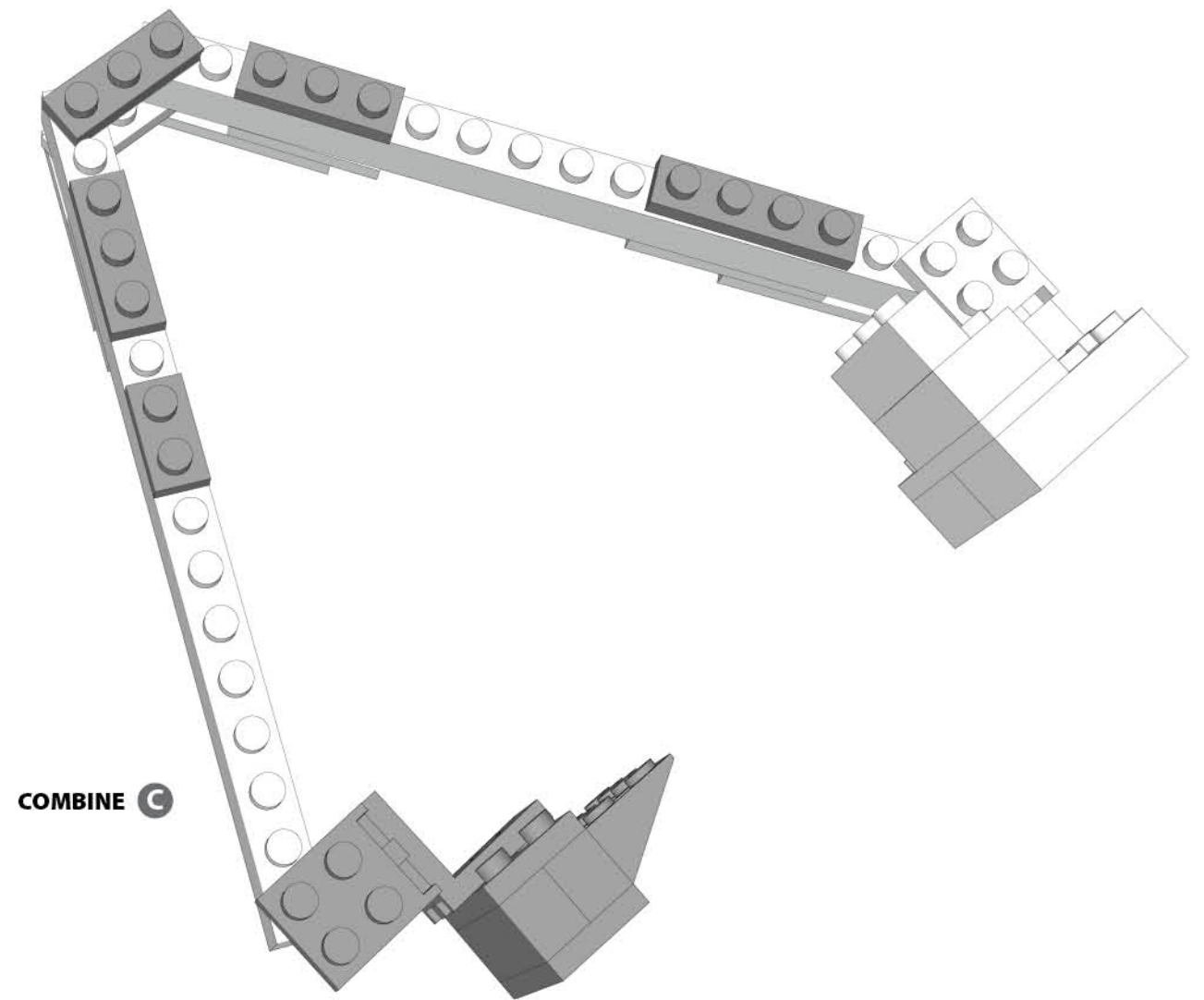

STEP
35

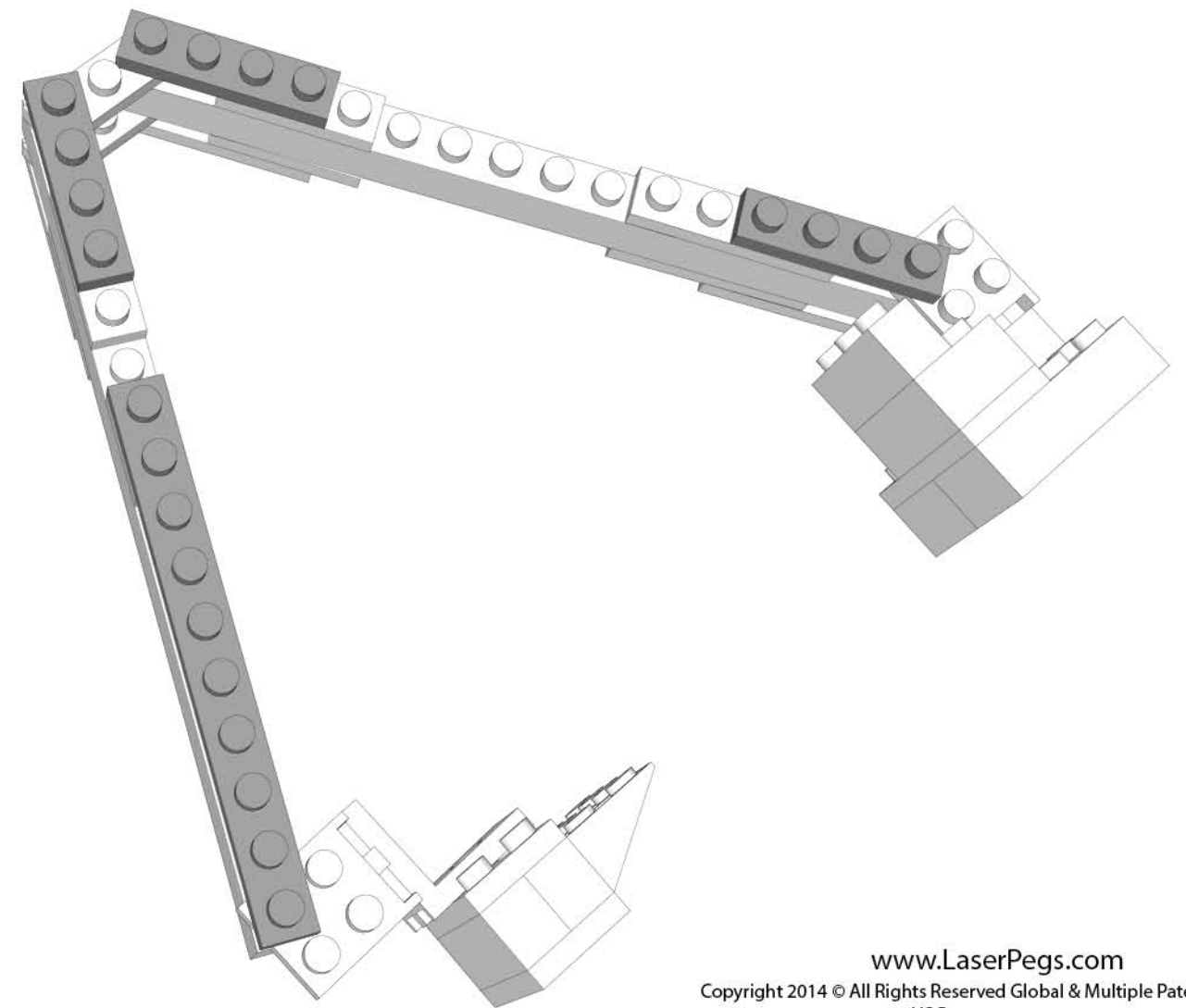

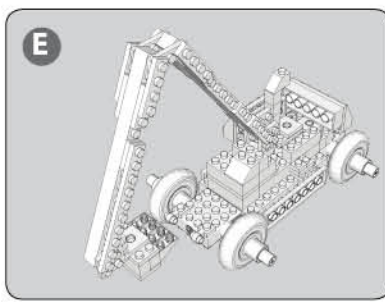

STEP
36

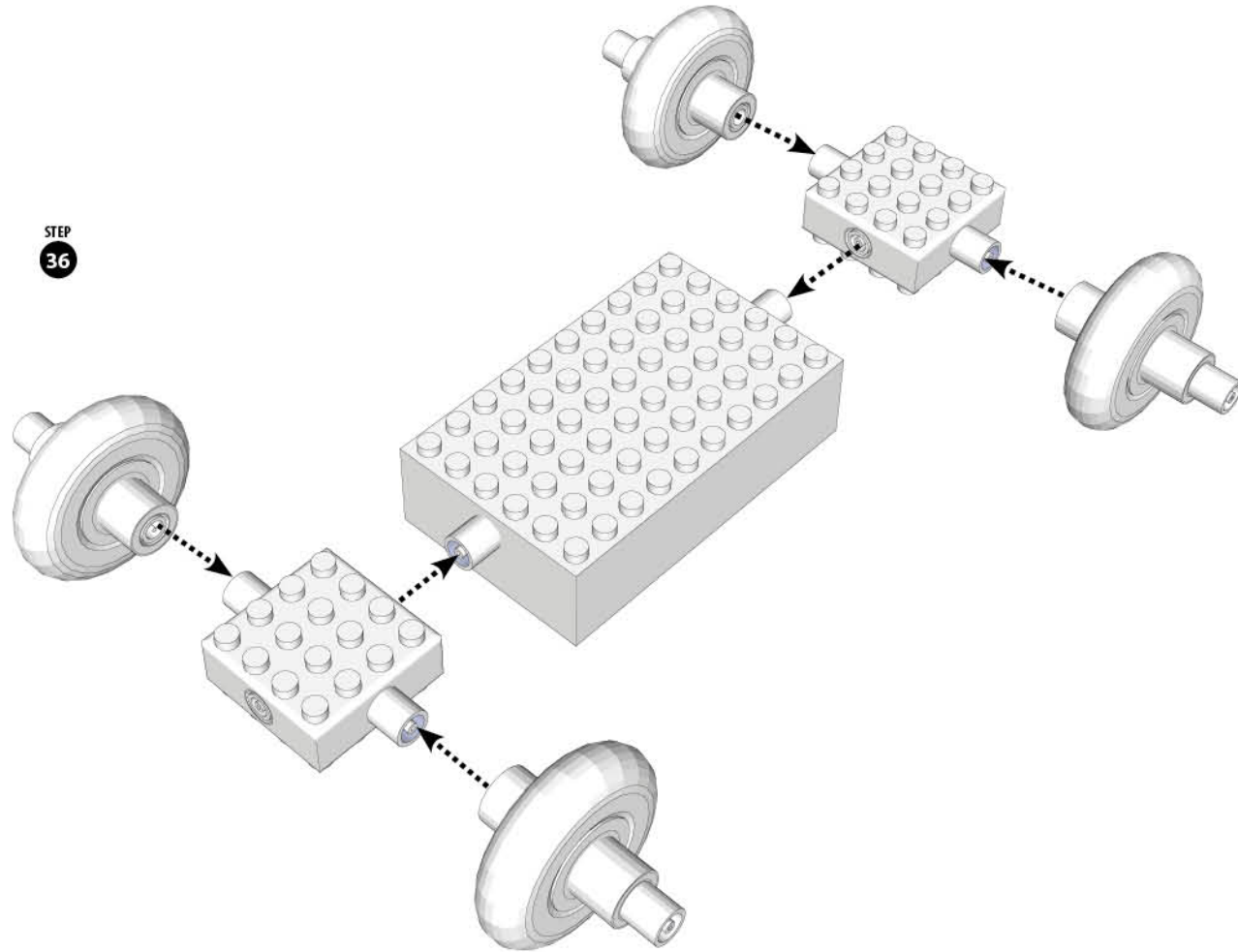

STEP
37

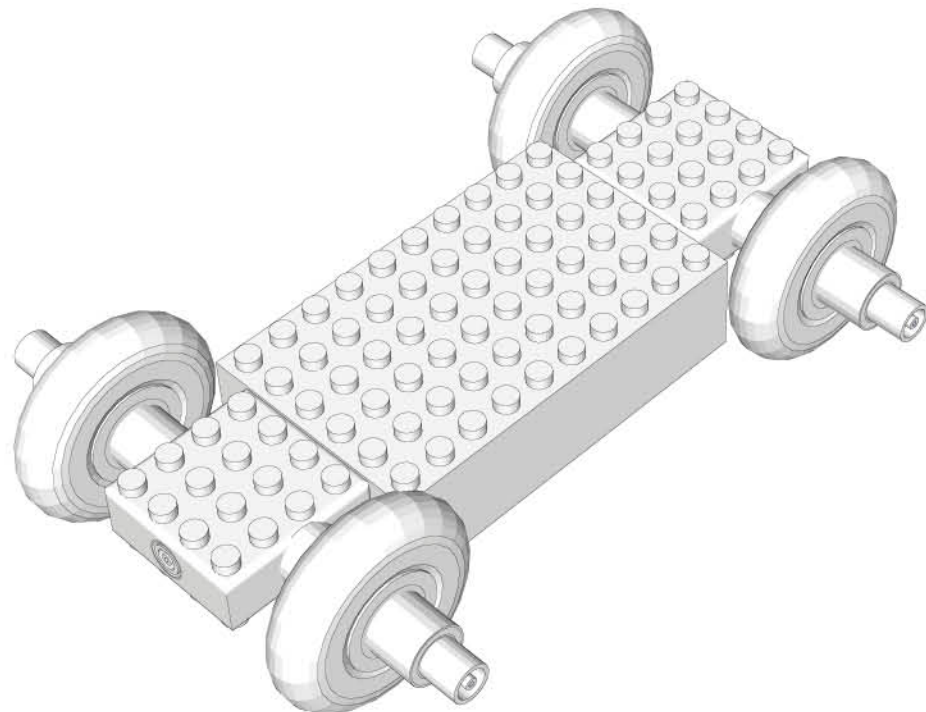

STEP
38

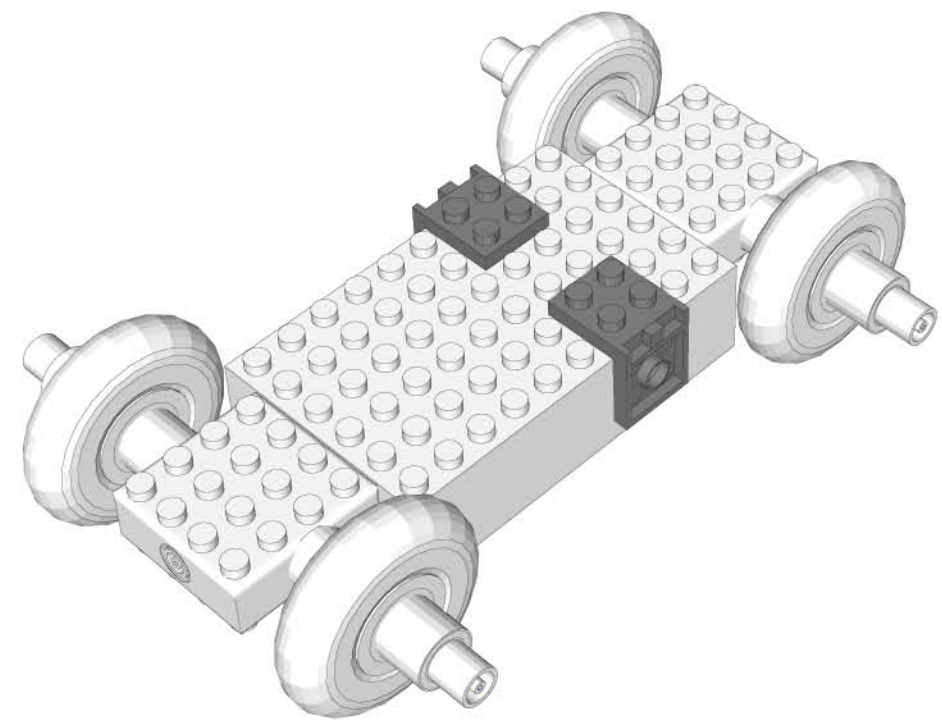

STEP
39

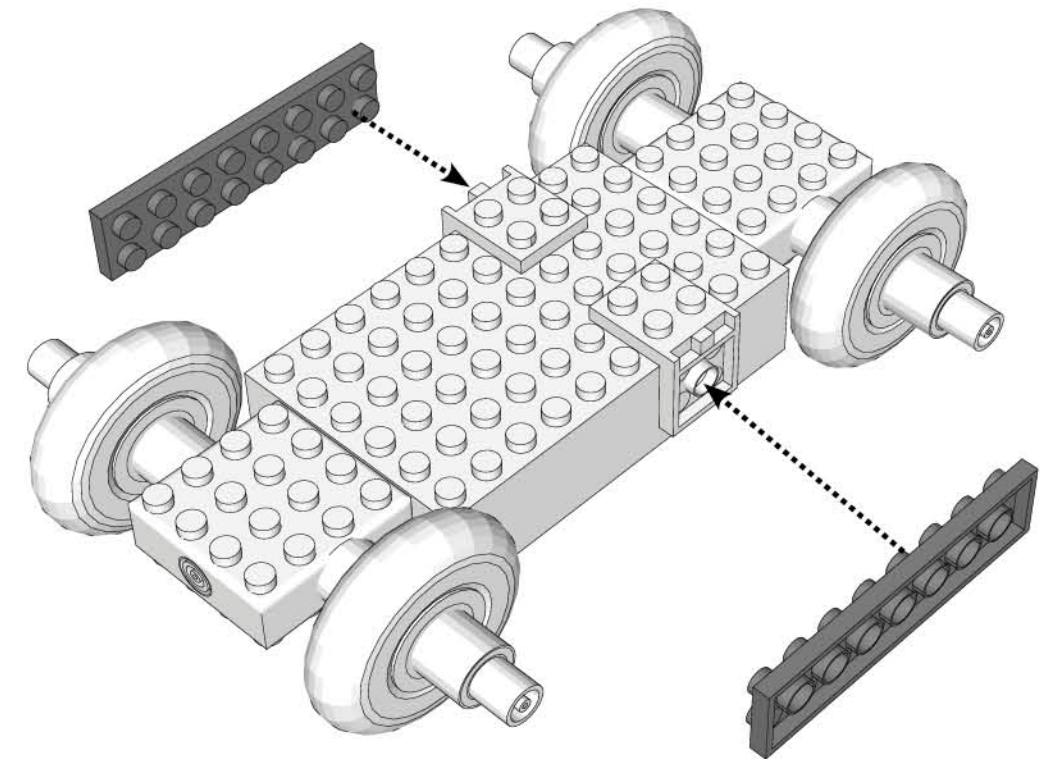

STEP
40

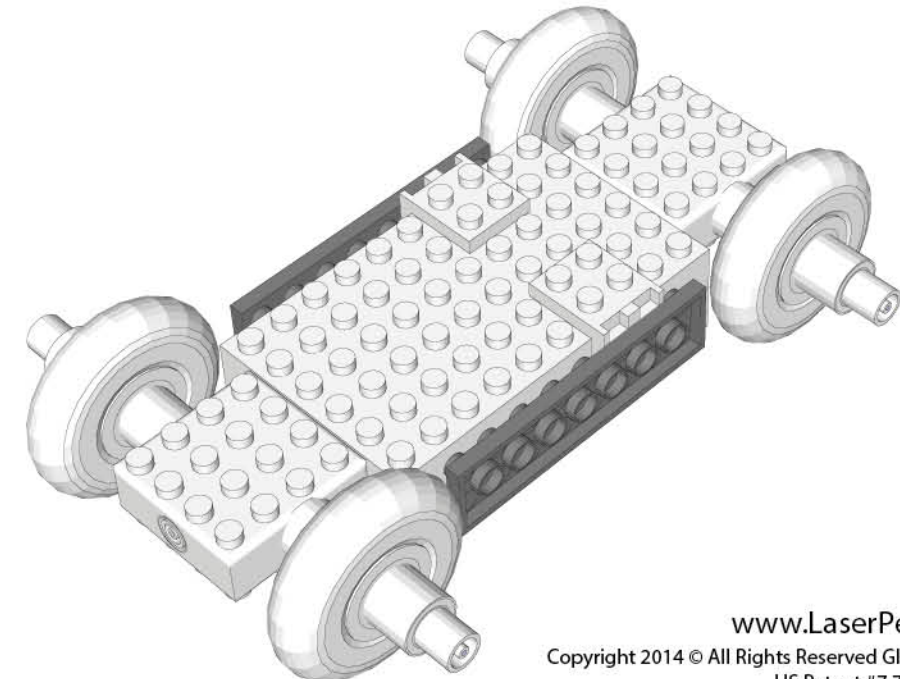

STEP
41

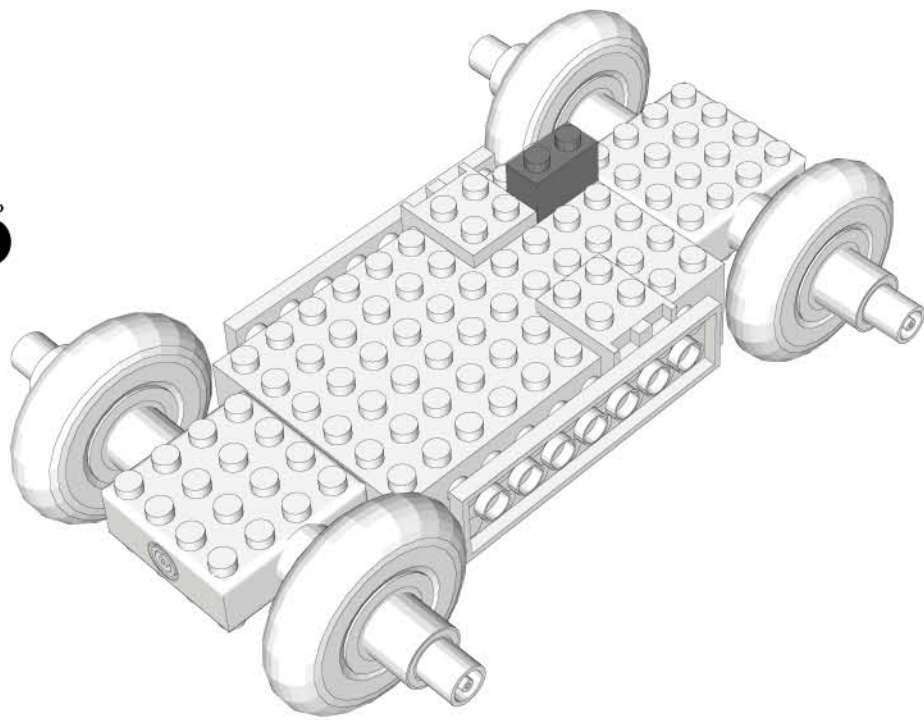

STEP
42

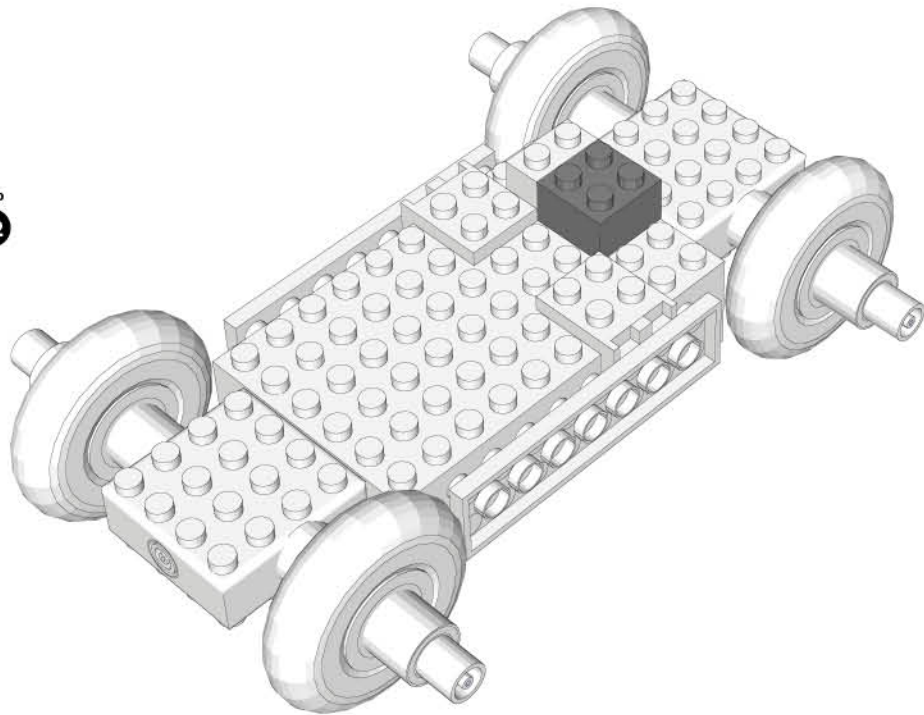

STEP
43

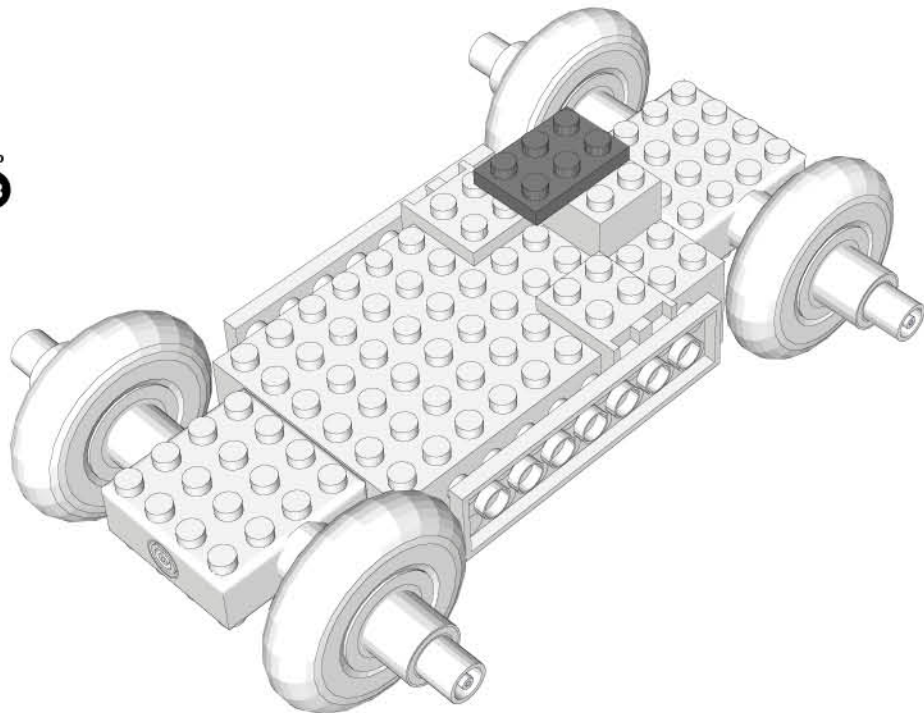

STEP
44

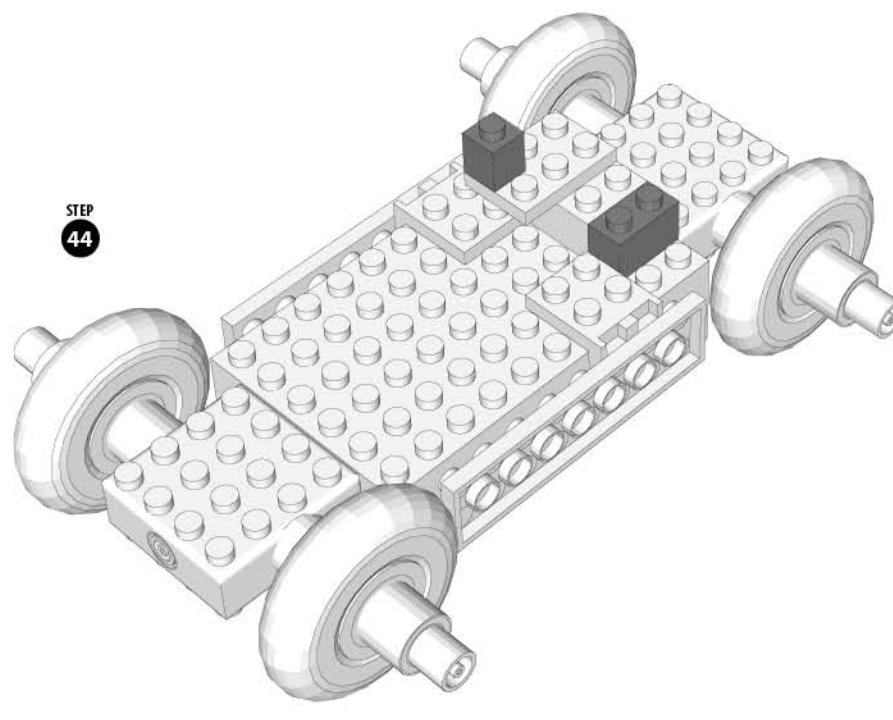

STEP
45

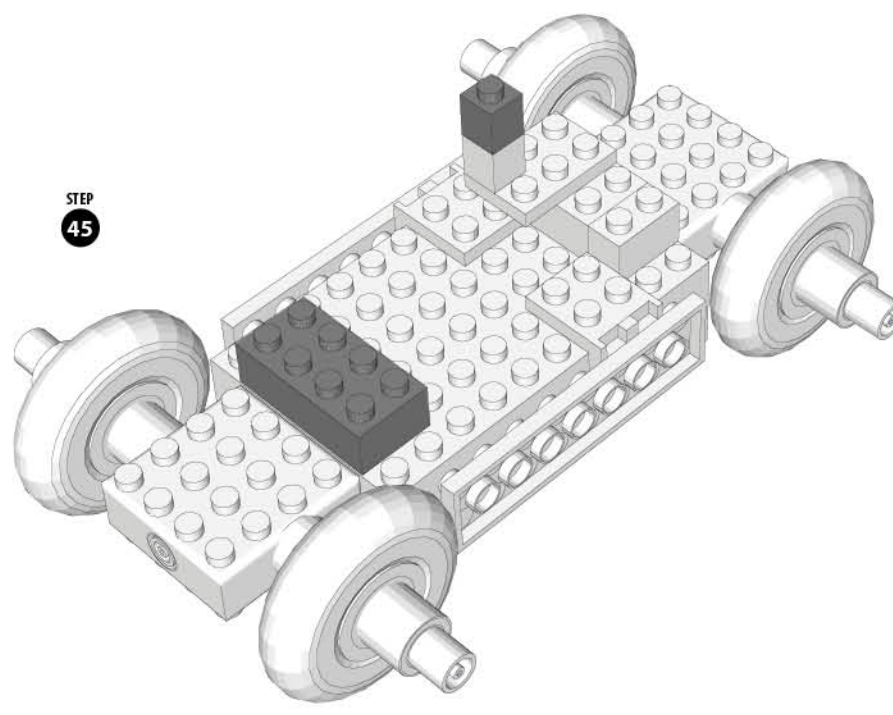

STEP
46

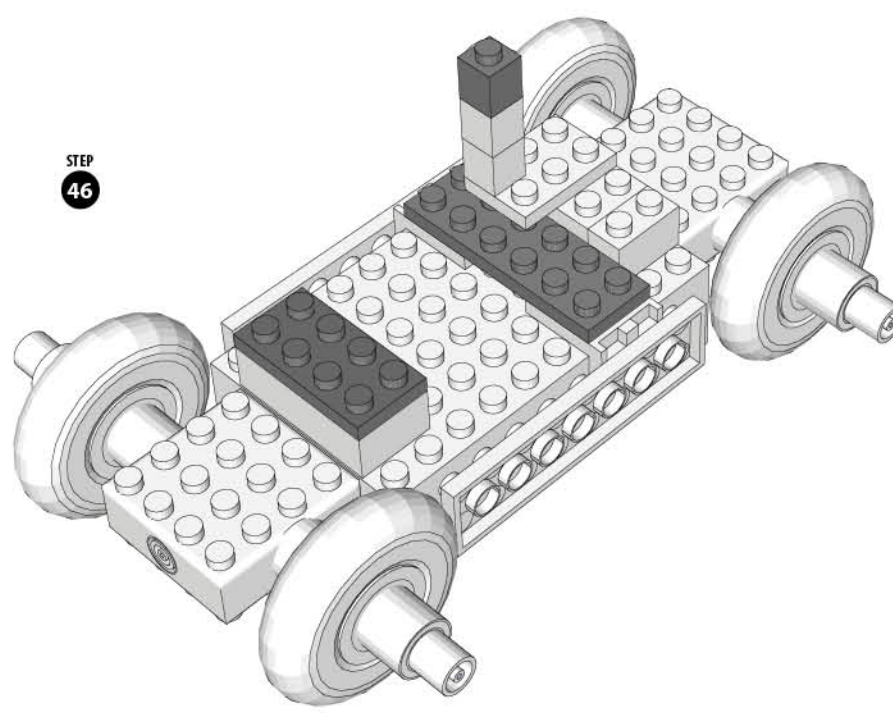

STEP
47

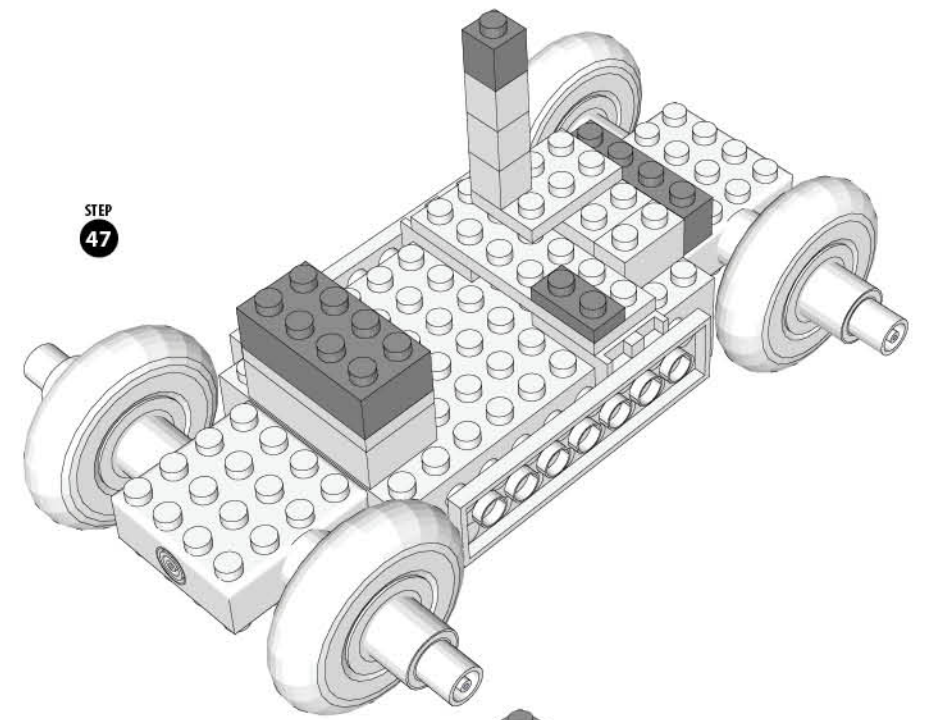

STEP
48

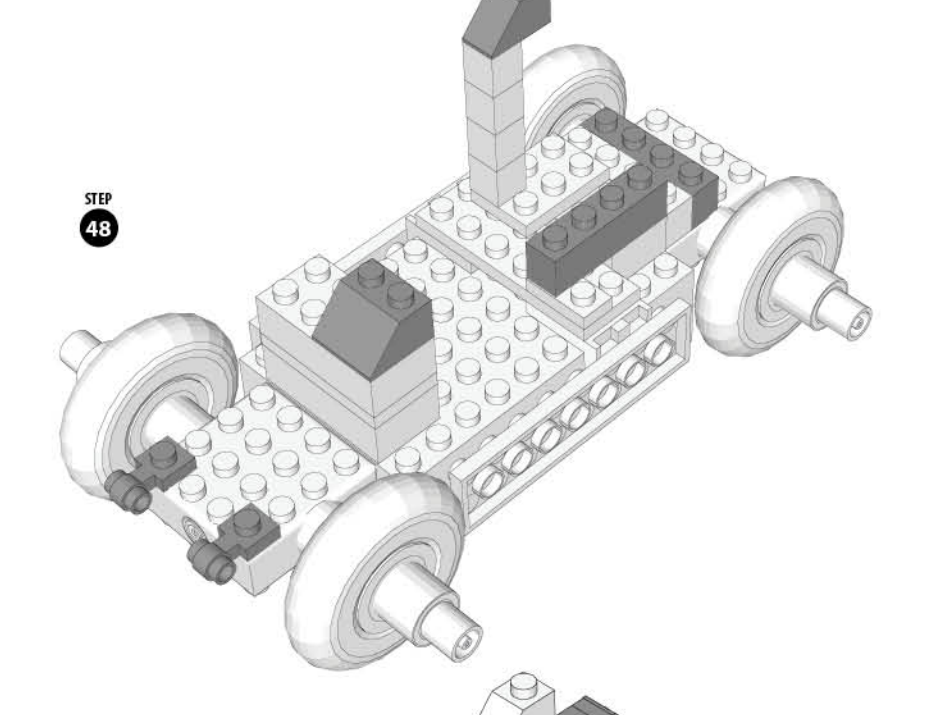

STEP
49

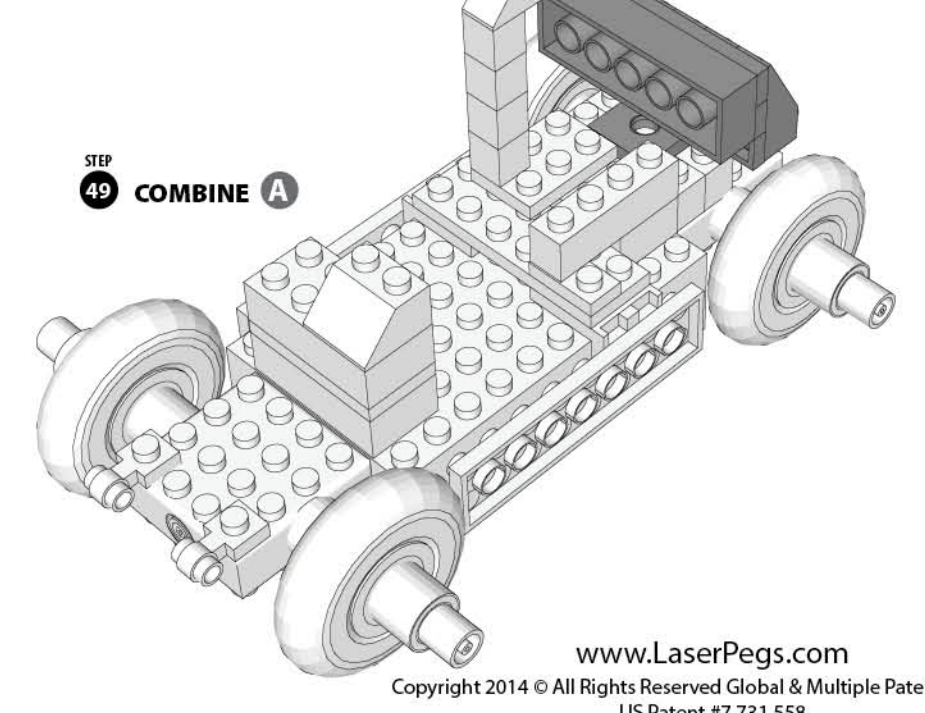

COMBINE A

STEP
50
COMBINE B

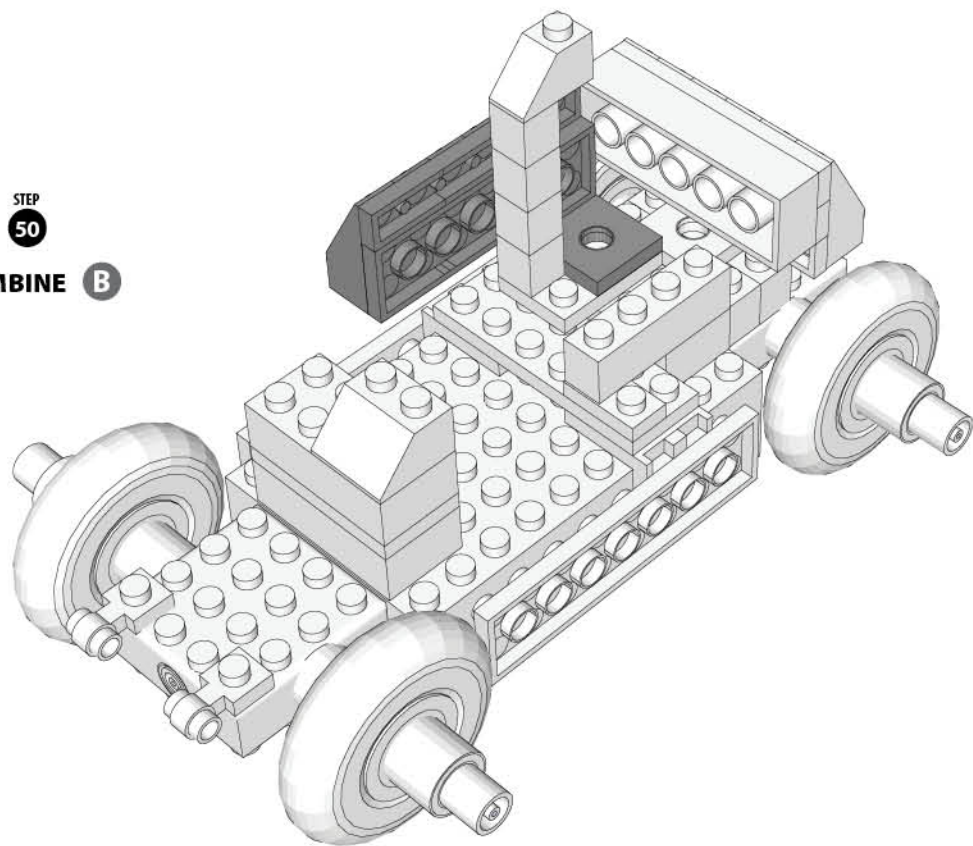

STEP
51
COMBINE D

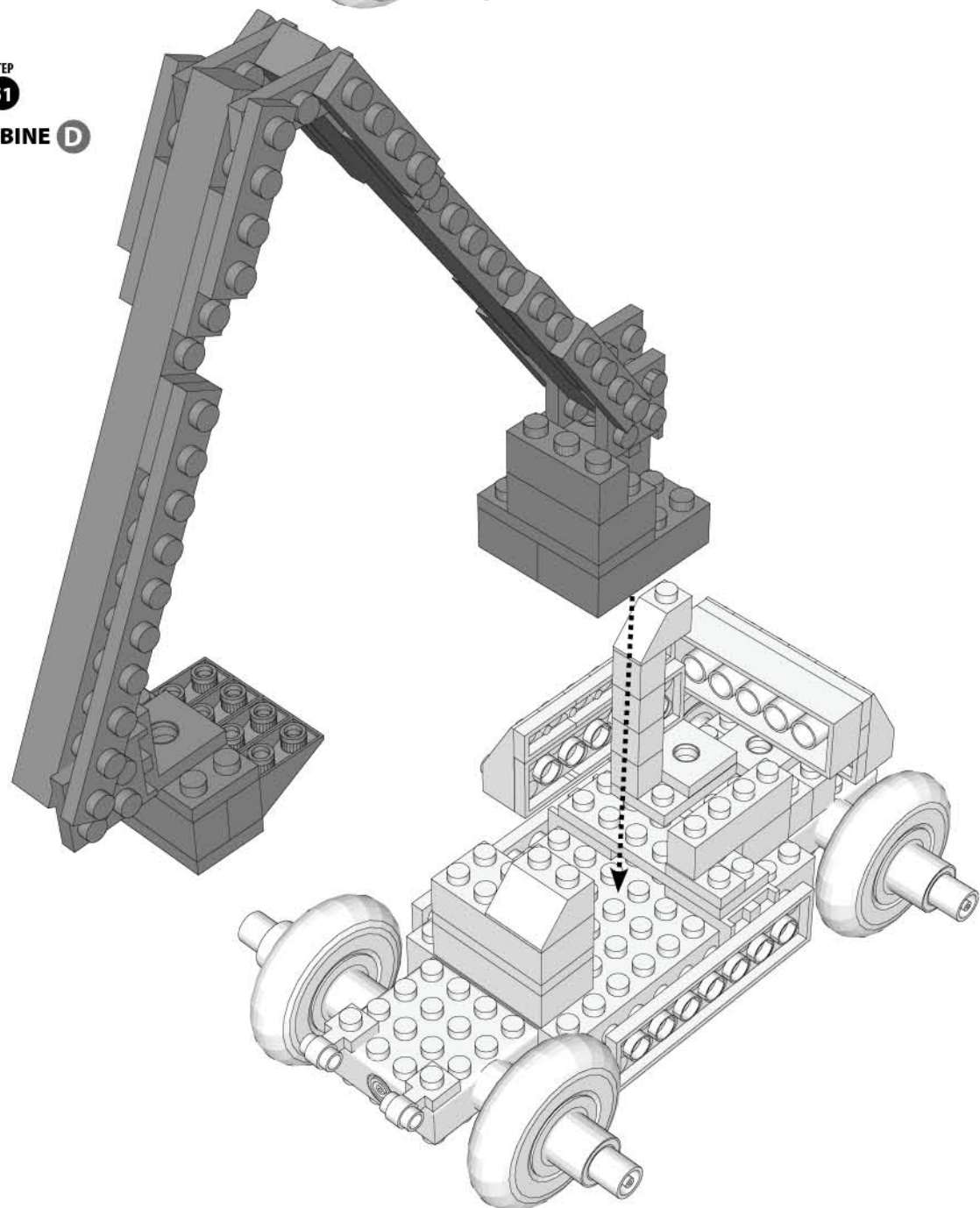

STEP
52

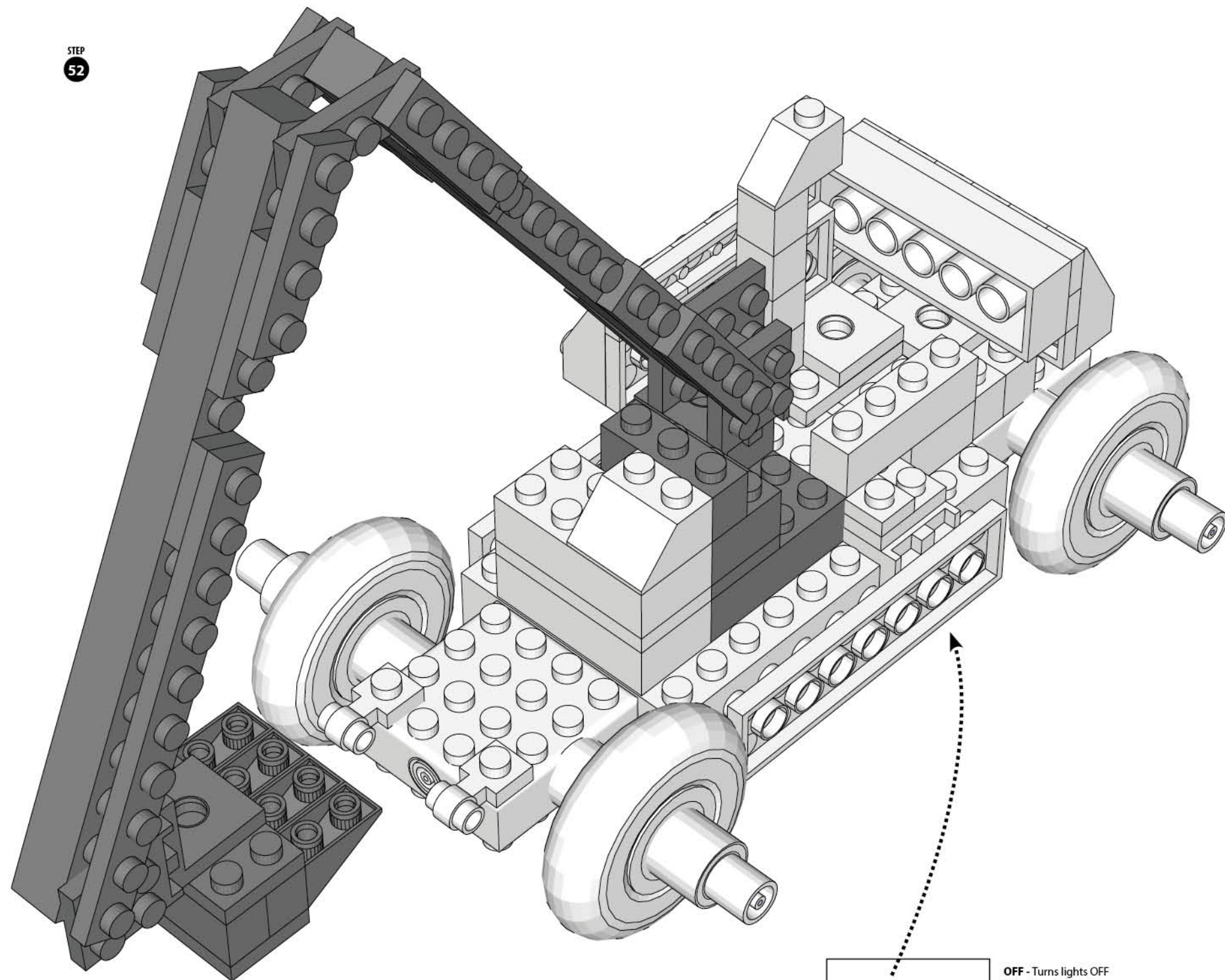

Slide the switch to Light It Up!

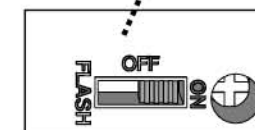

OFF - Turns lights OFF
ON - Turns lights ON
FLASH - Makes lights FLASH

Environmental Phenomena

* The unit may malfunction if subjected to radio-frequency interference. It SHOULD revert to normal operation when the interference stops. If not, it may become necessary to turn the power off and back on, or remove and reinstall the batteries. * In the unlikely event of an electrostatic discharge, the unit may malfunction and lose memory, requiring the user to reset the device by removing and reinstalling the batteries.

Laser Pegs® CARES
Questions? Comments?
For additional compliance info:
1-866-432-3735
Contact: Support@LaserPegs.com

MADE IN CHINA

www.LaserPegs.com

Copyright 2014 © All Rights Reserved Global & Multiple Patents Pending.
US Patent #7,731,558